

**SURVEY & REMONUMENTATION**

**JAN 14 1998**

**Van Buren County Remonumentation Program**

**SECTION**

**LAND CORNER RECORDATION CERTIFICATE**

**Filing Requirement of Act 74, Mich. P.A. 1970**

**Quarter Corner 25,36**

For corners in **Covert Township**

**FILED**

**DEC 11 4 33 PM '97**

*Mark A. Smith*  
VAN BUREN CO.  
REGISTERED SURVEYOR

**LIBER 5 PAGE 19**

**Register of Deeds Stamp & File Number**

<u>Van Buren</u> (County)	Located In:	Corner Code #
1. Public Land Survey	T <u>2S</u> R <u>17W</u>	<u>L11</u>
	T ___ R ___	___
	T ___ R ___	___
	T ___ R ___	___
2. Property Controlling in Section	S ___ T ___ R ___	___
	S ___ T ___ R ___	___
3. Miscellaneous Property in Sec.	S ___ T ___ R ___	___
	S ___ T ___ R ___	___

4. Lot No. \_\_\_\_\_, Recorded Plat \_\_\_\_\_  
5. Private Claims \_\_\_\_\_

I, Gary C. Bilow, in a field survey on 5/28, 1997 do hereby state that under requirements of P.A. 74, Michigan P.A. of 1970, the corner points mentioned in lines 1 and 2 above were in conformance with regulations and rules therefore as required in the current manual of survey instructions of the United States Department of the Interior, Bureau of Land Management or by a decree of a Court of Law and /or that the corner points mentioned in lines 3, 4 and 5 above were in conformance with the rules of the Michigan Board of Land Surveyors or by a Decree of a Court of Law; established, re-established, monumented, recovered, found as expressed below:

**NOTE: Not more than 2 corners, all in the same town and range, may be recorded on this certificate.**

	A	B	C	D	E	F	G	H	I	J	K	L	M
1													
2	6			5			4			3		2	1
3													
4	7			8			9			10		11	12
5													
6	18			17			16			15		14	13
7													
8	19			20			21			22		23	24
9													
10	30			29			28			27		26	25
11													●
12	31			32			33			34		35	36
13													

**A. Description of original monument and accessories and/or subsequent restoration:**

L11, Post set by US Deputy Surveyor GW Harrison in April, 1830 (half miles measured 40.15 chains) and witnessed a Beech 5, S34°W, 13 links and a Beech 4, N36°E, 4 links. In October, 1903, County Surveyor JS Haines calls for a stone with a jug over it and measured half miles 38.83chains (2628.78 feet) west, 39.843 chains (2629.64 feet) east and 39.89 chains (2632.74 feet) south. In March, 1937, County Surveyor TA Smith found a stone, cut an "x" in top and witnessed section corners 2630.6 west and 2631.1 east and the center quarter 2618.24 north. In April 1975, surveyor AW Howard found a RR spike 6 feet north of the center of pavement and witnessed to an iron pipe south 32.5, S70°W, 87.30, PK nail in north face of 8" pine and S30°W, 77.08, PK nail in west face of pole. Howard found the RR spike 6.63 feet north of a straight line for the mile and measured North 2620.56 to the center quarter and east 2630.70 to the section corner. In November, 1978, County Surveyor DR Gilchrist shows the corner on a survey recorded in Liber 8, page 137 and witnessed an 8" Spruce, South 38.17, an 8" Spruce, N70°W, 63.07 and a 6" Spruce, S45°W, 87.35. Gilchrist measured half miles west 2630.18 and south 2633.08.

**B. Description of corner evidence found and/or method applied in restoring or reestablishing corner:**

L11, Found a RR spike inside a steel ring at surface, 0.8' above a stone with a chiseled "x" on top, crockery and brick around stone. Stone is 6.3 north of center of County Road 376. Accepted stone as the best available evidence of the position of the original corner.

**THIS GOVERNMENT MONUMENT WAS RESTORED WITH THE APPROVAL OF THE VAN BUREN COUNTY REMONUMENTATION PEER GROUP OF SURVEYORS AT A MEETING HELD FEBRUARY 26, 1997, AND IS ACCEPTED AS THE BEST AVAILABLE EVIDENCE OF THE POSITION OF THE ORIGINAL CORNER.**

**C. Description of monument for corner and accessories established to perpetuate locating the position of the corner:**

L11, Removed stone and placed 20" Harrison monument inside a monument box. Witnessed:  
 South, 38.21, nail in 14" Spruce  
 N 70° W, 63.22, nail in 12" Spruce  
 S 45° W, 87.35, nail and DNR tag in 14" Spruce  
 N 20° W, 24.78, nail in twin 8"&10" Spruce  
 North, 33.11, iron with RLS cap #19618

Ratified by Peer Group in accordance with P.A. 345 of 1990  
 Van Buren County Surveyor

Date D.R.A. 12/11/97

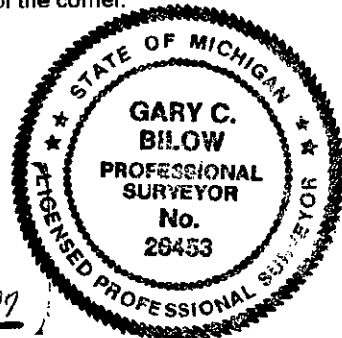

Signed by Gary C. Bilow  
 Surveyor's Michigan License No. 26453

Date November 19, 1997