

JAN 17 1996

DEC 22 9 52 AM '95

COMMISSION

LAND CORNER RECORDATION CERTIFICATE  
Filing Requirement of Act 74, Mich. P.A. 1970

For corners in

Van Buren  
(County)  
Antwerp Twp.

Located In: Corner Code #

S. 1/4 Post, Sec. 32

T 3 S R 13 W D-13

T \_\_\_ R \_\_\_

T \_\_\_ R \_\_\_

T \_\_\_ R \_\_\_

S \_\_\_ T \_\_\_ R \_\_\_

S \_\_\_ T \_\_\_ R \_\_\_

S \_\_\_ T \_\_\_ R \_\_\_

S \_\_\_ T \_\_\_ R \_\_\_

*Mark A. Smith*  
VAN BUREN CO.  
REGISTER OF DEEDS

Register of Deeds Stamp & File Number

- 4. Lot No. \_\_\_\_\_, Recorded Plat \_\_\_\_\_
- 5. Private Claims \_\_\_\_\_

	A	B	C	D	E	F	G	H	I	J	K	L	M
2	6	5	4	3	2	1							
3													
4	7	8	9	10	11	12							
5													
6	18	17	16	15	14	13							
7													
8	19	20	21	22	23	24							
9													
10	30	29	28	27	26	25							
11													
12	31	32	33	34	35	36							
13													

I, James E. Boynton, in a field survey on October 2, 1995, 19 95, do hereby certify that under requirements of P.A. 74, Michigan P.A. of 1970, the corner points mentioned in lines 1 and 2 above were in conformance with regulations and rules therefore as required in the current manual of survey instructions of the United States Department of the Interior, Bureau of Land Management or by a decree of a Court of Law and/or that the corner points mentioned in lines 3, 4 and 5 above were in conformance with the rules of the Michigan Board of Land Surveyors or by a Decree of a Court of Law; established, re-established, monumented, re-monumented, recovered, found as expressed below:

**NOTE: Not more than 4 corners, all in the same town and range, may be recorded on this certificate.**

A. Description of original monument and accessories and/or subsequent restoration:

1827, original corner established by William Brookfield, D.S.  
 1897, stake and stone by Mutchler  
 1930-1945, 1955, 1961 - notes show corner - no descriptions given.  
 1971, L.C.R.C. by D. Middleton shows 1" pipe over 1/2" pipe.  
 1972, 1974, 1975 and 1995, notes show corner - no description given

B. Description of corner evidence found and/or method applied in restoring or reestablishing corner:

Found iron pipe from 1971 witnesses and accepted as best evidence of original corner.

Ratified by Peer Group in accordance with P.A. 345 of 1990  
 Van Buren County Surveyor

Date 7-26-95 D.R.A.

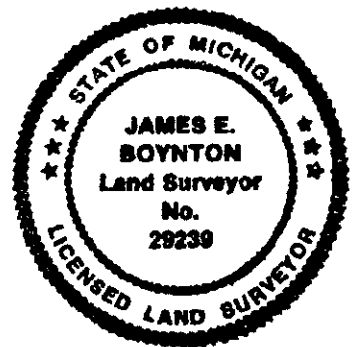

C. Description of monument for corner and accessories established to perpetuate locating the position of the corner:

Set standard marker over pipe as directed by the Peer Group on July 26, 1995.

Twin Oak N. 40° W. 36.61' to nail  
 4" Pine N. 25° E. 68.48' to nail  
 N.E. Cor. Concrete foundation, S. 40° E. 37.88'  
 Standard marker at N. 1/4 Post of Sec. 5, Porter  
 48.96' East.

Signed by James E. Boynton Date December 17, 1995  
 Surveyor's Michigan License No. 29239

Sheet Pg. 343