

JAN 17 1996

Dec 22 9 52 AM '95

COMMISSION

LAND CORNER RECORDATION CERTIFICATE
Filing Requirement of Act 74, Mich. P.A. 1970

For corners in

Van Buren
(County)

Located in:

Corner Code #

S.W. Cor. Sec. 33

1. Public Land Survey

T 3 S R 13 W

E-13

2. Property Controlling in Section

S T R

3. Miscellaneous Property in Sec.

S T R

4. Lot No. _____, Recorded Plat _____

5. Private Claims _____

Mark A. Smith
VAN BUREN CO.
REGISTER OF DEEDS

Register of Deeds Stamp & File Number

I, James E. Boynton, in a field survey on October 2, 19 95, do hereby certify that under requirements of P.A. 74, Michigan P.A. of 1970, the corner points mentioned in lines 1 and 2 above were in conformance with regulations and rules therefore as required in the current manual of survey instructions of the United States Department of the Interior, Bureau of Land Management or by a decree of a Court of Law and/or that the corner points mentioned in lines 3, 4 and 5 above were in conformance with the rules of the Michigan Board of Land Surveyors or by a Decree of a Court of Law; established, re-established, monumented, re-monumented, recovered, found as expressed below:

	A	B	C	D	E	F	G	H	I	J	K	L	M
2	6		5		4		3		2		1		
3													
4	7		8		9		10		11		12		
5													
6	18		17		16		15		14		13		
7													
8	19		20		21		22		23		24		
9													
10	30		29		28		27		26		25		
11													
12	31		32		33		34		35		36		
13													

NOTE: Not more than 4 corners, all in the same town and range, may be recorded on this certificate.

A. Description of original monument and accessories and/or subsequent restoration:

1827, original corner established by William Brookfield, D.S.
1868, C.D. Lawton, C.S. notes show corner found - no description given.
1897, G. Muchler, C.S. notes show corner in place - no description given.
1943, 1964, 1971 show corner found - no description given.
1972, L.C.R.C. calls for 1" pipe in mon. box
1972 & 1973, many surveys show 1" pipe in mon. box.

B. Description of corner evidence found and/or method applied in restoring or reestablishing corner:

Found Pipe in monument box from above witnesses and accepted as best evidence of original corner.

Ratified by Peer Group in accordance with P.A. 345 of 1998
Van Buren County Surveyor

Date 7-26-95 D.R.A.

C. Description of monument for corner and accessories established to perpetuate locating the position of the corner:

Set standard marker in place of pipe as directed by the Peer Group on July 26, 1995.
S.W. Cor. garage N.34°E, 137.26'
12" Oak N.70°E, 138.55'
Oak S.75°E, 110.09'
Street sign S.02°E, 27.39'
Porter corner 42.16' East

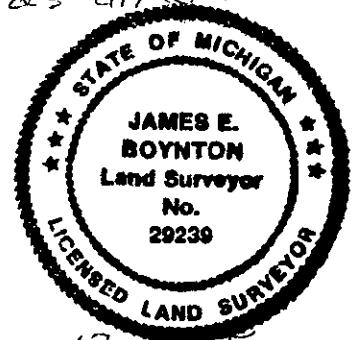

Signed by James E. Boynton
Surveyor's Michigan License No. 29239

Date December 17, 1995

Liber 4 Pg. 344