

SURVEY & REMONUMENTATION

FILED

JAN 14 1998

DEC 15 3 56 PM '97

SECTION

LAND CORNER RECORDATION CERTIFICATE
Filing Requirement of Act 74, Mich. P.A. 1970

For corners in

Mark A. Smith
VAN BUREN CO.
REGISTERED OF DEEDS

7-00

_____ Van Buren _____ Located in: _____ Corner Code # _____
 (County) Antwerp Township S.W. COR. SEC. 14

1. Public Land Survey T 3 S R 13 W 17
 T _____ R _____
 T _____ R _____
 T _____ R _____

2. Property Controlling S _____ T _____ R _____
 in Section S _____ T _____ R _____

3. Miscellaneous S _____ T _____ R _____
 Property in Sec. S _____ T _____ R _____

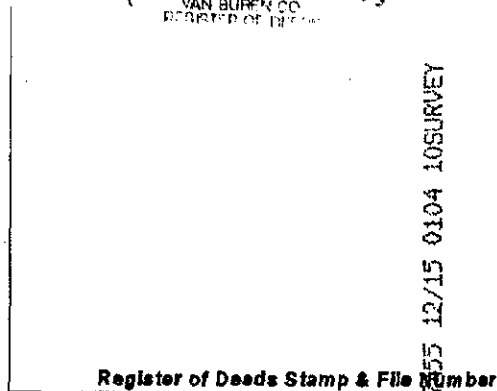

4. Lot No. _____, Recorded Plat _____
 5. Private Claims _____

I, James E. Boynton, in a field survey on August 18, 1997 do hereby certify that under requirements of P.A. 74, Michigan P.A. of 1970, the corner points mentioned in lines 1 and 2 above were in conformance with regulations and rules therefore as required in the current manual of survey instructions of the United States Department of the Interior, Bureau of Land Management or by a decree of a Court of Law and for that the corner points mentioned in lines 3, 4 and 5 above were in conformance with the rules of the Michigan Board of Land Surveyors or by a Decree of a Court of Law; established, re-established, monumented, re-monumented, recovered, found as expressed below:

	A	B	C	D	E	F	G	H	I	J	K	L	M
1													
2		6		5		4		3		2		1	
3													
4		7		8		9		10		11		12	
5													
6		18		17		16		15		14		13	
7									●				
8		19		20		21		22		23		24	
9													
10		30		29		28		27		26		25	
11													
12		31		32		33		34		35		36	
13													

NOTE: Not more than 4 corners, all in the same town and range, may be recorded on this certificate.

- A. Description of original monument and accessories and/or subsequent restoration:
 Original corner position established in 1830 by William Brookfield, D.S. In 1900 W. H. Goss found and used a pipe. In 1935 T. A. Smith, C.S. found and used the corner but gave no description of the corner. In 1964 J. Stack, L.S. found and used a 3/4" pipe. In 1976 D. R. Gilchrist, C.S. found a pipe 3' South of the centerline of pavement and set an iron bar over. In 1993 J. Hunt, L.S. found and used a 1" pipe 3' South of centerline pavement.
- B. Description of corner evidence found and/or method applied in restoring or reestablishing corner:
 Found a 1" pipe from witnesses and accepted as the best available evidence of the corner location.
- C. Description of monument for corner and accessories established to perpetuate locating the position of the corner:
 Set Standard Remon Monument in place of the pipe as directed by the Peer Group during the regular meeting of June 25, 1997.
 Mon. is 3' ± South of centerline pavement
 14" Oak N37°W 47.12' to nail
 12" Oak N60°E 35.48' to nail
 10" Pine S35°E 38.78' to nail
 8" Oak S03°W 26.68' to nail

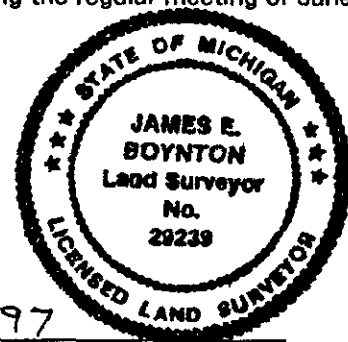

Signed by James E. Boynton Date 12-12-97
 Surveyor's Michigan License No. 29239

FORM APPROVED BY MICHIGAN STATE BOARD OF LAND SURVEYORS, JAN. 28, 1971
 REVISED MAY 14, 1975
 REVISED JAN., 1983

Ratified by Peer Group in accordance with P.A. 345 of 1990
 Van Buren County Surveyor

Date D. R. A. 12/15/97

Liber 5 Pg. 40