

DEC 17 1 39 PM '96

LAND CORNER RECORDATION CERTIFICATE  
Filing Requirement of Act 74, Mich. P.A. 1970

*Mark A. Smith*  
VAN BUREN CO  
REGISTER OF DEEDS

7.00

For corners in

<u>Van Buren Co., Antwerp Twp.</u> (County)	Located In:	Corner Code #
1. Public Land Survey S.W. Cor. Sec. 13	T. 3 S. R. 13 W	K-7
	T. R	
	T. R	
	T. R	
2. Property Controlling in Section	S. T. R	
	S. T. R	
3. Miscellaneous Property in Sec.	S. T. R	
	S. T. R	

12/17 0101 10SURVEY

*LIBER 4 PAGE 446*

Register of Deeds Stamp & File Number

4. Lot No. \_\_\_\_\_, Recorded Plat \_\_\_\_\_  
5. Private Claims \_\_\_\_\_

I, James E. Boynton, P.S., in a field survey on May 17, 1996  
do hereby certify that under requirements of P.A. 74, Michigan P.A. of 1970, the corner points mentioned in lines 1 and 2 above were in conformance with regulations and rules therefore as required in the current manual of survey instructions of the United States Department of the Interior, Bureau of Land Management or by a decree of a Court of Law and /or that the corner points mentioned in lines 3, 4 and 5 above were in conformance with the rules of the Michigan Board of Land Surveyors or by a Decree of a Court of Law; established, re-established, monumented, re-monumented, recovered, found as expressed below:

A	B	C	D	E	F	G	H	I	J	K	L	M
1												
2	6		5		4		3		2		1	
3												
4	7		8		9		10		11		12	
5												
6	18		17		16		15		14		13	
7												
8	19		20		21		22		23		24	
9												
10	30		29		28		27		26		25	
11												
12	31		32		33		34		35		36	
13												

NOTE: Not more than 4 corners, all in the same town and range, may be recorded on this certificate.

A. Description of original monument and accessories and/or subsequent restoration:

Original corner set in 1829 by William Brookfield, D.S.

W.H. Goss C.S. found stone in 1890 and George Mutchler C.S. found stone in 1901. W.Q. Smith C.S. found 5/8" iron bar in 1953. The corner was used many times through 1993 when John C. Hunt found a 5/8" iron bar.

B. Description of corner evidence found and/or method applied in restoring or reestablishing corner:

Found 5/8" iron bar over an 18" stone over a 10" stone from witnesses given in the many previous surveys.

SURVEY &  
REMONUMENTATION

MAY 16 1997

COMMISSION

Ratified by Peer Group in  
accordance with P.A. 345 of 1990  
Van Buren County Surveyor

Date 12/17/96 D.R.G.

C. Description of monument for corner and accessories established to perpetuate locating the position of the corner:

Set standard marker in the position of the 5/8" iron bar as the best available evidence of the original corner as directed by the Peer Group at a regular meeting on May 1, 1996.

Light Pole N.45°E. 60.17' to nail.                      Tele. Pole N.45°W. 83.57' to nail.  
Light Pole S.45°W. 54.78' to nail.  
Corner is 6' East and 1' South of centerline of streets.

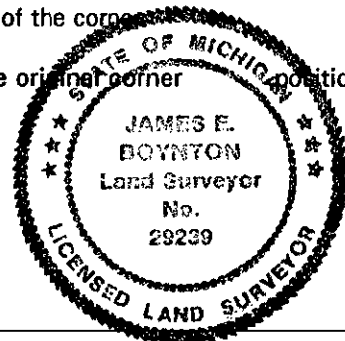

Signed by James E. Boynton  
Surveyor's Michigan License No. 29239

Date 12-16-96