

FILED

Dec 1 9 28 AM '99

LAND CORNER RECORDATION CERTIFICATE

FILING REQUIREMENTS OF ACT 74, MICH. P.A. 1970

Mark A. Smith
VAN BUREN CO
REGISTER OF DEEDS

9.00
8190 12/01 0104 10SURVEY

South 1/4 Post, Section 23 Paw Paw Township

FOR CORNERS OF:	LOCATED IN:	CORNER CODE NUMBER
1. PUBLIC LAND SURVEY	. T. <u>3</u> S., R. <u>14</u> W.	J-9
2. PROPERTY CONTROLLING IN SECTION	. T. _____ S., R. _____ W.	
3. MISCELLANEOUS PROPERTY IN SECTION	. T. _____ S., R. _____ W.	
4. LOT NO. _____	RECORDED PLAT _____	
5. PRIVATE CLAIMS _____		

SURVEY & RECORDED

DEC 28 1999

SECTION

REGISTER OF DEEDS STAMP AND FILING NUMBER

I, Charles D. Lossie, P.S., in a field survey on 18-Oct, 19 99 do hereby state that under requirements of P.A. 74, Michigan P.A. of 1970, the corner points mentioned in lines 1 and 2 above were in conformance with regulations and rules therefore as required in the current manual of survey instructions of the United States Department of the Interior, Bureau of Land Management or by a decree of a Court of Law and/or that the corner points mentioned in lines 3, 4 and 5 above were in conformance with the rules of the Michigan Board of Land Surveyors or by a Decree of a Court of Law; established, re-established, monumented, recovered, found as expressed below:

1	A	B	C	D	E	F	G	H	I	J	K	L	M
2	6	5	4	3	2	1							
3													
4	7	8	9	10	11	12							
5													
6	16	17	16	15	14	13							
7													
8	19	20	21	22	23	24							
9													
10	30	29	28	27	26	25							
11													
12	31	32	33	34	35	36							
13													

NOTE: Not More than 2 corners, all in the same town and range may be recorded on this certificate.

A. Description of original monument and accessories and/or subsequent restoration:
5/1830- GOVERNMENT - William Brookfield, D.S.

Corrected West between Sections 23 and 26 a distance of 40.10 chs. (2646.60') and set Quarter Section Post.

Witnesses:

11" Mulberry - N. 49° W., 16 lks (10.56')

11" Mulberry - N. 76° E., 34 lks (22.44')

See Back for Additional Corner History

B. Description of corner evidence found and/or method applied in restoring or re-establishing corner:

Found Flat iron strap. A.A. Fosdick, C.S., used a 6" Maple, S. 26° W., 40.92' as a witness. This tree still stands. It was also used by W. H. Goss, C.S., 1921 and W.Q. Smith, C.S., 1971. This position of the Government Monument was accepted and restored with the approval of the Van Buren County Remonumentation Peer Group of Surveyor's on September 1, 1999 as the best available evidence of the position of the original corner.

C. Description of monument for corner and accessories established to perpetuate locating the position of the corner:

Set Harrison Marker as the position of the found iron strap.
 8" Box Elder, N. 05°E., 25.78' to PK and Washer
 Phone Pole, N. 85° W., 52.27' to PK and Washer
 48" Maple (old witness dates to 1888), S. 30° W., 40.17'
 10" Twin Walnut, S. 40°E., 113.65'
 10' ± West of fence to South.
 03' ± North of Centerline East and West Road

Ratified by Peer Group in accordance with P.A. 345 of 1990
Van Buren County Surveyor

Date 12-1-99 D. R. G.

Signed by Charles D. Lossie P.S.
Charles D. Possie, P.S.

Surveyor's Michigan License No. 44291

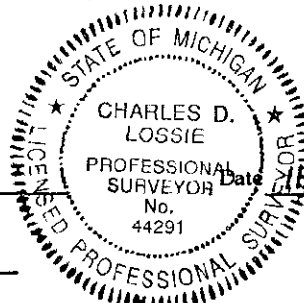

Liber 5 pg 240

South 1/4 Post, Section 23, Paw Paw Township (J-9)

1888 - A.A. Fosdick, C.S.

Section 23
Book 5 - Page 35
Found Corner.

Witnesses:

6" Sugar S .19° W., - 30 lks. (19.80').
6" Sugar - S. 26 ° W., - 62 lks (40.92').
Ran North to Center Quarter Post.

CUNNEY &
RECORDERS

DEC 28 1999

SECTION

4/1/1921 - W. H. Goss, C.S.

Section 23
Red Book
Iron Bar

Witnesses:

24" Sugar - Southwest - 60.5 lks (39.93')
18" Elm - Southeast - 2.25 lks. (1.49')
Distance West is 40.61 chs. (2680.26')
Distance East is 40.61 chs. (2680.26')

12/1971 - W. Q. Smith, C.S.

Section 23
Found rectangular pipe 15 x 5
Distance West is 2656.14'
Distance East is 2652.14'
Distance North is 2648.36'

Recordation Certificate (Liber 1 - Page 70) D.A. Middleton, R.L.S./ S & S

Witnesses:

40" Maple - S. 30 ° W., - 40.21'
14" - N. 20 ° W., 11.60'
3' North of Centerline East and West Road
10" West of Fence South.

9/11/1974 - W. Q. Smith, R.L.S.

Section 23
Recorded Survey (Liber 8 - Page 105)
Same as above.