

1993

VAN BUREN COUNTY REMONUMENTATION PROGRAM

LAND CORNER RECORDATION CERTIFICATE
Filing Requirement of Act 74, Mich. P.A. 1970

Oct 19 11 52 AM '93

LIBER 4 PAGE 69

For corners in

<u>Van Buren</u> (County)	Located in: Keeler Twp.	Corner Code # G-3
1. Public Land Survey Sec. 3	T <u>4</u> S. R <u>16</u> W.	_____
	T _____ R _____	_____
	T _____ R _____	_____
	T _____ R _____	_____
2. Property Controlling in Section	S _____ T _____ R _____	_____
	S _____ T _____ R _____	_____
3. Miscellaneous Property in Sec.	S _____ T _____ R _____	_____

Mark A. Smith
VAN BUREN CO.
REGISTER OF DEEDS

9.00

10/17 0101 10SURVEY

Register of Deeds Stamp & File Number

- 4. Lot No. _____, Recorded Plat _____
- 5. Private Claims _____

	A	B	C	D	E	F	G	H	I	J	K	L
2	6	5	4	3	2							
3												
4	7	8	9	10	11	12						
5												
6	18	17	16	15	14	13						
7												
8	19	20	21	22	23	24						
9												
10	30	29	28	27	26	25						
11												
12	31	32	33	34	35	36						
13												

I, John C. Hunt, P.S., in a field survey on July 20, 19 93, do hereby certify that under requirements of P.A. 74, Michigan P.A. of 1970, the corner points mentioned in lines 1 and 2 above were in conformance with regulations and rules therefore as required in the current manual of survey instructions of the United States Department of the Interior, Bureau of Land Management or by a decree of a Court of Law and/or that the corner points mentioned in lines 3, 4 and 5 above were in conformance with the rules of the Michigan Board of Land Surveyors or by a Decree of a Court of Law; established, re-established, monumented, re-monumented, recovered, found as expressed below:

NOTE: Not more than 4 corners, all in the same town and range, may be recorded on this certificate.

A. Description of original monument and accessories and/or subsequent restoration:

3/1830 Gov. Survey, EH Lytle DS: N. bet. Sec. 9 & 10, set Post cor. 80.00 ch.; Wit.: 18" Beech S.13°W. 16 lks.; 4" Beech N.30°W. 15 lks. 12/1/1870 & 12/21/1873 AJ Pierce CS: Bk. 4 pg. 41, 109, & 155. 1870 Stake graded out but renewed from well authenticated board fence on each side. Slanted stone (marked) 2' West. Meas. S. to ¼ post 40.10 ½ ch. (2646.93'). 8/9/1900 Geo. Mutchler CS: Bk. 6 pg. 48: Re-wit. 18" Walnut S.14°E. 83½ lks.; 12" Sugar N.71°30'E. 42 lks. Meas. N. 20.01½ ch. (1320.99') to 1/8 post. Cont. N. 20.01½ ch. (1320.99') to ¼ post for a total of 2641.98'.

B. Description of corner evidence found and/or method applied in restoring or reestablishing corner:

G-3 Section corner common to Sections 3, 4, 9, & 10 T4S-R16 W. Keeler Twp.

Corner evidence found: RR spike 8' W. C/L C.R. 687.

July 20, 1993 Set Harrison Marker as per Peer Group approval on July 14, 1993. On July 28 1993, Monument Box was set over Harrison Marker.

THIS GOVERNMENT MONUMENT WAS RESTORED WITH APPROVAL OF THE VAN BUREN COUNTY REMONUMENTATION PEER GROUP OF SURVEYORS AT A MEETING HELD ON JULY 14, 1993, AND IS ACCEPTED AS A CAREFUL AND FAITHFUL REESTABLISHMENT OF THE POSITION OF THE ORIGINAL CORNER.

(See sketch on back.)

C. Description of monument for corner and accessories established to perpetuate locating the position of the corner:

G-3 HARRISON MARKER IN MONUMENT BOX

N.88°E. 83.09' Nail & tag in S. face of 3" fruit tree.

S.44°W. 53.00' Nail & tag in NW face of pole.

S.62°E. 80.27' Nail & tag in N. face of 4" Apple tree.

N.11°W. 194.70' Nail & tag in E. face of pole.

Signed by John C. Hunt, P.S.

Date Oct. 16, 1993

Surveyor's Michigan License No. 23513

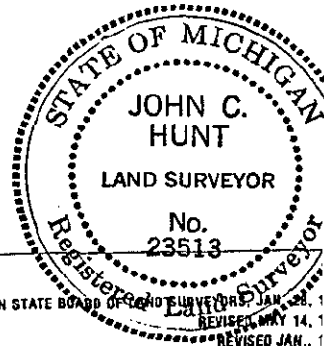

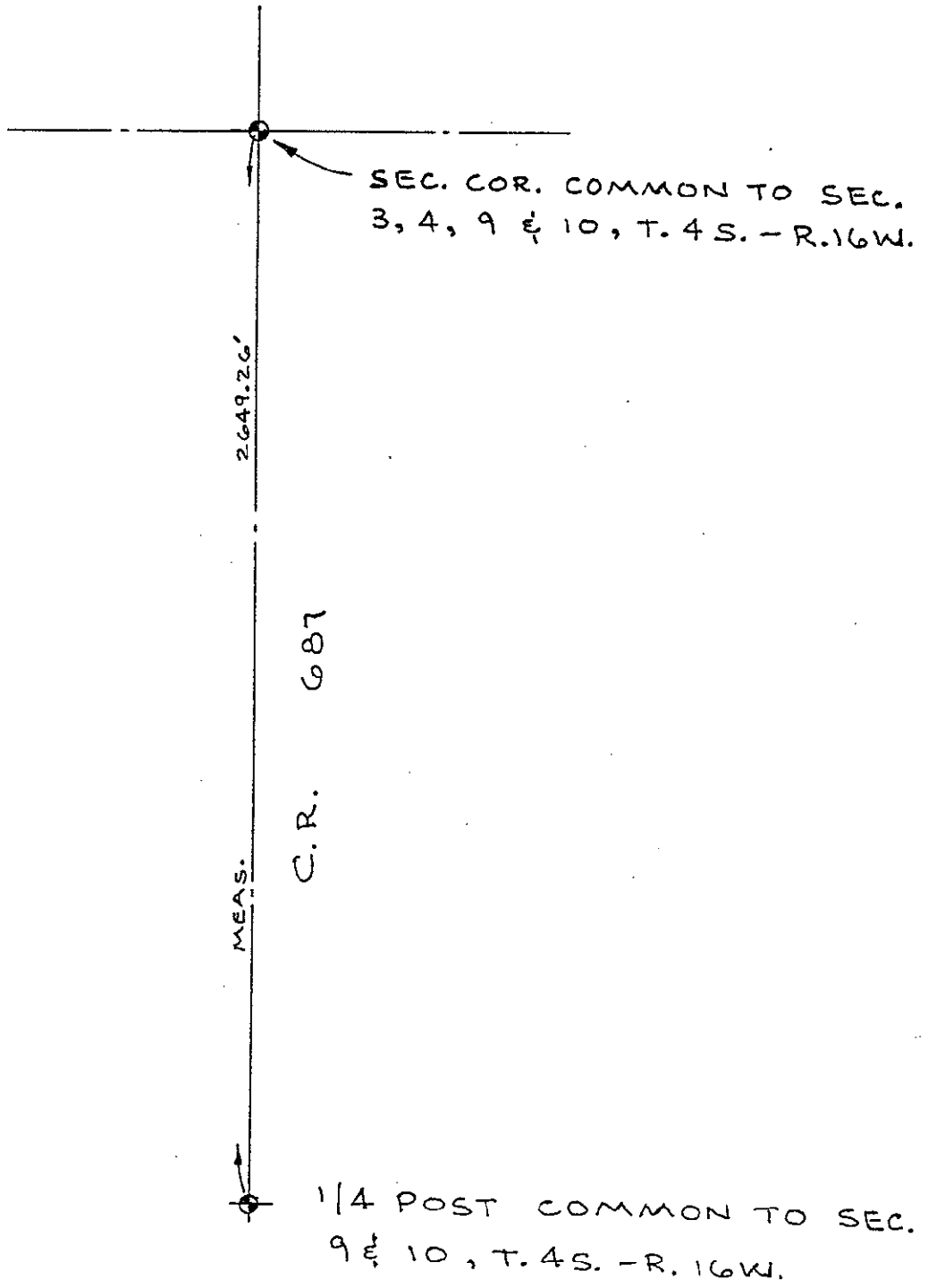

NO SCALE.