

FEB 28 1994

LAND CORNER RECORDATION CERTIFICATE
Filing Requirement of Act 74, Mich. P.A. 1970

COMMISSION

For corners in

WAYNE COUNTY (County) Located In: Corner Code #
1. Public Land Survey T 1S R 8E I 7
2. Property Controlling in Section S T R
3. Miscellaneous Property in Sec. S T R
4. Lot No. , Recorded Plat
5. Private Claims

Compliance with ACT 345, P.A. 1990
APPROVED ON: 12-21-93
WAYNE COUNTY REMONUMENTATION PEER GROUP COMMITTEE

Register of Deeds Stamp & File Number

I, RAPHAEL LANDINI, in a field survey on NOVEMBER 22, 19 93, do hereby certify that under requirements of P.A. 74, Michigan P.A. of 1970, the corner points mentioned in lines 1 and 2 above were in conformance with regulations and rules therefore as required in the current manual of survey instructions of the United States Department of the Interior, Bureau of Land Management or by a decree of a Court of Law and/or that the corner points mentioned in lines 3, 4 and 5 above were in conformance with the rules of the Michigan Board of Land Surveyors or by a Decree of a Court of Law; established, re-established, monumented, re-monumented, recovered, found as expressed below:

Grid table with columns A-M and rows 2-13. A dot is marked at row 7, column H.

NOTE: Not more than 4 corners, all in the same town and range, may be recorded on this certificate.

A. Description of original monument and accessories and/or subsequent restoration:

G.L.O.
ASH 5 N15E 18 (11.9) (GONE)
SASSAFRAS 8 S15W 12 (7.9) (GONE)

W.P.A. 1930S IRON
30" ELM NE 44.12 (GONE)
20" MAPLE ENE 48.25 (MEAS. 47.17)
15" MAPLE SE 66.32 (MEAS. 66.17)
16" TREE NW 100.80 (GONE)

B. Description of corner evidence found and/or method applied in restoring or reestablishing corner:

WAYNE COUNTY ROAD COMM. 1970 FOUND MON. IN BOX
27" MAPLE NE 47.57 (MEAS. 47.17)
24" MAPLE SE 66.08 (MEAS. 66.17)
6" ASH NW 40.04 (MEAS. 40 +/- TO 16" TREE)

LCRC RC 851 L22467 P801 FD STD MON MON IN MON BOX
FOUND PK NAIL E.S. T.P. N 5°W 12.27 (MEAS. 12.29)
FOUND PK NAIL IN TAG E.S. 10" ASH NORTH 21.17 (MEAS. 21.10)
FOUND NAIL AND TAG NW SIDE 36" MAPLE N 45°E 47.25 (MEAS. 47.17)
FOUND PK NAIL N.S. 36" MAPLE S.60°E 66.07 (MEAS. 66.17)
MON BOX IN OLD CONCRETE ROAD +/- 3'S 0+ N EDGE.

C. Description of monument for corner and accessories established to perpetuate locating the position of the corner:
FOUND STANDARD MONUMENT WITH 3/8" IRON IN MON. BOX; SET REMONUMENTATION DISK WITH CAP RJL RLS 16933. SELECTED LOCATION IS ACCEPTED BY CONTRACTOR AND IS GENERALLY ACCEPTED BY PROFESSIONAL SURVEYORS AS THE BEST AVAILABLE EVIDENCE OF THE POSITION OF THE ORIGINAL CORNER.

FOUND WCRC BRASS TAG W. SIDE 11" TREE N48°E 27.05
FOUND WCRC BRASS TAG W. SIDE 32" TREE N68°E 47.17
SET WCR TAG NE SIDE 31" TREE S49°E 66.17
FOUND WCRC BRASS TAG SW SIDE 11" TREE S26°E 42.14
SET WCR TAG E SIDE 9" TREE S40°W 50.94
FOUND WCRC TAG E SIDE TEL POLE N07°W 12.29
FOUND WCRC TAG SW SIDE 14" TREE N06°E 21.20

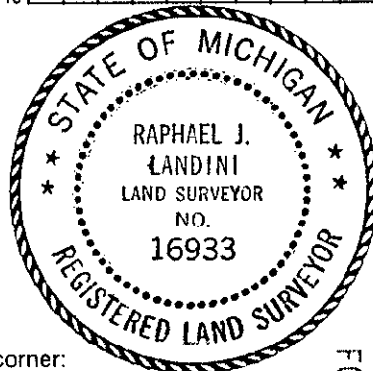

93 DEC 22 AM 10: 20
FOREST E. YOUNGBLOOD
REGISTER OF DEEDS
MAYNARD AVENUE, MI

Signed by [Signature] Date DECEMBER 17, 1993
Surveyor's Michigan License No. 16933

Handwritten initials: 2L 11KD