

**FILE DO NOT M.  
SURVEY &  
REMONUMENTATION**

**MAR 17 1998**

**LAND CORNER RECORDATION CERTIFICATE**  
Filing Requirement of Act 74, Mich. P.A. 1970

**SECTION**  
For corners in

WAYNE  
(County)

Located In: PLYMOUTH TWP. Corner Code #

- |                                    |   |            |   |            |            |
|------------------------------------|---|------------|---|------------|------------|
| 1. Public Land Survey              | T | <u>1</u> S | R | <u>8</u> E | <u>M-6</u> |
|                                    | T |            | R |            |            |
|                                    | T |            | R |            |            |
|                                    | T |            | R |            |            |
| 2. Property controlling in Section | S |            | T | R          |            |
|                                    | S |            | T | R          |            |
| 3. Miscellaneous Property in Sec.  | S |            | T | R          |            |
|                                    | S |            | T | R          |            |
4. Lot No. \_\_\_\_\_, Recorded Plat \_\_\_\_\_  
5. Private Claims \_\_\_\_\_

Compliance with  
**ACT 345, P.A. 1990**  
**APPROVED ON: 12-8-97** *DPJ*  
**WAYNE COUNTY REMONUMENTATION  
PEER GROUP COMMITTEE**

Register of Deeds Stamp & File Number

I, CHRISTOPHER S. LAMUS, in a field survey on DECEMBER 3, 19 97, do hereby certify that under requirements of P.A. 74, Michigan P.A. of 1970, the corner points mentioned in lines 1 and 2 above were in conformance with regulations and rules therefore as required in the current manual of survey instructions of the United States Department of the Interior, Bureau of Land Management or by decree of a Court of Law and/or that the corner points mentioned in lines 3,4 and 5 above were in conformance with the rules of the Michigan Board of Land Surveyors or by Decree of a Court of Law; established, re-established, monumented, re-monumented, recovered, found as expressed below:

NOTE: Not more than 4 corners, all in the same town and range, may be recorded on this certificate

	A	B	C	D	E	F	G	H	I	J	K	L	M
2	6	5	4	3	2	1							
3													
4	7	8	9	10	11	12							
5													
6	18	17	16	15	14	13							
7													
8	19	20	21	22	23	24							
9													
10	30	29	28	27	26	25							
11													
12	31	32	33	34	35	36							
13													

A. Description of original monument and accessories and/or subsequent restoration:

ORIG. GOVERNMENT NOTES 1815  
BY JOSEPH WAMPLER - SET POST  
18" ELM N.07°E. 14 LINKS (1)  
6" SUGAR S.58°W. 18 LINKS (2)

44.00 REMONUMENTATION  
RECORDED  
FORPOST E. YOUNG, REGISTER OF DEEDS  
WAYNE COUNTY, MI  
Receipt #41910

NO G.L.O. WITNESSES REMAIN

47.00 DEED

B. Description of corner evidence and/or method applied in restoring or reestablishing corner:

WAYNE CO. ROAD COMMISSION (APR. 1970)  
FOUND MONUMENT  
SOUTH 83.25' MONUMENT (3)  
SE'LY 26.98' 6" ASH (4)  
NORTH 264.00' FENCE COR (5)

PUBLIC ACT 74 L.C.R.C. L.20238, P.407  
FOUND CONCRETE MONUMENT ON FENCE LINE.  
N 71° W 57.19' NAIL & CAP IN 4" ELM (6)  
S 3° W 8.43' NAIL & CAP IN FENCE POST (7)  
S 16° E 26.82' NAIL & CAP IN 8" ASH (4)  
N 00° W 264.04' FENCE INT. N. (5)

**NOT A COMMON CORNER.**

DISTANCE TO M-5 2641.30' (M) RECORDED AS 2640.95' BY WAYNE COUNTY BUREAU OF TAXATION.  
DISTANCE TO M-7 2659.31' (M) RECORDED AS 2659.30' BY WAYNE COUNTY BUREAU OF TAXATION.

C. Description of monument for corner and accessories established to perpetuate locating the position of the corner:

M-6  
SET 3/4" X 4' IRON ROD PER WAYNE CO. BUREAU OF TAXATION SECTION MAP INFORMATION. SET SURVEYOR'S CAP #41914 AND BRASS W.C. REMON WASHER OVER IRON ROD.

S.56°E.	113.03'	NW CORNER OF BRICK HOUSE # 16043
S.54°W.	17.74'	NAIL IN BRASS W.C.R. WASHER IN N.SIDE OF 15" HARDWOOD TREE
N.1°E.	18.45'	FOUND 5/8" IRON PIPE
N.18°E.	16.18'	CENTER LINE BEEHIVE C.B.
S.79°E.	1.87'	CONCRETE MON. W 1/4 COR. SEC. 18 LIVONIA TWP.(3)
S.1°W.	83.06'	FENCE INT. (5)
N00°W.	264.00'	CHRISTOPHER S. LAMUS

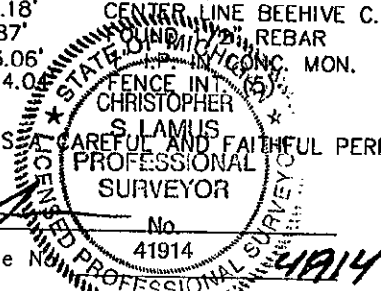

THE SELECTED LOCATION IS A CAREFUL AND FAITHFUL PERPETUATION OF THE POSITION OF THE ORIGINAL CORNER.

Signed by Christopher S. Lamus  
Surveyor's Michigan License No. 41914

Date 12/11/97