

**FILE DO NOT MAIL**

**LAND CORNER RECORDATION CERTIFICATE**  
 Filing Requirement of Act 74, Mich. P.A. 1970

**SECTION**

For corners in

Wayne, Redford Twp. (County)	Located in: Detroit	Corner Code #
1. Public Land Survey	T <u>1S.</u> R <u>10E</u>	<u>I-6</u>
	T <u>    </u> R <u>    </u>	<u>    </u>
	T <u>    </u> R <u>    </u>	<u>    </u>
	T <u>    </u> R <u>    </u>	<u>    </u>
2. Property Controlling in Section	S <u>    </u> T <u>    </u> R <u>    </u>	<u>    </u>
	S <u>    </u> T <u>    </u> R <u>    </u>	<u>    </u>
3. Miscellaneous Property in Sec.	S <u>    </u> T <u>    </u> R <u>    </u>	<u>    </u>
	S <u>    </u> T <u>    </u> R <u>    </u>	<u>    </u>

Liber-30845 Page-23  
 99592693 12/28/1999  
 F.E. Youngblood, Wayne Co. Register of Deeds  
 RDANDSYL

Compliance with  
 ACT 345, P.A. 1990

APPROVED ON: DEC. 9, 1999  
 WAYNE COUNTY REMONUMENTATION  
 PEER GROUP COMMITTEE  
 Register of Deeds Stamp & File Number

4. Lot No. \_\_\_\_\_, Recorded Plat \_\_\_\_\_  
 5. Private Claims \_\_\_\_\_

I, William L. Roskelly, in a field survey on Dec 11, 1999 do hereby state that under requirements of P.A. 74, Michigan P.A. of 1970, the corner points mentioned in lines 1 and 2 above were in conformance with regulations and rules therefore as required in the current manual of survey instructions of the United States Department of the Interior, Bureau of Land Management or by a decree of a Court of Law and/or that the corner points mentioned in lines 3, 4 and 5 above were in conformance with the rules of the Michigan Board of Land Surveyors or by a Decree of a Court of Law; established, re-established, monumented, recovered, found as expressed below:

	A	B	C	D	E	F	G	H	I	J	K	L	M
1													
2	6		5		4		3		2		1		
3													
4	7		8		9		10		11		12		
5													
6	18		17		16		15		14		13		
7													
8	19		20		21		22		23		24		
9													
10	30		29		28		27		26		25		
11													
12	31		32		33		34		35		36		
13													

NOTE: Not more than 2 corners, all in the same town and range, may be recorded on this certificate.

A. Description of original monument and accessories and/or subsequent restoration:  
I-6) East corner section 15, T.1 S., R.10 E., Redford Township, City of Detroit  
 G.L.O. (1830's) Joseph Fletcher set corner, Witnesses: Beech 10N 31 E 4, Do 10S 9W 28  
 W.P.A. (1930's) no witnesses.

B. Description of corner evidence found and/or method applied in restoring or reestablishing corner:  
I-6) East corner section 15, T.1 S., R.10 E., Redford Township, City of Detroit  
 Set monument and monument box at the intersection of Evergreen and Lyndon Roads (pavement).  
 Corner location re-established using "Estes Park Sub.", L 34, P 9. From the found iron pipe NE corner of Lot 59 sighting found iron pipe SE corner Lot 31 measured to NW corner Lot 60 FIP, M=90@34'16" R=90@34'00". Set by intersection of offset line north 33' and east 43' as indicated on plat "Estes Park Sub.", L 34, P 9.

C. Description of monument for corner and accessories established to perpetuate locating the position of the corner:  
I-6) East corner section 15, T.1 S., R.10 E., Redford Township, City of Detroit  
 Set monument and monument box at the intersection of Evergreen and Lyndon Roads (pavement).  
 The selected location is a careful and faithful re-establishment of the position of the original corner.  
 Witnesses: N27@56'39"E. 52.33' set nail and WCR tag SE face power pole, S69@39'29"E. 46.22' set nail and WCR tag N face power pole, S42@42'51"E. 39.75' set steel bar and cap #10705, S45@26'37"W. 47.49' set nail and WCR tag N face power pole, S51@01'19"W. 53.94' found iron pipe, N70@01'02"W. 64.25' set nail and WCR tag N face power pole, N46@44'21"W. 56.48' found "+" in City of Detroit benchmark disc.  
 Placed Wayne County Remonumentation brass marker and stamped marker with #10705.

Signed by William L. Roskelly  
 Surveyor's Michigan License No. 10705

Date 12-28-99

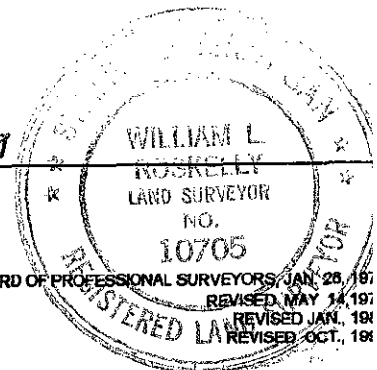

R LCR 9 4R 16 A 204