

RC 1246

LI 27015 PA 722

LAND CORNER RECORDATION CERTIFICATE
Filing Requirement of Act 74, Mich. P.A. 1970

For corners in

Wayne (County) Located In: Corner Code #/
1. Public Land Survey T 1 S. R 10 E. K-11
2. Property Controlling in Section S T R
3. Miscellaneous Property in Sec. S T R

Compliance with ACT 345, P.A. 1990
APPROVED ON: 12-7-93
WAYNE COUNTY REMONUMENTATION PEER GROUP COMMITTEE

Register of Deeds Stamp & File Number

4. Lot No. , Recorded Plat
5. Private Claims

I, William L. Roskelly in a field survey on October 28, 1993, do hereby certify that under requirements of P.A. 74, Michigan P.A. of 1970, the corner points mentioned in lines 1 and 2 above were in conformance with regulations and rules therefore as required in the current manual of survey instructions of the United States Department of the Interior, Bureau of Land Management or by a decree of a Court of Law and/or that the corner points mentioned in lines 3, 4 and 5 above were in conformance with the rules of the Michigan Board of Land Surveyors or by a Decree of a Court of Law: established, re-established, monumented, re-monumented, recovered, found as expressed below:

Grid table with columns A-M and rows 2-13. A black dot is located at the intersection of column I and row 11.

NOTE: Not more than 4 corners, all in the same town and range, may be recorded on this certificate.

A. Description of original monument and accessories and/or subsequent restoration:

No G.L.O. Witnesses remain
Joseph Fletcher G.L.O. (1816) Witnesses: Beech 10N66 E11 DO 10N43 W 12

B. Description of corner evidence found and/or method applied in restoring or reestablishing corner:

Found mon. box with bronze disk with punch in center.
Measured from K-11 to centerline of Archdale Road R&M 326± Hearne Pg. #188.
Measured from K-11 to centerline of Ashton Road R&M 318± Hearne Pg. 178.

C. Description of monument for corner and accessories established to perpetuate locating the position of the corner:

K-11: Section corner 25,26,35 & 36 Found monument box with bronze disk with punch in center at Plymouth Road & Southfield Expressway. The selected location is accepted by the Contractor and is generally accepted by professional surveyors as the best available evidence of the position of the original corner. Placed Wayne Co. brass disk with license #10705.
Found P.K. & MSHD Tag N. 16° E. dist. 71.05
Found P.K. nail S. 36° E. dist. 82.35
Found WCRC BM bronze disk used period between B.M. as reference point S. 8° W. dist. 43.55
Set WCRC Tag N. 40° W. dist. 54.32

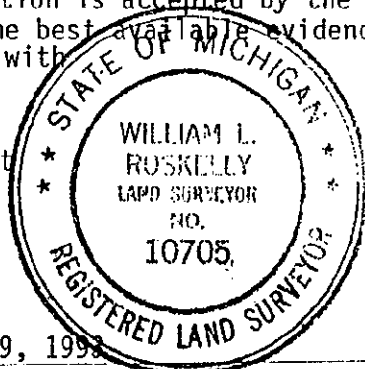

Signed by [Signature]
Surveyor's Michigan License No. 10705

Date November 9, 1993

Handwritten initials: RR 11K7