

LAND CORNER RECORDATION CERTIFICATE
Filing Requirement of Act 74, Mich. P.A. 1970

For corners in

| | | |
|---------------------------------------|---|-----------------------------|
| <u>WAYNE</u> (County) | Located in: TOWNSHIP OF CANTON (#07) | Corner Code # <u>K-5</u> |
| 1. Public Land Survey | T <u>2S</u> R <u>8E</u> | <u>K-5</u> |
| | T _____ R _____ | _____ |
| | T _____ R _____ | _____ |
| | T _____ R _____ | _____ |
| 2. Property Controlling in Section | S _____ T _____ R _____ | _____ |
| | S _____ T _____ R _____ | _____ |
| 3. Miscellaneous Property in Sec. | S _____ T _____ R _____ | _____ |
| | S _____ T _____ R _____ | _____ |
| 4. Lot No. _____, Recorded Plat _____ | | |
| 5. Private Claims _____ | | |

LIBER **29337** PAGE **570**

Compliance with
ACT 345, P.A. 1990
APPROVED ON: 11-13-96
WAYNE COUNTY REMONUMENTATION
PEER GROUP COMMITTEE

Register of Deeds Stamp & File Number

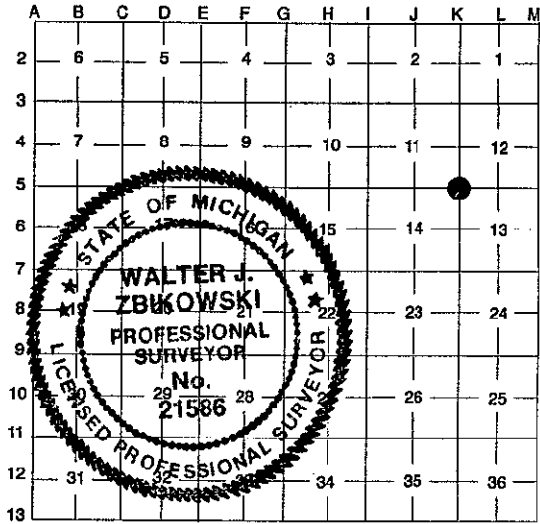

I, WALTER J. ZBIKOWSKI, in a field survey on OCTOBER 14, 1996, do hereby certify that under requirements of P.A. 74, Michigan P.A. of 1970, the corner points mentioned in lines 1 and 2 above were in conformance with regulations and rules therefore as required in the current manual of survey instructions of the United States Department of the Interior, Bureau of Land Management or by a decree of a Court of Law and/or that the corner points mentioned in lines 3, 4 and 5 above were in conformance with the rules of the Michigan Board of Land Surveyors or by a Decree of a Court of Law; established, re-established, monumented, re-monumented, recovered, found as expressed below.

NOTE: Not more than 4 corners, all in the same town and range, may be recorded on this certificate.

A. Description of original monument and accessories and/or subsequent restoration.

ORIGINAL GOVERNMENT SURVEY BY T. WAMPLER, D.S. (1815-1819)
 G.L.O. (1819) NORTH, 80.00 CHAINS, SET POST COR 5, 11, 12, 13, 14 (DESCRIPTION OF CORNER NOT STATED IN NOTES)
 WITNESSES: POPLAR 19" N 54 E 11 (LINKS) (7.26') (GONE)
 IRON'D 8" N 77 W 16 (LINKS) (10.56') (GONE)

RESURVEY AT THE DIRECTION OF ALBERT E. CHAMPNEY, DIRECTOR OF WAYNE COUNTY BUREAU OF TAXATION

W.P.A. (1930's), CROSS NW-13 (#55)
 WITNESSES: NE 60.28' 10" CATALPA (GONE)
 ESE 92.04' 18" MAPLE (GONE)
 SE 44.84' POLE (GONE)
 SW 66.60' 4" ELM (GONE)
 NW 44.02' CROSS IN BASE OF SIGN (GONE)

\$ 7.00 DEED
 12 DEC 96 2:16 P.M. RECEIPT# 629
 RECORDED
 FOREST E. YOUNGBLOOD, REGISTER OF DEEDS
 WAYNE COUNTY, MI
 \$ 4.00 REMONUMENTATION

B. Description of corner evidence found and/or method applied in restoring or reestablishing corner.

FOUND A 1-1/4" PIPE WITH METAL CAP IN ROAD BOX (GOOD) AT THE INTERSECTION OF FORD ROAD (A SIX LANE ASPHALT SURFACE PAVEMENT) AND HAGGERTY ROAD (A FIVE LANE CONCRETE PAVEMENT)
 DISTANCE TO L-5 MEASURED AS 2732.19'; G.L.O. (1819) RECORD DISTANCE OF 41.00 CHAINS (2706.00'); W.P.A. (1930's) RECORD DISTANCES OF 2732.02' AND 2731.80';
 DISTANCE TO K-6 MEASURED AS 2640.66'; G.L.O. (1819) RECORD DISTANCE OF 40.00 CHAINS (2640.00'); W.P.A. (1930's) RECORD DISTANCES OF 2640.64' AND 2640.65';
 DISTANCE TO J-5 MEASURED AS 2609.60'; G.L.O. (1819) RECORD DISTANCE OF 39.50 CHAINS (2607.00'); W.P.A. (1930's) RECORD DISTANCE OF 2609.12'; L.20708 P. 31, CS 1627 (1979) RECORD DISTANCE OF 2609.70'
 L.17813 P.663, SET P.K. (1971) CS #34
 WITNESSES: S.33°39'E. 83.67' CROSS ON MANHOLE RIM (GONE)
 S.38°20'W. 61.97' CROSS ON CENTERLINE OF HYDRANT (GONE)
 N.41°39'W. 42.50' NAIL IN TELEPHONE POLE (GONE)
 L.20245, P.383, FOUND MONUMENT BOX (1978) RC #614
 WITNESSES: N.45°E. 82.48' NAIL AND TAG IN DETROIT EDISON POLE (MEASURED 82.35')
 S.45°E. 85.87' NAIL AND TAG IN DETROIT EDISON POLE (MEASURED 85.32') (POLE TO BE REMOVED)
 N.45°W. 43.45' NAIL AND TAG IN DETROIT EDISON POLE (GONE)
 L.20965, P.143, IRON IN MONUMENT BOX (1980) RC #733
 WITNESSES: N.45°E. 82.50' PK NAIL IN POWER POLE (MEASURED 82.35')
 S.45°E. 85.40' W.C.R.C. REF. MARKER (MEASURED 85.32' TO NAIL AND TAG IN POLE)
 N.45°W. 55.90' PK NAIL IN POWER POLE (GONE)

C. Description of monument for corner and accessories established to perpetuate locating the position of the corner.

K-5, SECTION CORNER 11, 12, 13, AND 14 T.2S., R.8E.
 PLACED A REMONUMENTATION BRASS DISC AND PVC CAP #21586 ON 1-1/4" PIPE IN ROAD BOX AT THE INTERSECTION OF FORD ROAD (A SIX LANE ASPHALT SURFACE PAVEMENT) AND HAGGERTY ROAD (A FIVE LANE CONCRETE PAVEMENT) AND IT IS ACCEPTED AS A CAREFUL AND FAITHFUL PERPETUATION OF THE POSITION OF THE ORIGINAL CORNER.
 WITNESSES: N.38°08'E. 82.35' FOUND NAIL IN WCRC BRASS REFERENCE DISC ON NW SIDE OF POWER POLE (SUPRA)
 S.45°55'E. 94.50' SET CHISELED "X" ATOP W'LY BOLT IN BASE OF STEEL LIGHT POLE
 S.29°55'W. 70.41' FOUND NAIL IN WCRC BRASS REFERENCE DISC ON SE SIDE OF DETROIT EDISON GOV POLE
 N.45°05'W. 74.16' SET CHISELED "X" ATOP E'LY BOLT IN BASE OF STEEL LIGHT POLE

Signed by Walter J. Zbikowski Date DEC. 11, 1996
 WALTER J. ZBIKOWSKI
 Surveyor's Michigan License No. 21586

96319309

Handwritten initials