

SURVEY & REMONUMENTATION

LAND CORNER RECORDATION CERTIFICATE, 4.00 REMONUMENTATION
 Filing Requirement of Act 74, Mich. P.A. 1970, 10.00 DEED

APR 05 1996

7 DEC 95 11:07 A.M. RECEIPT

For corners in

COMMISSION

WAYNE
 (County)

- | | | |
|------------------------------------|------------------------|--------------|
| 1. Public Land Survey | Located in: | Comer Code # |
| | TOWNSHIP OF CANTON #07 | |
| | T2S R8E | K-8 |
| | T_____ R_____ | _____ |
| | T_____ R_____ | _____ |
| | T_____ R_____ | _____ |
| 2. Property Controlling in Section | S_____ T_____ R_____ | _____ |
| | S_____ T_____ R_____ | _____ |
| 3. Miscellaneous Property in Sec. | S_____ T_____ R_____ | _____ |
| | S_____ T_____ R_____ | _____ |
| 4. Lot No. _____ | Recorded Plat _____ | |
| 5. Private Claims _____ | | |

RECORDED
 FOREST E. YOUNGBLOOD, REGISTERED
 WAYNE COUNTY, MI
LIBER 28448 PAGE 90
 Compliance with
 ACT 345, P.A. 1990
 APPROVED ON: 12-4-95 *DBJ*
 WAYNE COUNTY REMONUMENTATION
 PEER GROUP COMMITTEE
 Register of Deeds Stamp & File Number

I, **WALTER J. ZBIKOWSKI**, in a field survey on SEPTEMBER 19, 1995, do hereby certify that under requirements of P.A. 75, Michigan P.A. of 1970, the corner points mentioned in lines 1 and 2 above were in conformance with regulations and rules therefore as required in the current manual of survey instructions of the United States Department of the Interior, Bureau of Land Management or by a decree of a Court of Law and/or that the corner points mentioned in lines 3, 4 and 5 above were in conformance with the rules of the Michigan Board of Land Surveyors or by a Decree of a Court of Law; established, re-established, monumented, re-monumented, recovered, found as expressed below.

A	B	C	D	E	F	G	H	I	J	K	L	M
2	6	5	4	3	2	1						
3												
4	7	8	9	10	11	12						
5												
6	18	17	16	15	14	13						
7												
8	19	20	21	22	23	24						
9												
10	30	29	28	27	26	25						
11												
12	31	32	33	34	35	36						
13												

NOTE: Not more than 4 corners, all in the same town and range, may be recorded on this certificate.

- A. Description of original monument and accessories and/or subsequent restoration.
ORIGINAL GOVERNMENT SURVEY BY T. WAMPLER, D.S. (1815-1819)
 G.L.O. (1819) SET 1/2 M POST (DESCRIPTION OF CORNER NOT STATED IN NOTES)
 WITNESSES: ASH 5 N 30 E 7 (4.62' REC) (GONE)
 ASH 6 N 38 W 10 (6.60' REC) (GONE)
RESURVEY AT THE DIRECTION OF ALBERT E. CHAMPNEY, DIRECTOR OF WAYNE COUNTY BUREAU OF TAXATION
 WPA (1930s) CROSS W-24 (102)
 WITNESSES: NE 71.00' 12" ELDER (GONE)
 SE 62.75' 10" MAPLE (GONE)
 WCRC (1978) IRON W-24 (#102)
 WITNESSES: NE 54.08' "X" CUT IN I-BEAM OF GUARD RAIL (GONE)
 SE 72.44' NAIL IN WCRC BRASS REFERENCE DISC ON NE SIDE OF DETROIT EDISON POLE (MEASURED 72.45)
 SW 41.47' MICHIGAN BELL TELEPHONE POLE (GONE)
 W 28.57' "X" IN WALK OVER X-TILE 1.85' FROM F/WK (GONE)
- B. Description of corner evidence found and/or method applied in restoring or reestablishing corner.
 FOUND A CONCRETE MONUMENT IN A ROAD BOX (GOOD) IN THE CENTERLINE OF HAGGERTY ROAD (A 2 LANE CONCRETE ROAD)
 DISTANCE TO K-9 MEASURED AS 2675.11'; RECORD G.L.O. (1819) DISTANCE OF 40.00 CHAINS (2640.00') RECORD
 W.P.A. (1930s) DISTANCES OF 2674.59' AND 2675.03'
 DISTANCE TO K-7 MEASURED AS 2675.02'; RECORD G.L.O. (1819) DISTANCE OF 40.00 CHAINS (2640.00') RECORD
 W.P.A. (1930s) DISTANCES OF 2674.84' AND 2675.07'
 DISTANCE TO J-8 MEASURED AS 2598.89'; RECORD W.P.A. (1930s) DISTANCE OF 2598.22'
 L.20887 P. 665 FOUND 1/2" IRON BAR (1980) LCRC #728
 N.53°E 54.10' NW EDGE OF N'LY BRACE ON GUARD RAIL (GONE)
 S.50°E 72.39' PK NAIL W. SIDE DETROIT EDISON POLE (MEASURED 72.30')
 S.37°W 41.37' PK NAIL E. SIDE MICHIGAN BELL TELEPHONE POLE (GONE)
 N.41°W 50.02' CORNER OF WW FENCE (GONE)

95261589

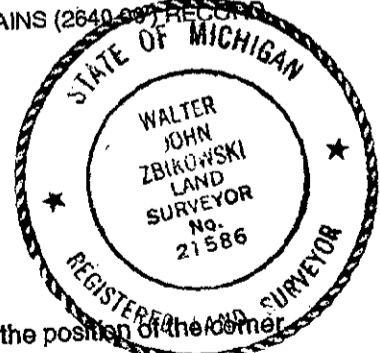

(CONTINUED ON BACK)

- C. Description of monument for corner and accessories established to perpetuate locating the position of the corner.
 K-8 SECTION CORNER 23, 24 T.2S, R.8E
 A CONCRETE MONUMENT IN A ROAD BOX (GOOD) IN THE CENTERLINE OF HAGGERTY ROAD (A TWO LANE CONCRETE ROAD)
 AND IT IS ACCEPTED AS A CAREFUL AND FAITHFUL PERPETUATION OF THE POSITION OF THE ORIGINAL CORNER.
 WITNESSES: S.50°45'E. 72.45' NAIL IN WCRC BRASS REFERENCE DISC ON NE SIDE OF UTILITY POLE (SUPRA)
 S.42°20'W. 58.24' CHISELED "X" ON SE RIM OF A GATE, VALVE, AND WELL
 S.51°94'W. 68.19' CENTER OF CORNER POST OF 4' HIGH CYCLONE FENCE TO WEST AND NORTH (SUPRA)
 N.21°41'W. 112.06' CENTER OF TOP BOLT OF FIRE HYDRANT (SUPRA)
 PLACED A REMONUMENTATION BRASS DISC AND PVC CAP #21586 ON ABOVE FOUND CONCRETE MONUMENT K-8.

Signed by Walter J. Zbikowski
 WALTER J. ZBIKOWSKI
 Surveyor's Michigan License No. 21586

Date Dec. 6, 1995

4/10

- L. 26750 P. 633 (COULD NOT READ DESCRIPTION OF CORNER) (1992) LCRC #1082
 - N.85°E. 69.40' NE CORNER CONCRETE HEADWALL (MEASURED 69.40')
 - S.35°E. 72.48' NAIL W/WASHER (WCRC BRASS REFERENCE DISC) ON NE SIDE OF UTILITY POLE (MEASURED 72.45')
 - S.45°W. 68.17' SE CORNER OF FENCE POST (MEASURED 68.19')
 - N.15°W. 111.86' TOP NUT OF FIRE HYDRANT (MEASURED 112.06')
 - L. 27814 P. 219 FOUND MONUMENT IN WELL (1994) LCRC #95002208
- SAME WITNESS AS L.26750 P. 633 ABOVE