

FEB 28 1994

RC 1153

COMMISSION

LAND CORNER RECORDATION CERTIFICATE
Filing Requirement of Act 74, Mich. P.A. 1970

LI 26992 PA 837

For corners in

Wayne (County) Located In: Corner Code --#
1. Public Land Survey T 2S R 10E G-13
2. Property Controlling in Section S T R
3. Miscellaneous Property in Sec. S T R
4. Lot No. , Recorded Plat
5. Private Claims

Compliance with ACT 345, P.A. 1990
APPROVED ON: 11-30-93
WAYNE COUNTY REMONUMENTATION PEER GROUP COMMITTEE

Register of Deeds Stamp & File Number

Lawrence R. Feindt, in a field survey on November 2, 1993, do hereby certify that under requirements of P.A. 74, Michigan P.A. of 1970, the corner points mentioned in lines 1 and 2 above were in conformance with regulations and rules therefore as required in the current manual of survey instructions of the United States Department of the Interior, Bureau of Land Management or by a decree of a Court of Law and/or that the corner points mentioned in lines 3, 4 and 5 above were in conformance with the rules of the Michigan Board of Land Surveyors or by a Decree of a Court of Law, established, re-established, monumented, re-monumented, recovered, found as expressed below.

NOTE: Not more than 4 corners, all in the same town and range, may be recorded on this certificate.

Grid table with columns A-M and rows 1-13. A circle is drawn around the intersection of column G and row 12.

A. Description of original monument and accessories and/or subsequent restoration:

G-13) South Corner Common to Sections 33 and 34, T 2 S, R 10 E

GENERAL LAND OFFICE SET POST FOR CORNER ELM 10"-N21 W-16 LINKS (10.56') ELM 12"-N50 E-54 LINKS (34.64') OCTOBER 16, 1816 BY: JOSEPH FLETCHER, DS
WAYNE COUNTY BUREAU OF TAXATION CROSS SET NE'LY -34.75'-M.H. COVER ENE'LY-47.50'-FIRE HYDRANT SW HOSE CONN. EAST -23.35'-CLOSING SECTION CORNER SSW'LY-39.70'-TEL. POLE NW'LY -53.60'-SE CORNER SIDEWALK
FOUND MONUMENT IN MON. BOX N60 E- 63.46'-MDSH TAG IN SE SIDE OF PP EAST - 23.41'-MONUMENT IN MON. BOX S60 E-105.46'-NORTH BOLT ON FIRE HYDRANT S45 W- 63.37'-MDSH TAG IN SE SIDE OF PP N35 W- 82.15'-CHISELED "+" IN NE SIDE OF PIZZA HUT SIGN POST
DECEMBER 22, 1980 BY: GRANT J. WARD, PS #22445 RECORDED IN LIBER 21061, PAGE 66, WCR

B. Description of corner evidence found and/or method applied in restoring or reestablishing corner:

G-13) South Corner Common to Sections 33 and 34, T 2 S, R 10 E

Found concrete monument in monument box. Distance to G-12 measured 2640.44' (WPA = 2639.98' and shown as 2639.66' on "Pardee's Monroe Blvd. Sub."). Corner was confirmed with irons found in "Pardee's Monroe Blvd. Sub." as recorded in Liber 47 of Plats, Page 56, Wayne County records, and "Dearborn Homes Subdivision No. 2" as recorded in Liber 41 of Plats, Page 38, Wayne County records.

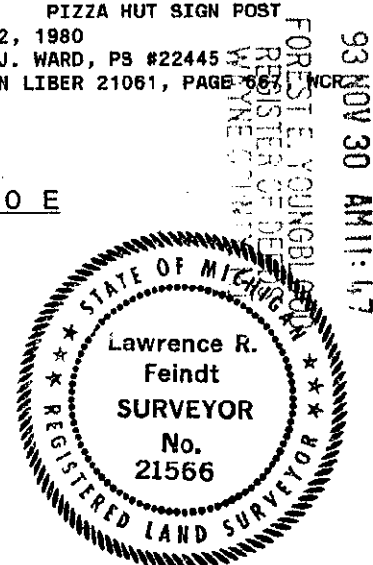

C. Description of monument for corner and accessories established to perpetuate locating the position of the corner:

G-13) South Corner Common to Sections 33 and 34, T 2 S, R 10 E

Found concrete monument in monument box and affixed Wayne County brass disk stamped with license #21566 on monument at the intersection of Van Born Road and Monroe Road. Corner is accepted as a careful and faithful reestablishment of the position of the original corner.
Witnesses: N58 E - 63.45' - Found MDSH tag and nail in SE face of utility pole
N58 E - 62.64' - Found PK nail in SE face of utility pole
S61 E - 105.10' - North bolt of fire hydrant flange
S28 W - 66.17' - Found PK nail in NW face of utility pole
N34 W - 82.21' - Found "+" cut in NE side of Pizza Hut sign (G. J. Ward, PS)
East - 23.39' - Found concrete monument in monument box at North corner common to Sections 3 and 4, T 3 S, R 10 E.

Signed by Lawrence R. Feindt Date November 29, 1993
Surveyor's Michigan License No. 21566