

RECORDED & INDEXED

FEB 28 1994

COMMISSION

RC 1154

LAND CORNER RECORDATION CERTIFICATE
Filing Requirement of Act 74, Mich. P.A. 1970

LI 26992 PA 838

For corners in

<u>Wayne</u> <small>(County)</small>	Located In:	Corner Code #
1. Public Land Survey	T <u>2S</u> R <u>10E</u>	<u>K-3</u>
	T _____ R _____	_____
	T _____ R _____	_____
	T _____ R _____	_____
2. Property Controlling in Section	S _____ T _____ R _____	_____
	S _____ T _____ R _____	_____
3. Miscellaneous Property in Sec.	S _____ T _____ R _____	_____
	S _____ T _____ R _____	_____

Compliance with
ACT 345, P.A. 1990

APPROVED ON: 11-30-93 *DPJ*
WAYNE COUNTY REMONUMENTATION
PEER GROUP COMMITTEE

Register of Deeds Stamp & File Number

4. Lot No. _____, Recorded Plat _____
5. Private Claims _____

I, Lawrence R. Feindt, in a field survey on November 5, 19 93, do hereby certify that under requirements of P.A. 74, Michigan P.A. of 1970, the corner points mentioned in lines 1 and 2 above were in conformance with regulations and rules therefore as required in the current manual of survey instructions of the United States Department of the Interior, Bureau of Land Management or by a decree of a Court of Law and/or that the corner points mentioned in lines 3, 4 and 5 above were in conformance with the rules of the Michigan Board of Land Surveyors or by a Decree of a Court of Law, established, re-established, monumented, re-monumented, recovered, found as expressed below:

NOTE: Not more than 4 corners, all in the same town and range, may be recorded on this certificate.

A	B	C	D	E	F	G	H	I	J	K	L	M
2	6	5	4	3	2	1						
3												
4	7	8	9	10	11	12						
5												
6	18	17	16	15	14	13						
7												
8	19	20	21	22	23	24						
9												
10	30	29	28	27	26	25						
11												
12	31	32	33	34	35	36						
13												

A. Description of original monument and accessories and/or subsequent restoration:

K-3) Corner Common to Sections 1, 2, 11 & 12, T 2 S, R 10 E

GENERAL LAND OFFICE
SET POST FOR CORNER
B. ASH 12"-N18°E-22 LINKS(14.52')
B. ASH 10"-S88°W-10 LINKS(6.66')
DECEMBER 18, 1816
BY: JOSEPH FLETCHER, DS

B. Description of corner evidence found and/or method applied in restoring or reestablishing corner:

K-3) Corner Common to Sections 1, 2, 11 & 12, T 2 S, R 10 E

Found monument box full of concrete at Warren Avenue and M-39 (Southfield Freeway). Established corner from irons found in "Frischkorn's Highlands" as recorded in Liber 41 of Plats, Page 14, Wayne County records, and "Easthaven Subdivision as recorded in Liber 47 of Plats, Page 1, Wayne County records. Also employed M.D.O.T. M-39 right-of-way monuments found on the North of Lot 32 and the South line of Lot 21 of "Frischkorn's Highlands". Corner location computed fell in existing monument box.

C. Description of monument for corner and accessories established to perpetuate locating the position of the corner:

K-3) Corner Common to Sections 1, 2, 11 & 12, T 2 S, R 10 E

Set "T"-iron 6" in length with Wayne County brass disk stamped with license #21566 in existing monument box in center line of Warren Avenue and approximately 60' West of the center line of the North bound service drive of M-39 (Southfield Freeway), is accepted as a careful and faithful reestablishment of the position of the original corner.

Witnesses: S56°E - 122.69' - Northwest corner of NBD bank building
S07°E - 38.33' - Northeast bolt of steel light pole
S70°W - 109.50' - Wayne County bench mark (brass disk) #99-10-92
N70°W - 115.80' - Southeast bolt of steel light pole
N05°E - 41.04' - Southeast bolt of steel light pole

93 NOV 30 AM 11:47
 FOREST E. YOUNGBLOOD
 REGISTER OF DEEDS
 WAYNE COUNTY, MI

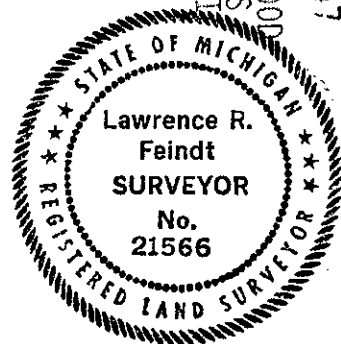

Signed by Lawrence R. Feindt Date November 29, 1993
 Surveyor's Michigan License No. 21566