

\$ 4.00 REMONUMENTATION

LAND CORNER RECORDATION CERTIFICATE 7.00 DEED

Filing Requirement of Act 74, Mich. P.A. 1970 DEC 95 2:08 P.M. RECEIPT# 44B

For corners in

WAYNE

(County)

Located in: GREENFIELD TWP (NOW CITY OF DETROIT) Corner Code # COMMON COR.

RECORDED FOREST E. YOUNGBLOOD, REGISTER OF DEEDS WAYNE COUNTY, MI

Compliance with ACT 345, P.A. 1990

APPROVED ON: DEC 5 1995 WAYNE COUNTY REMONUMENTATION PEER GROUP COMMITTEE

Register of Deeds Stamp & File Number

1. Public Land Survey

T 18 R 11E B-13

T 25 R 11E B-01

T R

T R

2. Property Controlling in Section

S T R

S T R

3. Miscellaneous Property in Sec.

S T R

S T R

4. Lot No. , Recorded Plat

5. Private Claims

Grid table with columns A-M and rows 2-13 containing numbers 1-36.

I, STEVEN E. DUNN, in a field survey on OCTOBER 8, 19 95, do hereby certify that under requirements of P.A. 74, Michigan P.A. of 1970, the corner points mentioned in lines 1 and 2 above were in conformance with regulations and rules therefore as required in the current manual of survey instructions of the United States Department of the Interior, Bureau of Land Management or by a decree of a Court of Law and/or that the corner points mentioned in lines 3, 4 and 5 above were in conformance with the rules of the Michigan Board of Land Surveyors or by a Decree of a Court of Law; established, re-established, monumented, re-monumented, recovered, found as expressed below:

NOTE: Not more than 4 corners, all in the same town and range, may be recorded on this certificate.

A. Description of original monument and accessories and/or subsequent restoration:

GLO POST - NO EVIDENCE OF ORIGINAL CORNER FOUND

GLO ORIGINAL SURVEY PERFORMED BY JOSEPH FLETCHER UNDER CONTRACT DATED SEPT., 1816

PLATS

- L. 19 P. 24 - "BEAUMER'S SUBDIVISION"
L. 46 P. 8 "FRISCHKORN'S WEST CHICAGO BOULEVARD SUB. NO. 1"
L. 46 P. 90 "OBENAUER-BARBER LANG ORCHARD BLVD. SUB."
L. 55 P. 29 "KARNATZ BONAPARTE SUBDIVISION"

- NOVEMBER 15, 1893
JULY 7, 1923
SEPTEMBER 19, 1923
JUNE 15, 1925

95263068

B. Description of corner evidence found and/or method applied in restoring or reestablishing corner:

B-13 T.18, R.11E. COMMON TO B-1 T.25, R.11E.

NO EVIDENCE OF CORNER FOUND. RE-ESTABLISHED CORNER USING STONE CURBS, FOUND IRONS, AND MONUMENTS WITH REFERENCE TO THE ABOVE LISTED PLATS. VERIFIED LOCATION WITH STONE CURBS, SIDEWALK SPLITS, AND A TIE TO AN ADJACENT SECTION CORNER.

FIELD MEASUREMENTS AND RECORDED DISTANCES

- B-13 TO A-13 2633.94' (M.) 2633.77' (R.) AS PER FRISCHKORN'S SUBDIVISION L. 46 P. 8 & L. 46 P. 11-12
B-13 TO C-13 2635.43' (M.)

PLACED WAYNE COUNTY REMONUMENTATION MARKER AND ALUMINUM CAP #28408 ON 1/2" x 18" IRON WITHIN A MONUMENT BOX.

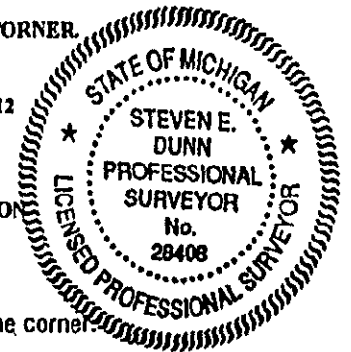

C. Description of monument for corner and accessories established to perpetuate locating the position of the corner: B-13 T.18, R.11E. WAYNE COUNTY REMONUMENTATION MARKER AND ALUMINUM CAP #28408 ON 1/2" x 18" IRON IN A MONUMENT BOX.

WITNESSES

- AZ. 315° 44.94' SET PK NAIL AND W.C.R. TAG IN NORTHEAST FACE OF UTILITY POLE
AZ. 153° 52.35' "X" IN THE "W" OF A WATER MAN HOLE
AZ. 215° 37.90' SET PK NAIL AND W.C.R. TAG IN CURB
AZ. 36° 68.30' CITY OF DETROIT CONTROL MONUMENT

THE SELECTED LOCATION FOR THIS PROPERTY CONTROLLING MONUMENT IS ACCEPTED AS A CAREFUL AND FAITHFUL DETERMINATION OF THE POSITION AS INDICATED.

Signed by Steven E. Dunn

Date DECEMBER 5, 1995

Surveyor's Michigan License No. 28408