

\$ 4.00 REMONUMENTATION
\$ 10.00 DEED

15 DEC 95 10:24 A.M. RECEIVED
REGISTERED
FOREST E. YOUNG, REGISTER
WAYNE COUNTY, MI

LAND CORNER RECORDATION CERTIFICATE
Filing Requirement of Act 74, Mich. P.A. 1970

For corners in

WAYNE
(County)

Located In:
City of Detroit

Corner Code #

#015

Protracted
Location

1. Public Land Survey

T 2S R 1E
T R
T R
T R
S T R
S T R
S T R
S T R

2. Property Controlling
in Section
3. Miscellaneous
Property in Sec.

LI 28660 PA 853
LIBER 28465 PAGE 740
Compliance with
ACT 345, P.A. 1990
APPROVED ONE: 12-11-95
WAYNE COUNTY REMONUMENTATION
REGISTER OF DEEDS STAMP & FILE NUMBER

4. Lot No. _____, Recorded Plat _____
5. Private Claims _____
Line Common to P.C. 22 and P.C. 27

Howard St., West of 10th Street

I, George M. Platz, in a field survey on December 8, 19 95, do hereby certify that under requirements of P.A. 74, Michigan P.A. of 1970, the corner points mentioned in lines 1 and 2 above were in conformance with regulations and rules therefore as required in the current manual of survey instructions of the United States Department of the Interior, Bureau of Land Management or by a decree of a Court of Law and /or that the corner points mentioned in lines 3, 4 and 5 above were in conformance with the rules of the Michigan Board of Land Surveyors or by a Decree of a Court of Law; established, re-established, monumented, re-monumented, recovered, found as expressed below:

NOTE: Not more that 4 corners, all in the same town and range, may be recorded on this certificate.

	A	B	C	D	E	F	G	H	I	J	K	L	M
2	6	5	4	3	2	1							
3													
4	7	8	9	10	11	12							
5													
6	16	17	18	15	14	13							
7													
8	19	20	21	22	23	24							
9													
10	30	29	28	27	26	25							
11													
12	31	32	33	34	35	36							
13													

City of Detroit

A. Description of original monument and accessories and/or subsequent restoration:
Line Common to P.C. 22 and P.C. 27

The line common to P.C. 22 and P.C. 27 were originally surveyed as two separate tracts of land, the first in the year 1810 and the second most likely in 1829 (see research dossier for sketch and notes). Posts were originally set at the corners only and no line stakes are called out. Many subdivisions have been platted adjacent to this line. The City of Detroit Survey Section has assembled and maintained their "Cartographic Maps" from record plat data and field work. These maps have been relied upon for a great number of years and are considered the best assembled collection of written evidence available. To the best of my knowledge, there has never been any subsequent restoration of this line, excepting the plats which were done long ago.

B. Description of corner evidence found and/or method applied in restoring or reestablishing corner:
Line Common to P.C. 22 and P.C. 27

A complete analysis of this line from its southern beginnings at the Detroit River to its northern terminus has been field measured by Spalding DeDecker & Associates, locating building lines, street lines, and alley lines at various positions (see research dossier). It is my conclusion that a few deflections/line orientation changes occur on this line. At this time, I do not have a final answer for the ENTIRE line. The portion of this line between Lafayette Ave. and Michigan Ave. has been determined. The specific points held as good and their relationships with other field measured points are labeled in the research dossier.

C. Description of monument for corner and accessories established to perpetuate locating the position of the corner:
Line Common to P.C. 22 and P.C. 27 -- See sketch on the back of this sheet.

(C) Set 4"x 36" Concrete Monument w/Aluminum Disk stamped "WAYNE COUNTY REMONUMENTATION, SPALDING-DEDECKER, PS 38121" in a Monument Box Located in the approximate centerline of Howard Street, +/- 300' West of the centerline of Tenth Street. The location of this property controlling monument is accepted as a careful and faithful determination of this private claim line based upon all known evidence.

- Az. 45° 52.01'; Set P.K. Nail w/WCR Tag in Concrete Light Pole Base
- Az. 125° 61.89'; Set P.K. Nail w/WCR Tag in SW Face of Utility Pole
- Az. 228° 67.30'; Chiseled "+" in Top Nut of Fire Hydrant
- Az. 287° 103.42'; SW Brick Corner of Building #1660 Howard St.

Signed by George M. Platz Date 12-11-95
Surveyor's Michigan License No. 38121

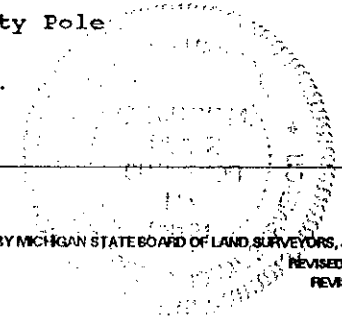

FORM APPROVED BY MICHIGAN STATE BOARD OF LAND SURVEYORS, JAN. 28, 1971
REVISED MAY 14, 1976
REVISED JAN., 1993

Re-RECORDED TO CORRECT RANGE

96071329
95268778

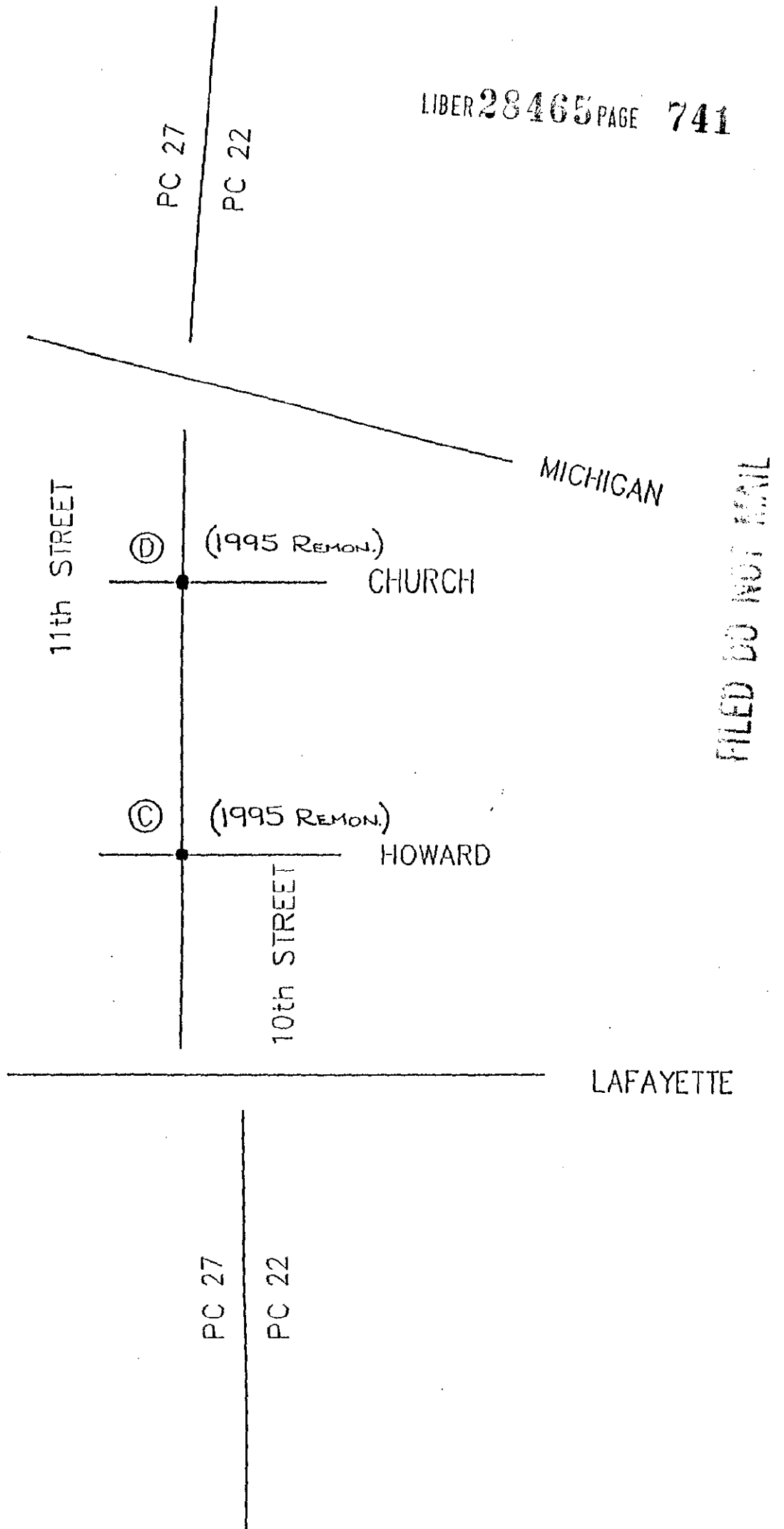

NO SCALE

FILED DO NOT MAIL