

RECORDED

LAND CORNER RECORDATION CERTIFICATE  
Filing Requirement of Act 74, Mich. P.A. 1970

\$ 4.00 REMONUMENTATION

\$ 10.00 DEED

15 DEC 95 10:24 A.M. RECEI

RECORDED

FOREST E. YOUNGLOOD, REGISTER  
WAYNE COUNTY, MI

For corners in

WAYNE

(County)

Located In:

City of Detroit

Corner Code #

#016

1. Public Land Survey

T 2S R 12E

Protracted

Location

2. Property Controlling in Section

S T R

3. Miscellaneous

S T R

Property in Sec.

S T R

4. Lot No. , Recorded Plat

5. Private Claims Line Common to P.C. 22 and P.C. 27

Church St., East of 11th St.

I, George M. Platz, in a field survey on December 8, 19 95,

do hereby certify that under requirements of P.A. 74, Michigan P.A. of 1970, the corner points mentioned in lines 1 and 2 above were in conformance with regulations and rules therefore as required in the current manual of survey instructions of the United States Department of the Interior, Bureau of Land Management or by a decree of a Court of Law and /or that the corner points mentioned in lines 3, 4 and 5 above were in conformance with the rules of the Michigan Board of Land Surveyors or by a Decree of a Court of Law; established, re-established, monumented, re-monumented, recovered, found as expressed below:

NOTE: Not more than 4 corners, all in the same town and range, may be recorded on this certificate.

A. Description of original monument and accessories and/or subsequent restoration:  
Line Common to P.C. 22 and P.C. 27

The line common to P.C. 22 and P.C. 27 were originally surveyed as two separate tracts of land, the first in the year 1810 and the second most likely in 1829 (see research dossier for sketch and notes). Posts were originally set at the corners only and no line stakes are called out. Many subdivisions have been platted adjacent to this line. The City of Detroit Survey Section has assembled and maintained their "Cartographic Maps" from record plat data and field work. These maps have been relied upon for a great number of years and are considered the best assembled collection of written evidence available. To the best of my knowledge, there has never been any subsequent restoration of this line, excepting the plats which were done long ago.

B. Description of corner evidence found and/or method applied in restoring or reestablishing corner:  
Line Common to P.C. 22 and P.C. 27

A complete analysis of this line from its southern beginnings at the Detroit River to its northern terminus has been field measured by Spalding DeDecker & Associates, locating building lines, street lines, and alley lines at various positions (see research dossier). It is my conclusion that a few deflections/line orientation changes occur on this line. At this time, I do not have a final answer for the ENTIRE line. The portion of this line between Lafayette Ave. and Michigan Ave. has been determined. The specific points held as good and their relationships with other field measured points are labeled in the research dossier.

C. Description of monument for corner and accessories established to perpetuate locating the position of the corner:  
Line Common to P.C. 22 and P.C. 27 -- See sketch on the back of this sheet.

(D) Set 4"x 36" Concrete Monument w/Aluminum Disk stamped "WAYNE COUNTY REMONUMENTATION, SPALDING-DEDECKER, PS 38121" in a Monument Box Located in the approximate centerline of Church Street, +/- 366' East of the centerline of Eleventh Street. The location of this property controlling monument is accepted as a careful and faithful determination of this private claim line based upon all known evidence.

- Az. 43° 44.46'; Set P.K. Nail w/WCR Tag in SE Face of Light Pole
- Az. 90° 76.08'; NW Brick Corner of Building located on the SE Corner of 10th & Church
- Az. 115° 38.96'; Set P.K. Nail w/WCR Tag in SW Face of Utility Pole
- Az. 238° 88.84'; Set P.K. Nail w/WCR Tag in N. Face of 24" Tree
- Az. 293° 27.36'; Set P.K. Nail w/WCR Tag in SW Face of 36" Tree

Signed by George M. Platz Date 12-11-95

Surveyor's Michigan License No. 38121

Re-RECORDED TO CORRECT RANGE DPJ

Spalding - DeDecker & Assoc. SM94-44 & SM95-28

LIBER 28465 PAGE 1742  
1128660 PA 855

Compliance with ACT 345, P.A. 1990  
APPROVED ON: 12-11-95 DPJ  
WAYNE COUNTY REMONUMENTATION  
REGISTER OF DEEDS STAMP & FILE NUMBER

	A	B	C	D	E	F	G	H	I	J	K	L	M
2	6	5	4	3	2	1							
3													
4	7	8	9	10	11	12							
5													
6	18	17	16	15	14	13							
7													
8	19	20	21	22	23	24							
9													
10	30	29	28	27	26	25							
11													
12	31	32	33	34	35	36							
13													

City of Detroit

950011330 95268779

LI 28660 PA 856

LIBER 28465 PAGE 743

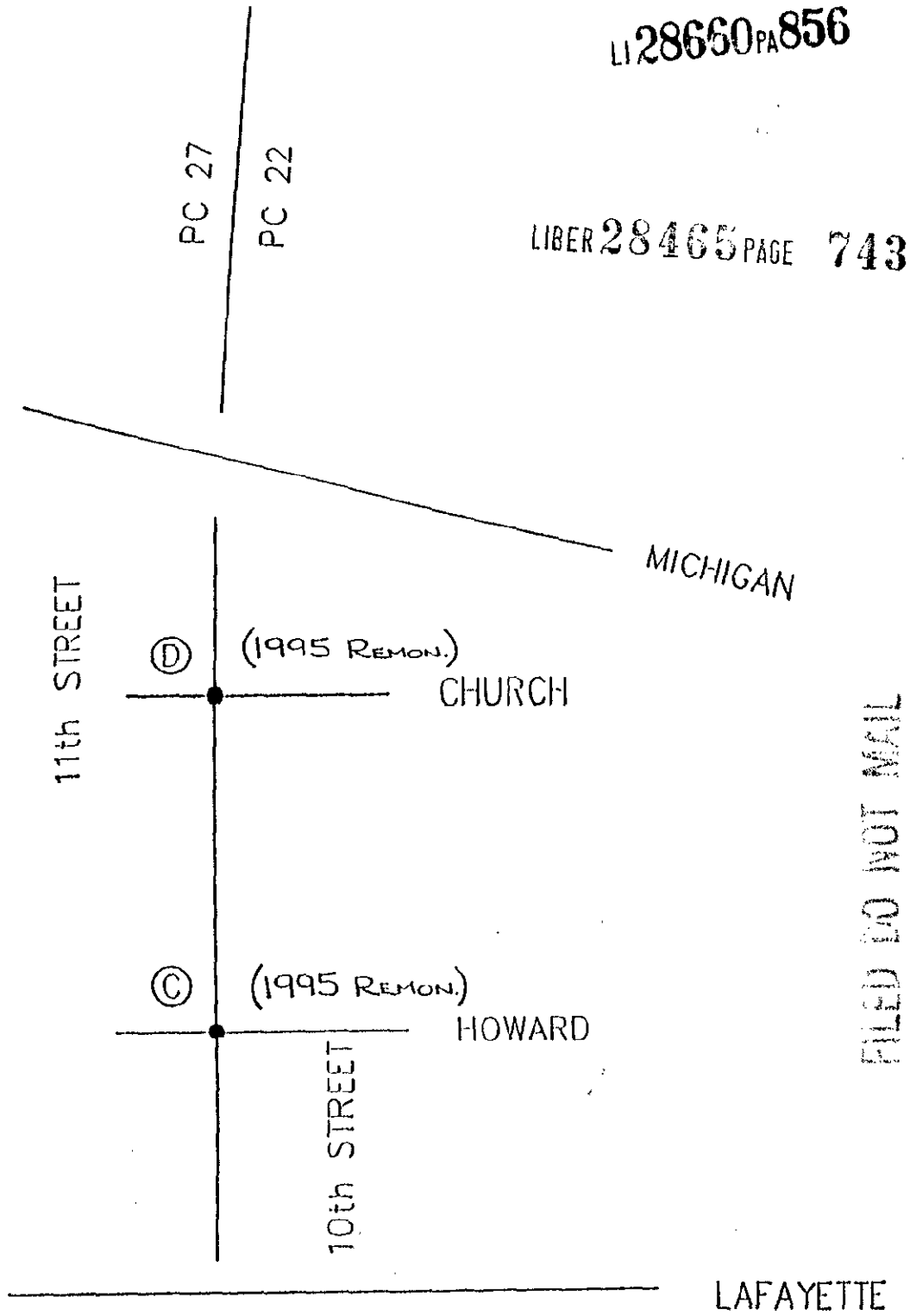

FILED DO NOT MAIL



NO SCALE