

FEB 28 2000

FILE DO NOT MAIL

LAND CORNER RECORDATION CERTIFICATE
Filing Requirement of Act 74, Mich. P.A. 1970

SECTION

For corners in
Wayne, Van Buren Twp.
(County)

Located In:	Corner Code #
T 3S. R 8E.	J-9
T R	
T R	
T R	
S T R	
S T R	
S T R	
S T R	

Liber-30845 Page-19
99592665 12/28/1999
F.E. Youngblood, Wayne Co. Register of Deeds

Compliance with
ACT 345, P.A. 1990
APPROVED ON: DEC. 9, 1999
WAYNE COUNTY REMONUMENTATION
PEER GROUP COMMITTEE
Register of Deeds Stamp & File Number

- 1. Public Land Survey
- 2. Property Controlling in Section
- 3. Miscellaneous Property in Sec.

- 4. Lot No. _____, Recorded Plat _____
- 5. Private Claims _____

I, William L. Roskelly, in a field survey on Nov 9, 1999, do hereby state that under requirements of P.A. 74, Michigan P.A. of 1970, the corner points mentioned in lines 1 and 2 above were in conformance with regulations and rules therefore as required in the current manual of survey instructions of the United States Department of the Interior, Bureau of Land Management or by a decree of a Court of Law and/or that the corner points mentioned in lines 3, 4 and 5 above were in conformance with the rules of the Michigan Board of Land Surveyors or by a Decree of a Court of Law; established, re-established, monumented, recovered, found as expressed below:

NOTE: Not more than 2 corners, all in the same town and range, may be recorded on this certificate.

	A	B	C	D	E	F	G	H	I	J	K	L	M
1													
2	6		5		4		3		2		1		
3													
4	7		8		9		10		11		12		
5													
6	18		17		16		15		14		13		
7													
8	19		20		21		22		23		24		
9													
10	30		29		28		27		26		25		
11													
12	31		32		33		34		35		36		
13													

A. Description of original monument and accessories and/or subsequent restoration:

J-9) North corner section 26, T.3 S., R.8 E., Van Buren Township
G.L.O. (1830's) J Wampler set corner post, no witnesses.
W.P.A. (1930's) iron, witnesses: N 24.78' iron post (meas. N11@01'21"E, 25.25'), SE 14.61' F. post (meas. S.83@10'45"E 14.56'), SE 26.93' 12" Elm (gone), NW 22.04' 12" Elm (gone).

B. Description of corner evidence found and/or method applied in restoring or reestablishing corner:

J-9) North corner section 26, T.3 S., R.8 E., Van Buren Township
Found an iron pipe 1' below natural ground (in woods).
Verified corner location by comparing W.P.A. data with field measurements:
J-9 to I-9 Record = 2760.63' Measured = 2760.94' J-9 to K-9 Record = 2942.18 Measured = 2942.37'
Angle line J-9 & I-9 to J-9 & K-9 Record = 178 @-41'-50" Measured = 178 @-41'-26"
WPA 1930's N 24.78' iron post (meas. N11@01'21"E, 25.25'), SE 14.61' downed wood fence post (meas. S.83@10'45"E 14.56')

C. Description of monument for corner and accessories established to perpetuate locating the position of the corner:

J-9) North corner section 26, T.3 S., R.8 E., Van Buren Township
Set monument (in woods).
The selected location is accepted by the contractor and is generally accepted by professional surveyors as the best available evidence of the position of the corner. WITNESSES: Found PK nail top 4" steel post N11@01'21"E, 25.25', Set nail WCR tag SE face 18" Maple N.29@47'19" E. 22.50', Found downed wood fence post S.83@10' 45" E. 14.56', Set nail and WCR tag SW face 12" twin Ash S.27@25' 57" E. 27.83', Set steel bar cap #10705 S.09@09' 22"W. 19.92', Set nail WCR tag SE face 12" Maple S.54@01' 41" W 17.37', Set nail WCR tag S face 36" Oak N.83@02'26" W 49.99', Set nail WCR tag S face 12" Cherry N.76@38' 57" W 20.29'
Set nail and Wayne County Remonumentation tag and B&S #10705 in iron pipe.

Signed by William L. Roskelly
Surveyor's Michigan License No. 10705

Date 12-28-99

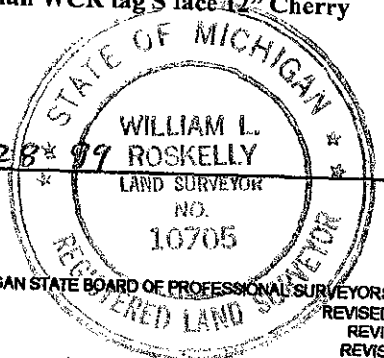

R LCR 9 42 189 A. DP