

\$ 10.00 DEED
 30 DEC 96 1:49 P.M. RECEIPT# 488
 RECORDED
 FOREST E. YOUNGBLOOD, REGISTER OF DEEDS
 WAYNE COUNTY, MI

LAND CORNER RECORDATION CERTIFICATE
 Filing Requirement of Act 74, Mich. P.A. 1970

\$ 4.00 REMONUMENTATION

LI29857PA630

Compliance with
 ACT 345, P.A. 1990

APPROVED ON: 12-30-96
 WAYNE COUNTY REMONUMENTATION
 PEER GROUP COMMITTEE

Register of Deeds Stamp & File Number

For corners in

<u>Wayne, Van Buren Twp.</u> (County)	Located in:	Corner Code #
1. Public Land Survey	T <u>3S.</u> R <u>8E.</u>	<u>K-5</u>
	T <u> </u> R <u> </u>	<u> </u>
	T <u> </u> R <u> </u>	<u> </u>
	T <u> </u> R <u> </u>	<u> </u>
2. Property Controlling in Section	S <u> </u> T <u> </u> R <u> </u>	<u> </u>
	S <u> </u> T <u> </u> R <u> </u>	<u> </u>
3. Miscellaneous Property in Sec.	S <u> </u> T <u> </u> R <u> </u>	<u> </u>
	S <u> </u> T <u> </u> R <u> </u>	<u> </u>

4. Lot No. _____, Recorded Plat _____
 5. Private Claims _____

I, William L. Roskelly, in a field survey on Dec 12, 1996 do hereby state that under requirements of P.A. 74, Michigan P.A. of 1970, the corner points mentioned in lines 1 and 2 above were in conformance with regulations and rules therefore as required in the current manual of survey instructions of the United States Department of the Interior, Bureau of Land Management or by a decree of a Court of Law and /or that the corner points mentioned in lines 3, 4 and 5 above were in conformance with the rules of the Michigan Board of Land Surveyors or by a Decree of a Court of Law; established, re-established, monumented, recovered, found as expressed below:

NOTE: Not more than 2 corners, all in the same town and range, may be recorded on this certificate.

A	B	C	D	E	F	G	H	I	J	K	L	P
1												
2	6		5		4		3		2		1	
3												
4	7		8		9		10		11		12	
5												
6	18		17		16		15		14		13	
7												
8	19		20		21		22		23		24	
9												
10	30		29		28		27		26		25	
11												
12	31		32		33		34		35		36	
13												

A. Description of original monument and accessories and/or subsequent restoration:

K-5) Southeast corner section 11, T.3 S., R.8 E., Van Buren Township
 G.L.O. (1830's) J. Wampler set corner post, witnesses: WO 28S 56W10 (gone), Do 36S 82E 28 (gone) W.P.A. 4/17/46 found a stone, witnesses: S.W. 83.73' nail in 12" Maple (gone), S.W. 98.28' N.E. corner "Tyler St. Command" bldg. (gone), S.W. 58.20' 12" Maple (gone), N.W. 53.63' Tel. pole (gone), N.W. 52.83' Tel. pole (gone) 4/24/70 E. Johns W.C.R.C. found a monument, witnesses: NE 14.58' nail in guard post (gone), NE 13.12 nail in guard post (gone), SE 21.27' nail in guard post (gone), SW 58.23' nail in a 15" Maple (gone), SW 83.22' nail in a 15" Maple (gone), NW 57.33' M.B.T. pole (gone), NW 39.37' fence post (gone), NW 52.88' M.B.T. pole (gone). 3/22/72 CS #125 L.18022, P. 44 William Carlson found a 1/2" iron bar in a mon box, witnesses: N67°W 57.38' to RR spike in Bell pole(gone). N57E 26.45' to P.K. nail in N. post of guard rail, (Over)

B. Description of corner evidence found and/or method applied in restoring or reestablishing corner:

K-5) Southeast corner section 11, T.3 S., R.8 E., Van Buren Township
 Found an iron pipe in a concrete monument in a mon. box at Haggerty and Tyler roads (pavement).
 Verified the corner location by comparing field measurements with W.P.A. survey:
 Distance K-5 to L-5 Record = 2765.88', Measured = 2765.03'
 Distance K-5 to K-6 Record = 2692.31', Measured = 2692.73'
 Angle line K-5 & L-5 to K-5 & K-6 Record = 87° 29' 55", Measured = 87° 14' 22"
 RC 938 L. 24088, P.238 Gregory Stephens witness S45°W R=98.42' M=98.40' to northeast corner of brick house #41405 above brick ledge

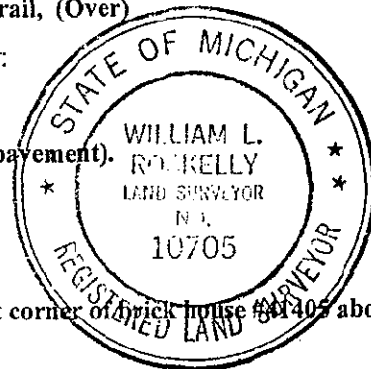

C. Description of monument for corner and accessories established to perpetuate locating the position of the corner:

K-5) Southeast corner section 11, T.3 S., R.8 E., Van Buren Township
 Found an iron pipe in a concrete monument in a mon. box at Haggerty and Tyler roads (pavement).
 The selected location is accepted by the contractor and is generally accepted by professional surveyors as the best available evidence of the position of the corner.
 WITNESSES: N. 18° E. 136.70' found P.K. nail S.E. face MBT pole, N. 49° E. 64.98' found P.K. nail N.W. face guy pole, N. 49° E. 64.30' set WCR tag N.W. face guy pole, S. 40° E. 81.90' found P.K. nail N.W. face power pole, S. 40° E. 80.77' set WCR tag NW face power pole, S. 48° W. 65.34' set WCR tag N.W. face power pole, S. 48° W. 67.11' found a P.K. nail N.W. face power pole, S. 52° W. 98.40' N.E. corner house #41405, N745° W. 76.55' set WCR tag S.W. face power pole, N. 45° W. 77.81' found P.K. nail S.W. face power pole. Placed Wayne County Remonumentation brass marker and cap #10705.

Signed by William L. Roskelly
 Surveyor's Michigan License No. 10705

Date 12-30-96

K-5) Southeast corner section 11, T.3 S., R.8 E., Van Buren Township (Continued)

S.44° E. 31.46' to P.K. nail in guard rail (gone).

10/30/72 RC 171 L. 18290 P. 197 Edward O'Rourke found a monument in a mon box, witnesses:

N.60° W. 57.66' P.K. nail S. face of utility pole (gone), S.60° W. 83.14' P.K. nail in S.E. face of 12" tree (gone).

5/12/88 RC 938 L. 24088, P.238 Gregory Stephens found a 1/2" pipe in mon. box, witnesses: N23°E 136.70' to P.K. in SE face MBT pole (gone), N55°W 57.72' to double headed nail SW face Det. Edison pole (gone), S65°W 83.18' to nail in N face 18" Maple (gone), S45°W 98.42' to northeast corner of brick house #41405 above brick ledge (M=98.40'), S25°W 116.35' to P.K. in east face of 30" Maple (gone)