

SURVEY &
REMONUMENTATION

RC 1447

LAND CORNER RECORDATION CERTIFICATE

LI27794PA320

APR 25 1995

Filing Requirement of Act 74, Mich. P.A. 1970

E-13 Page 1

For ~~County~~ **COMMISSION**
Wayne

Located In: Romulus Corner Code

County

- | | | | |
|---------------------------------------|--------------|--------------|---------|
| 1. Public Land Survey | T <u>3</u> S | R <u>9</u> E | E-13 |
| | T _____ | R _____ | _____ |
| | T _____ | R _____ | _____ |
| | T _____ | R _____ | _____ |
| 2. Property Controlling In Section | S _____ | T _____ | R _____ |
| | S _____ | T _____ | R _____ |
| 3. Miscellaneous Property in Sec. | S _____ | T _____ | R _____ |
| | S _____ | T _____ | R _____ |
| 4. Lot No. _____, Recorded Plat _____ | | | |
| 5. Private Claims _____ | | | |

Compliance with
ACT 345, P.A. 1990

APPROVED ON: 12/9/94 TCB
WAYNE COUNTY REMONUMENTATION
PEER GROUP COMMITTEE

Register of Deeds Stamp and File Number

	A	B	C	D	E	F	G	H	I	J	K	L	I
2	6		5		4		3		2		1		
3													
4	7		8		9		10		11		12		
5													
6	18		17		16		15		14		13		
7													
8	19		20		21		22		23		24		
9													
10	30		29		28		27		26		25		
11													
12	31		32		33		34		35		36		
13													

I, Kenneth S. Wilkerson in a field survey on 11/04/1994
do hereby certify that under requirements of P.A. 74, Michigan P.A. of 1970, the corner points mentioned in lines 1 and 2 above were in conformance with regulations and rules therefore as required in the current manual of survey instructions of the United States Department of the Interior, Bureau of Land Management, or by a decree of a Court of Law and/or that the corner points mentioned in lines 3, 4 and 5 above were in conformance with the rules of the Michigan Board of Land Surveyors or by a Decree of a Court of Law, established, re-established, monumented, re-monumented, recovered, found as expressed below.

NOTE: Not more than 4 corners, all in the same town and range, may be recorded on this certificate.

A. Description of original monument and accessories and/or subsequent restorations:

01/01/1816 G.L.O. Set post
12" W. OAK N 25 E 43 LINKS (28.38') (GONE)
16" W. OAK N 43 W 57 LINKS (37.62') (GONE)

(Witnesses Continued on Back ...)

B. Description of corner evidence found and/or method applied in restoring or reestablishing corner:

Fd. 1/2" iron rod in mon. box (no lid) in conc. pv't. @ int. of cl Pennsylvania & extded cl Wahrman. Dist. to D-13 = 2626.93' (R), 2626.93' (M) & Dist. to F-13 = 2645.10 (R), 2645.21' (M)

C. Description of monument for corner and accessories established to perpetuate localing the position of the corner:

11/04/1994 Wilkerson 21584 O.H.M. Remon
SET W.C.R. WASHER AND CAP OVER CORNER.
CORNOR IS NOT COMMON W/ HURON THROUGH USAGE
6 FD. IRON IN MON. BOX (N.E. COR. SEC. 5, HURON TWP.) E. 23.75'
13 TOP BOLT ON HYDRANT S 40 W 77.74'
14 W.C.R. TAG S/S P.P. N 30 W 60.60'
15 "X" SCRIBED ON CONC. R/W MARKER N75E 75.40'
16 W.C.R. TAG E/S P.P. S 45 W 57.75'
20 ANGLE TO R. B.S. D-13 F.S. F-13 = 180-29'11"

\$ 16.00 MISCELLANEOUS RECORDING
DEC 94 11:11 AM REGISTERED 93A
REGISTERED
REGISTER OF DEEDS

We conclude that after careful study of the record documentation and field observations, that this corner is accepted as the best available evidence of the position of the original corner.

Signed by [Signature]
Drafted by Kenneth S. Wilkerson
Surveyor's Michigan License No. 21584

Date Dec 21 1994

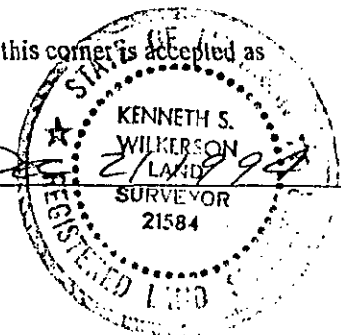

Orchard, Hiltz and McCliment, Inc. 34935 Schoolcraft Road Livonia, MI 48150

^ (Continued) Description of original monument and accessories and/or subsequent restorations:

01/01/1930 B/T Fd. iron

- 1 15" WALNUT NE 62.93' (GONE)
- 2 30" OAK SE 58.25' (GONE)
- 3 8" WALNUT SW 93.03' (GONE)
- 4 20" MAPLE NW 39.85' (GONE)
- 5 CROSS IN W.C.R. SIGN POST NW 41.65' (GONE)
- 18 DIST = 2626.93' TO D-13
- 19 DIST = 2645.10' TO F-13
- 20 ANGLE TO R. B.S. D-13 = 180-28'50"

LI27794PA321

03/01/1965 Stubits M.D.O.T.

Fd. 1/2" iron rod in mon. box

- 6 IRON IN MON. BOX EAST 23.87'
- 7 ROAD SIGN POST N 35 W 46.19' (GONE)
- 8 ED. POLE N 50 E 45.83' (GONE)
- 9 2" STEEL PIPE (GAS) N 25 W 51.65' (GONE)
- 10 HUB BETWEEN STOP SIGN POSTS S 20 E 63.68' (GONE)
- 18 DIST. TO D-13 = 2626.86'

01/01/1967 Det. Ed.

Fd. iron in mon. box

- 6 NE COR. SEC. 5 HURON TWP. EAST 23.85'
- 11 TEL POST NW 58.51' (GONE)

04/28/1970 W.C.R.C.

Witness Fd. iron

- 6 NE COR. SEC. 5 HURON TWP. EAST 23.85'
- 8 ED. POLE NE 45.84' (GONE)
- 12 "+" IN HEADWALL SE 64.87' (GONE)
- 13 CENTERLINE TOP OF HYDRANT SW 77.74'