

**SURVEY &
REMONUMENTATION**

RC 1448

APR 25 1995

LAND CORNER RECORDATION CERTIFICATE **L127794PA322**
Filing Requirement of Act 74, Mich. P.A. 1970

G-05 Page 1

COMMISSION

For corners in

Wayne

Located in: Romulus Corner Code

County

- | | | |
|---------------------------------------|----------------------------------|-------------|
| 1. Public Land Survey | T <u>3</u> S <u>R</u> <u>9</u> E | <u>G-05</u> |
| | T _____ R _____ | _____ |
| | T _____ R _____ | _____ |
| | T _____ R _____ | _____ |
| 2. Property Controlling In Section | S _____ T _____ R _____ | _____ |
| | S _____ T _____ R _____ | _____ |
| 3. Miscellaneous Property in Sec. | S _____ T _____ R _____ | _____ |
| | S _____ T _____ R _____ | _____ |
| 4. Lot No. _____, Recorded Plat _____ | | |
| 5. Private Claims _____ | | |

Compliance with
ACT 345, P.A. 1990

APPROVED ON: 12/9/94 TCD.
WAYNE COUNTY REMONUMENTATION
PEER GROUP COMMITTEE

Register of Deeds Stamp and File Number

| | A | B | C | D | E | F | G | H | I | J | K | L | M |
|----|----|---|----|---|----|---|----|---|----|---|----|---|---|
| 2 | 6 | | 5 | | 4 | | 3 | | 2 | | 1 | | |
| 3 | | | | | | | | | | | | | |
| 4 | 7 | | 8 | | 9 | | 10 | | 11 | | 12 | | |
| 5 | | | | | | | ⊕ | | | | | | |
| 6 | 18 | | 17 | | 16 | | 15 | | 14 | | 13 | | |
| 7 | | | | | | | | | | | | | |
| 8 | 19 | | 20 | | 21 | | 22 | | 23 | | 24 | | |
| 9 | | | | | | | | | | | | | |
| 10 | 30 | | 29 | | 28 | | 27 | | 26 | | 25 | | |
| 11 | | | | | | | | | | | | | |
| 12 | 31 | | 32 | | 33 | | 34 | | 35 | | 36 | | |
| 13 | | | | | | | | | | | | | |

I, Kenneth S. Wilkerson in a field survey on 11/04/1994
do hereby certify that under requirements of P.A. 74, Michigan P.A. of 1970, the corner points mentioned in lines 1 and 2 above were in conformance with regulations and rules therefore as required in the current manual of survey instructions of the United States Department of the Interior, Bureau of Land Management, or by a decree of a Court of Law and/or that the corner points mentioned in lines 3, 4 and 5 above were in conformance with the rules of the Michigan Board of Land Surveyors or by a Decree of a Court of Law, established, re-established, monumented, re-monumented, recovered, found as expressed below.

NOTE: Not more than 4 corners, all in the same town and range, may be recorded on this certificate.

A. Description of original monument and accessories and/or subsequent restorations:

01/01/1816 G.L.O. Set post
12" B. ASH N 66 E 24 LINKS (15.84') (GONE)
10" B. OAK S 54 W 9 LINKS (5.94') (GONE)

(Witnesses Continued on Back ...)

B. Description of corner evidence found and/or method applied in restoring or reestablishing corner:

Fd. 1/2" iron rod in conc. mon. in mon. box w/cover in conc. pvm't @ cl of Wick Rd. Dist to F-05 = 2635.58' (R), 2635.58' (M) & Dist. to H-05 = 2593.48' (R), 2594.55' (M)

C. Description of monument for corner and accessories established to perpetuate locating the position of the corner:

11/04/1994 Wilkerson 21584 O.H.M. Remon
SET W.C.R. WASHER & CAP OVER CORNER
6 W.C.R. TAG W/S P.P. S 2 W 48.41'
11 W.C.R. TAG S.W/S P.P. N 52 W 137.08'
12 W.C.R. TAG N./S P.P. S 83 W 121.75'
13 W.C.R. TAG S.W. SIDE 18" MAPLE N 33 W 124.74'
15 DIST. TO F-05 = 2635.58'
16 DIST. TO H-05 = 2594.55'

16.00 MISCELLANEOUS RECORDING
21 DEC 94 3:41 P.M. REGISTER 93A
REGISTERED
OFFICE OF REGISTER OF DEEDS

We conclude that after careful study of the record documentation and field observations, that this corner is accepted as the best available evidence of the position of the original corner.

Signed by [Signature]
Drafted by Kenneth S. Wilkerson
Surveyor's Michigan License No. 21584

Date 12/9/94

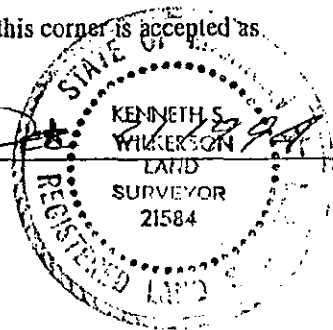

Orchard, Hiltz and McCliment, Inc. 34935 Schoolcraft Road Livonia, MI 48150

2 R
14-N-MIS

A (Continued) Description of original monument and accessories and/or subsequent restorations:

| | | | | |
|------------|---|---------------|---------------------------------|---------------------------|
| 01/01/1930 | W.C.R.C. | | Fd. stone | |
| 1 | 18" TWIN MAPLE NE 76.47'(GONE) | | | |
| 2 | FENCE POST SE 24.33' (GONE) | | | |
| 3 | IRON SOUTH 2.60' | | | |
| 4 | TEL POLE NW 63.50' | | | |
| 5 | 30" MAPLE NW 62.02' | | | |
| 14 | DIST. TO G-06 = 2670.51' | | | |
| 15 | DIST = 2636.18' TO G-06 | | | |
| 16 | DIST = 2593.48 TO H-05 | | | |
| 01/01/1965 | D.E. WITNESS CARDS | | NO DESCRIPTION OF MON. GIVEN | |
| 14 | DIST. TO G-06 = 2670.09', 2670.09', & 2669.86' | | | |
| 15 | DIST. TO F-05 = 2635.58' | | | |
| 17 | DIST. TO H-05 = 2594.13' | | | |
| 05/01/1967 | Zuhlke | M.D.O.T. | Fd. 3/4" iron pipe | |
| 6 | P.P. SOUTH 51.03' | | | |
| 7 | M.B.T. POLE N 75 W 65.20' | | | |
| 8 | 15" MAPLE N 35 W 124.31' | | | |
| 04/01/1970 | Qwiggins | M.D.O.T. | Fd. chis "X" on stone & set | |
| 6 | P.P. S 03 W 50.98' | | | |
| 7 | M.B.T. POLE N 70 W 64.69' (GONE) | | | |
| 9 | 1/2" PIPE-PROP. COR. N 05 E 32.94' | | | |
| 01/03/1973 | Jones | 2934 M.D.O.T. | R.C.2 | Fd. chiseled "X" on stone |
| 6 | P.P. S 3 W 50.98' | | | |
| 7 | TEL POLE N 70 W 64.69' | | | |
| 9 | 1/2" PIPE-PROP. COR. N 05 E 32.94' | | | |
| 10 | CHECKED DIST TO N 1/4 COR OF 16 & N 1/4 OF SEC 15 | | | |

L127794PA323