

SURVEY & REMONUMENTATION

APR 05 1996

LAND CORNER RECORDATION CERTIFICATE
 Filing Requirement of Act 74, Mich. P.A. 1970

\$ 4.00 REMONUMENTATION
 \$ 7.00 DEED
 7 DEC 95 11:02 A.M. RECEIPT
 RECORDED
 FOREST E. YOUNG, REGISTER
 WAYNE COUNTY, MI

For corners in **COMMISSION**

WAYNE (County) Located in: **CITY OF TAYLOR (TOWNSHIP OF TAYLOR #14)** Corner Code #

1. Public Land Survey		T3S	R10E	I-8
		T	R	
		T	R	
		T	R	
2. Property Controlling in Section	S	T	R	
	S	T	R	
3. Miscellaneous Property in Sec.	S	T	R	
	S	T	R	
4. Lot No. _____				Recorded Plat _____
5. Private Claims _____				

LIBER 28448 PAGE 888
 Compliance with ACT 345, P.A. 1990
 APPROVED ON: 12-4-95
 WAYNE COUNTY REMONUMENTATION PEER GROUP COMMITTEE
 Register of Deeds Stamp & File Number

I, **WALTER J. ZBIKOWSKI**, in a field survey on **OCTOBER 16, 1995**, do hereby certify that under requirements of P.A. 75, Michigan P.A. of 1970, the corner points mentioned in lines 1 and 2 above were in conformance with regulations and rules therefore as required in the current manual of survey instructions of the United States Department of the Interior, Bureau of Land Management or by a decree of a Court of Law and/or that the corner points mentioned in lines 3, 4 and 5 above were in conformance with the rules of the Michigan Board of Land Surveyors or by a Decree of a Court of Law; established, re-established, monumented, re-monumented, recovered, found as expressed below.

A	B	C	D	E	F	G	H	I	J	K	L	M
2	6		5		4		3		2		1	
3												
4	7		8		9		10		11		12	
5												
6	16		17		18		15		14		13	
7												
8	19		20		21		22		23		24	
9												
10	30		28		28		27		26		25	
11												
12	31		32		33		34		35		36	
13												

NOTE: Not more than 4 corners, all in the same town and range, may be recorded on this certificate.

A. Description of original monument and accessories and/or subsequent restoration.
ORIGINAL GOVERNMENT SURVEY BY JOSEPH FLETCHER, D.S. (1815-1817)
 G.L.O. (1816) 1/4 SEC COR (DESCRIPTION OF CORNER NOT STATED IN NOTES)

WITNESSES: B. ASH 10 N 73 E 11 (7.26' REC) (GONE)
 W. ASH 10 S 37 W 15 (9.90' REC) (GONE)

RESURVEY AT THE DIRECTION OF ALBERT E. CHAMPNEY, DIRECTOR OF WAYNE COUNTY BUREAU OF TAXATION
 W.P.A. (1930s) IRON SET E-22 (#100)

WITNESSES: ENE 32.80' 2" TREE (GONE)
 SSE 84.13' 2" ELM (GONE)
 SSW 84.50' 7" THORN (GONE)
 SW 69.88' 30" ELM (GONE)
 WSW 44.76' 30" ELM (GONE)

B. Description of corner evidence found and/or method applied in restoring or reestablishing corner.
 FOUND A CONCRETE MONUMENT IN A ROAD BOX (GOOD) AT INTERSECTION OF ALLEN ROAD AND BREST ROAD TO WEST (BOTH ASPHALT SURFACED ROADS).

DISTANCE TO I-9 MEASURED AS 2633.58'; G.L.O. (1816) RECORD DISTANCE OF 40.00 CHAINS (2640.00'); W.P.A. (1930s) RECORD DISTANCES OF 2633.26' AND 2632.85'.
 "KEYSTONE SUBDIVISION" (L.47 P.89) (DATE UNKNOWN) RECORD DISTANCE OF 2633.00'.
 DISTANCE TO I-7 MEASURED AS 2639.12'; G.L.O. (1816) RECORD DISTANCE OF 40.00 CHAINS (2640.00').
 W.P.A. (1930s) RECORD DISTANCES OF 2639.23' AND 2639.24'.
 "ALLEN GARDENS SUB" (L.53 P.78; 1925) RECORD DISTANCE OF 2639.00'.
 L. 22576 P. 799-803 FD. CONC. MON. IN H.H. (1985) CS 1885
 N.60°E. 52.0' PK NAIL (SE/SIDE) IN UTIL. POLE (GONE)
 S.40°W. 54.9' PK NAIL (SE/SIDE) IN UTIL. POLE (MEASURED 54.75')
 N.55°W. 56.1' NAIL (SW/SIDE) IN UTIL. POLE (MEASURED 56.08')
 L. 22576 P. 804-807 FD. CONC. MON. IN H.H. (1985) CS 1886
 SAME WITNESSES AS L.22576 P.799-803; CS 1885 ABOVE)

C. Description of monument for corner and accessories established to perpetuate locating the position of the corner.
 I-8 1/4 CORNER FOR SECTION 22, 23 T.3S., R.10E.
 A CONCRETE MONUMENT IN A ROAD BOX (GOOD) AT THE INTERSECTION OF ALLEN ROAD AND BREST ROAD TO WEST (BOTH ASPHALT SURFACED ROADS) AND IT IS ACCEPTED AS A CAREFUL AND FAITHFUL PERPETUATION OF THE POSITION OF THE ORIGINAL CORNER.

WITNESSES: N.32°09'E. 93.58' FOUND PK NAIL IN NW/SIDE OF UTILITY POLE
 N.74°02'E. 90.14' EXTREME SOUTHWEST CORNER OF RAISED RECTANGULAR G.V.&W. RIM
 N.51°22'W. 56.02' FOUND PK NAIL IN SW/SIDE OF UTILITY POLE
 S.35°24'W. 54.75' FOUND PK NAIL IN NW/SIDE OF UTILITY POLE (SUPRA)

PLACED A REMONUMENTATION BRASS DISC AND PVG CAP #21586 ON ABOVE FOUND CONCRETE MONUMENT I-8.

Signed by Walter J. Zbikowski Date DEC. 6, 1995
 Surveyor's Michigan License No. 21586

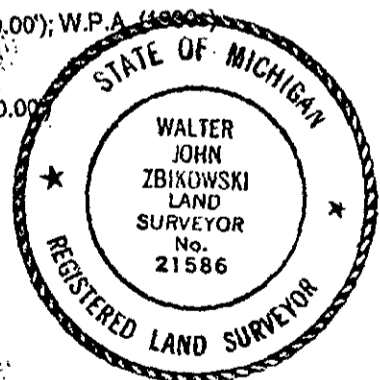

95261578

4
7