

FEB 23 2000

FILE DO NOT MAIL

LAND CORNER RECORDATION CERTIFICATE
Filing Requirement of Act 74, Mich. P.A. 1970

SECTION

For corners in

Wayne (County) Located In: City of Taylor Township #14 Corner Code # K-10
1. Public Land Survey T-3-S R-10-E
2. Property Controlling in Section S T R
3. Miscellaneous Property in Sec. S T R

Liber-30803 Page-7.0
99585612 12/20/1999 01:49PM
F.E. Youngblood, Wayne Co. Register of Deeds
RDANDSYL

Compliance with ACT 345, P.A. 1990
APPROVED ON: 12-7-99
WAYNE COUNTY REMONUMENTATION PEER GROUP COMMITTEE

Register of Deeds Stamp & File Number

4. Lot No. , Recorded Plat
5. Private Claims

I, John N. Redash, in a field survey on July 24, 1999 do hereby state that under requirements of P.A. 74, Michigan P.A. of 1970, the corner points mentioned in lines 1 and 2 above were in conformance with regulations and rules therefore as required in the current manual of survey instructions of the United States Department of the Interior, Bureau of Land Management or by a decree of a Court of Law and /or that the corner points mentioned in lines 3, 4 and 5 above were in conformance with the rules of the Michigan Board of Land Surveyors or by a Decree of a Court of Law; established, re-established, monumented, recovered, found as expressed below:

NOTE: Not more than 2 corners, all in the same town and range, may be recorded on this certificate.

Grid table with columns A-M and rows 1-15. A dot is marked at the intersection of column K and row 10.

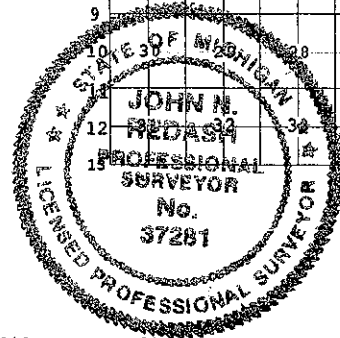

A. Description of original monument and accessories and/or subsequent restoration:

Table with 6 columns: Year, Description, G.L.O., Name, License No., Notes. Includes entries for 1816, 1930, 1974, 1993 monuments and notes.

B. Description of corner evidence found and/or method applied in restoring or reestablishing corner:

A concrete monument in a monument box in centerline of a concrete walk currently occupies this corner. 3 ties from preliminary L.C.R.C. by P. O'Rourke match the existing concrete monument. The following distances were observed between the following corners:

Table with 4 columns: Corner pair, Measurement, G.L.O. status, Rec. W.P.A. status. Includes J-10 to K-10, K-10 to L-10, K-10 to K-9, K-10 to K-11.

C. Description of monument for corner and accessories established to perpetuate locating the position of the corner:

I placed a remonumentation aluminum cap #37281 on the existing concrete monument in an existing monument box in concrete sidewalk and it is accepted as a careful and faithful perpetuation of the position of the original corner. Witnesses are as follows:

Table with 3 columns: Bearing, Distance, Description. Includes S 23° E 98.14 feet Nail and shiner E. side of light pole, etc.

\$9.00 DEED Receipt #19151
RECORDED
FOREST E. YOUNGBLOOD, REGISTER OF DEEDS WAYNE COUNTY, MI

Signed by [Signature]
Surveyor's Michigan License No. 37281

\$4.00 REMONUMENTATION 12/24, 1999

R LCR 9 4R 1Pg A. DPJ