

**SURVEY &  
REMONUMENTATION**

**RC 1435**

**L127794PA296**

**APR 25 1995**

**LAND CORNER RECORDATION CERTIFICATE**

**Filing Requirement of Act 74, Mich. P.A. 1970**

G-05 Page 1

**COMMISSION**

For corners in

Wayne County	Located in:	Sumpter	Corner Code
1. Public Land Survey	T 4 S R 8 E		G-05
	T _____ R _____		_____
	T _____ R _____		_____
	T _____ R _____		_____
2. Property Controlling In Section	S _____ T _____ R _____		_____
	S _____ T _____ R _____		_____
3. Miscellaneous Property in Sec.	S _____ T _____ R _____		_____
	S _____ T _____ R _____		_____
4. Lot No. _____, Recorded Plat _____			
5. Private Claims _____			

Compliance with  
ACT 345, P.A. 1990

APPROVED ON: 12/9/94 WCD  
WAYNE COUNTY REMONUMENTATION  
PEER GROUP COMMITTEE

Register of Deeds Stamp and File Number

	A	B	C	D	E	F	G	H	I	J	K	L	M
2	6	5	4	3	2	1							
3													
4	7	8	9	10	11	12							
5													
6	18	17	16	15	14	13							
7													
8	19	20	21	22	23	24							
9													
10	30	29	28	27	26	25							
11													
12	31	32	33	34	35	36							
13													

I, Kenneth S. Wilkerson in a field survey on 06/10/1994  
do hereby certify that under requirements of P.A. 74, Michigan P.A. of 1970, the corner points mentioned in lines 1 and 2 above were in conformance with regulations and rules therefore as required in the current manual of survey instructions of the United States Department of the Interior, Bureau of Land Management, or by a decree of a Court of Law and/or that the corner points mentioned in lines 3, 4 and 5 above were in conformance with the rules of the Michigan Board of Land Surveyors or by a Decree of a Court of Law, established, re-established, monumented, re-monumented, recovered, found as expressed below.

**NOTE: Not more than 4 corners, all in the same town and range, may be recorded on this certificate.**

**A. Description of original monument and accessories and/or subsequent restorations:**

01/01/1819

G.L.O.

Set post

10" B. OAK S 5 W 28 LINKS (18.48') (GONE)

8" B. OAK N 27 E 6 LINKS (3.96') (GONE)

(Witnesses Continued on Back ...)

**B. Description of corner evidence found and/or method applied in restoring or reestablishing corner:**

Fd. 1" iron rod in mon. box (no lid) @ int. of cl's of Sumpter & Judd Rds. Dist. to G-6 = 2634.47' (R), 2634.12' (M) & Dist. to G-4 = 2658.33 (R), 2658.21' (M)

**C. Description of monument for corner and accessories established to perpetuate locating the position of the corner:**

06/10/1994

Wilkerson

21584

O.H.M.

Remon.

SET W.C.R. WASHER & CAP OVER CORNER

7 W.C.R. TAG S/S P.P. N 62 W 57.48'

9 W.C.R. TAG N.E./S P.P. S 41 E 38.91'

11 W.C.R. TAG E/S P.P. N 19 E 140.61'

12 W.C.R. TAG W/S P.P. S 86 E 187.70'

15 ANGLE TO R. B.S. G-4, B.S. G-6 = 177-10'30"

\$ 16.00 MISCELLANEOUS RECORDING  
21 DEC 94 3:19 P.M. RECEIPT# 93A  
RECORDED

FOREST E. YOUNGBLOOD, REGISTER OF DEEDS  
WAYNE COUNTY, MI

We conclude that after careful study of the record documentation and field observations, that this corner is accepted as the best available evidence of the position of the original corner.

Signed by

*Kenneth S. Wilkerson*

Date

Dec 21 1994

Drafted by Kenneth S. Wilkerson

Surveyor's Michigan License No. 21584

Orchard, Hiltz and McCliment, Inc. 34935 Schoolcraft Road Livonia, MI 48150

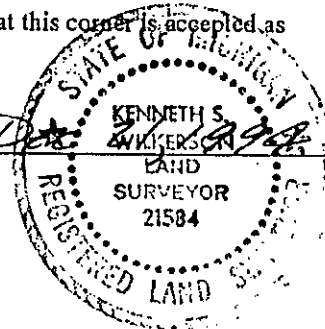

ER  
14 N - Misc

## A (Continued) Description of original monument and accessories and/or subsequent restorations:

01/01/1930

Wayne Co.  
Bureau of  
Taxation

Fd. iron LI27794PA297

- 1 S.E. COR. OF GARAGE N.W. 68.00' (GONE)
- 2 15" POPLAR N.W. 57.45' (GONE)
- 3 ED. POLE S.W. 51.10' (GONE)
- 4 W.C.R.C. SIGN POST N.E. 40.50' (GONE)
- 5 ED. POLE S.E. 39.12' (GONE)
- 6 TREE S.E. 60.88' (GONE)
- 13 DIST = 2634.47' TO G-06
- 14 DIST = 2658.33' TO G-04
- 15 ANGLE TO R. B.S. G-4, F.S. G-6 = 177-10'30"

04/13/1972

Klopshinske

W.C.R.C.

Fd. mon.

- 7 M.B.T. POLE N.W. 57.70'
- 8 ED. POLE S.W. 128.00' (GONE)
- 9 ED. POLE S.E. 38.82'
- 10 M.B.T. POLE N.E. 50.00' (GONE)