

**SURVEY & REMONUMENTATION**

APR 25 1995

**RC 1589**

**COMMISSION**

**LAND CORNER RECORDATION CERTIFICATE**  
Filing Requirement of Act 74, Mich. P.A. 1970

For corners in

<u>WAYNE</u> (County)	Located In: Huron Township	Corner Code #
1. Public Land Survey	T <u>4S</u> R <u>9E</u>	<u>I-2</u>
	T _____ R _____	_____
	T _____ R _____	_____
	T _____ R _____	_____
2. Property Controlling in Section	S _____ T _____ R _____	_____
	S _____ T _____ R _____	_____
3. Miscellaneous Property in Sec.	S _____ T _____ R _____	_____
	S _____ T _____ R _____	_____

**L127800PA656**

Compliance with  
ACT 345, P.A. 1990

APPROVED ON: 12-7-94  
WAYNE COUNTY REMONUMENTATION  
PEER GROUP COMMITTEE

Register of Deeds Stamp & File Number

4. Lot No. \_\_\_\_\_, Recorded Plat \_\_\_\_\_  
5. Private Claims \_\_\_\_\_

I, Randy Kolehouse, in a field survey on October 20 19 94, do hereby certify that under requirements of P.A. 74 Michigan P.A. of 1970, the corner points mentioned in lines 1 and 2 above were in conformance with regulations and rules therefore as required in the current manual of survey instructions of the United States Department of the Interior, Bureau of Land Management or by a decree of a Court of Law and/or that the corner points mentioned in lines 3, 4 and 5 above were in conformance with the rules of the Michigan Board of Land Surveyors or by a Decree of a Court of Law; established, re-established, monumented, re-monumented, recovered, found as expressed below:

**NOTE:** Not more than 4 corners, all in the same town and range, may be recorded on this certificate.

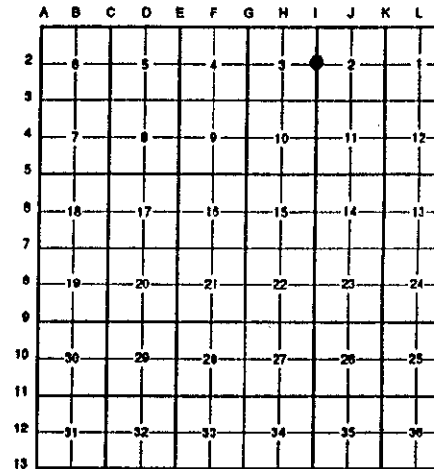

**A. Description of original monument and accessories and/or subsequent restoration:**

Date	Description	Notes	Material
I-2 1817	G.L.O. Notes	N/A	Post
1930's	WPA Notes	N/A	Iron
1973	WCRC Notes	N/A	3/4" Iron
1976	L.C.R.C. L. 19333 P. 422	Taft	1/2" Iron Pipe

**B. Description of corner evidence found and/or method applied in restoring or reestablishing corner:**

I-2 I found 3/4" rebar at the C/L intersection of Merriman road running N-S and Prescott (gravel) running E-W. Checks one possible witness from WPA section corner ties ± 1.0' D.E. Pole SE 42.62'. Also checks WCRC witnesses (1973).

WCRC  
Nail & Tag NE Face D.E. Pole SEk'ly 41.49' (41.32' m)  
C/L of Hyd. NW'y 56.23' (56.48' m)

\$ 13.00 MISCELLANEOUS RECORDING  
28 DEC 94 9:39 A.M. RECEIPT# 160  
RECORDED  
FOREST E. YOUNGBLOOD, REGISTER OF DEEDS  
WAYNE COUNTY, MI

Measures South to I-3 = 2616.09' (G.L.O. = 2640) (WPA = 2615.50' S-2 - 2615.43' S-3)  
Measures West to H-2 = 2651.00' (WPA = 2650.05')

**C. Description of monument for corner and accessories established to perpetuate locating the position of the corner:**

I-2 Replaced 3/4" rebar with 4" x 36" concrete monument with aluminum cap stamped "Wayne Co. Remon."

Nail w/Tag "WCR" NW Face 12" Maple N 42° E 79.81'  
P.K. w/Tag "WCRC" NE Face Util. Pole S 50° E 41.32'  
Nail w/Tag "RLS #261" SE Face Util. Pole S 50° W 38.54'  
C/L Top Nut Hydrant N 57° W 56.48'

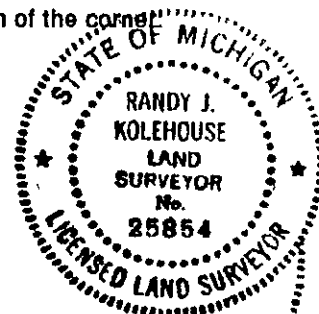

The selected location is accepted by the Contractor and is generally accepted by professional surveyors as the best available evidence of the position of the original corner.

Signed by Randy J. Kolehouse Date 12/14/94  
Surveyor's Michigan License No. 25854