

APR 16 1999

RECEIVED

1998 DEC 30 AM 10:18

SECTION

LAND CORNER RECORDATION CERTIFICATE  
Filing Requirement of Act 74, Mich. P.A. 1970

*Linda Laughmiller*  
WEXFORD COUNTY, MI  
REGISTER OF DEEDS

For corners in

<u>WEXFORD</u> (County)	Located In:	Corner Code #
1. Public Land Survey	T <u>21N</u> R <u>9W</u>	<u>F-13</u>
	T _____ R _____	_____
	T _____ R _____	_____
	T _____ R _____	_____
2. Property Controlling in Section	S _____ T _____ R _____	_____
	S _____ T _____ R _____	_____
3. Miscellaneous Property in Sec.	S _____ T _____ R _____	_____
	S _____ T _____ R _____	_____
4. Lot No. _____, Recorded Plat _____		
5. Private Claims _____		

Register of Deeds Stamp & File Number

I, CRAIG J. PULLEN, PS, in a field survey on OCTOBER 7, 1998, do hereby state that under requirements of P.A. 74, Michigan P.A. of 1970, the corner points mentioned in lines 1 and 2 above were in conformance with regulations and rules therefore as required in the current manual of survey instructions of the United States Department of the Interior, Bureau of Land Management or by a decree of a Court of Law and/or that the corner points mentioned in lines 3, 4 and 5 above were in conformance with the rules of the Michigan Board of Land Surveyors or by a Decree of a Court of Law; established, re-established, monumented, recovered, found as expressed below:

NOTE: Not more than 2 corners, all in the same town and range, may be recorded on this certificate.

	A	B	C	D	E	F	G	H	I	J	K	L	M
1													
2		6		5		4		3		2		1	
3													
4		7		8		9		10		11		12	
5													
6		18		17		16		15		14		13	
7													
8		19		20		21		22		23		24	
9													
10		30		29		28		27		26		25	
11													
12		31		32		33		34		35		36	
13													

A. Description of original monument and accessories and/or subsequent restoration:

- F-13 1838 G.L.O. SURVEY BY J. BRINK, WOOD POST BEECH 13 N35E 26, SUGAR 10 N64W 27
- 1890 A.J. TEED SURVEY IN SECTION 33, T21N, R9W, FOUND BOTH GOV. WIT. TREES FROM WHICH SET CORNER. PUT IN STONE MARKED WITH AN "X", CROCKERY & STAKE. GOOD STAKE STONES & JUGS. IT IS 88 LINKS EAST OF OSCEOLA CORNER. SUGAR 12 N8W 63, HEM 14 N53E 65
- 1898 D.E. TEED SURVEY IN SECTION 33, T21N, R9W, STAKE IS 88L EAST OF OSCEOLA CORNER FOR WHICH CEDAR FENCE POST (MARKED BP) S41E 56
- 1927 MDOT HIGHWAY RIGHT-OF-WAY SHEET FOR MACKINAW TRAIL (THEN US-131). 1/4 CORNER IS 25.3' EAST OF CENTERLINE. SECTION CORNER IS 31.5' WEST OF CENTERLINE.
- 19?? WEXFORD COUNTY ROAD COMMISSION WITNESS BOOK 20" MAPLE NE 102.30', 12" MAPLE SE 48.20'

B. Description of corner evidence found and/or method applied in restoring or reestablishing corner:

- F-13 SET 5/8" X 36" IRON & BRASS CAP ON LINE BETWEEN SW CORNER AND SE CORNER OF SECTION 33 AND 25.3' EAST OF CENTERLINE OF MACKINAW TRAIL. ROAD COMMISSION BOOK WITNESS (MAPLE TO NE) WAS FOUND N78E 103.01' FROM IRON. THE IRON IS 7' NORTH OF CENTERLINE OF EAST 52 ROAD. THE DISTANCE TO THE SW CORNER OF SECTION 33 IS 2651.00' (2651.22'-TEED) AND THE DISTANCE TO THE SE CORNER OF SECTION IS 2652.08' (2649.24'-TEED). THIS CORNER IS ACCEPTED AS THE BEST AVAILABLE EVIDENCE OF THE POSITION OF THE CORNER.

C. Description of monument for corner and accessories established to perpetuate locating the position of the corner:

- F-13 SOUTH 1/4 CORNER OF SECTION 33, T21N, R9W
- 5/8" X 36" IRON WITH BRASS CAP STAMPED: CJP, 39095, 1998, 33, 1/4
- N78°E 30" MAPLE 103.01'
- S54°E FENCE POST 64.49'
- S72°W TOP CENTER OF TEL. PED. 80.57'
- N72°W POWER POLE 103.14'

Peer Group Reviewed and Approved  
Date: 30 Oct 98  
*Richard D. Wilcox*  
Richard D. Wilcox, Wexford County Surveyor

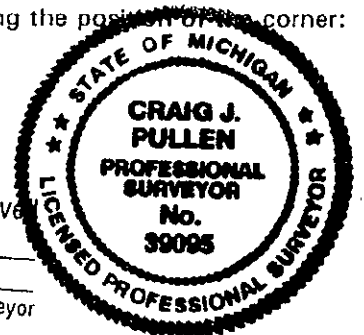

Signed by Craig J. Pullen

Date NOVEMBER 6, 1998

Surveyor's Michigan License No. 39095