

LAND CORNER RECORDATION CERTIFICATE

FILING REQUIREMENT OF ACT 74, MICH. P.A.1970

FOR CORNERS OF --:	LOCATED IN--:	CORNER CODE NUMBER
1. PUBLIC LAND SURVEY _____	T. <u>23</u> N. <u>●</u> , R. <u>9</u> <u>●</u> W.	I-12 J-11 L-9
2. PROPERTY CONTROLLING IN SECTION _____	T. _____ N. _____ S., R. _____ E. _____ W.	_____
3. MISCELLANEOUS PROPERTY IN SECTION _____	T. _____ N. _____ S., R. _____ E. _____ W.	_____
4. LOT NO. _____, RECORDED PLAT _____		
5. PRIVATE CLAIMS _____		

REGISTER OF DEEDS STAMP AND FILING NUMBER

I, Carl F. Roser do hereby certify that under requirements of P.A. 74, Michigan P.A. of 1970, the corner points mentioned in lines 1 and 2 above (identified with circles on index code diagram - over) were, in a field survey on 11-22 1972, established, re-established, monumented, re-monumented, recovered or restored as expressed below and in conformance with regulations and rules therefore as required in the current manual of survey instructions of the United States Department of the Interior, Bureau of Land Management or by a decree of a court of law. Furthermore, that the corner points mentioned in lines 3, 4 and 5 above were, in a field survey on _____ 19____, found, recovered, restored, established or re-established as expressed below and in conformance with the rules of the Michigan State Board of Registration for Land Surveyors or, by a Decree of a Court of law:

A. Description of original monument and accessories and/or subsequent restoration:

B. Description of corner evidence found and/or method applied in restoring or re-establishing corner:

- I-12 Reestablished corner per standard B.L.M. instructions.
- J-11 Reestablished corner per standard B.L.M. instructions.
- L-9 Restored corner equidistant between sections corners to E & W and in line with fence remains E and approximate center of road to N & W.

C. Description of monument for corner and accessories established to perpetuate locating the position of the corner:

I-12	J-11	L-9
Set DNR Mon & Cedar Gd Post	Set DNR Mon. & Cedar Gd Post	Set DNR Monument
4" Oak N46W 12.3'	20" Oak N 9E 47.4'	12" TwOak N47W 55.4'
24" W.P. stp S25W 24.3'	9" Oak N36E 74.5'	8" Maple S62W 41.0'
9" Oak S10E 46.0'	8" Oak S14W 62.1'	14" Maple N88E 20.1'
8" Maple cluster N46E 44.0'		Set Ced. Post w/loc tag Due E 16.5'
C. Line old N-S grade Due E 15'		Ctr. Dirt Rd on curve NW 27 1/2'

SIGNED BY Carl F. Roser DATE 1-11-73

SURVEYOR'S MICHIGAN REGISTRATION NO. 12028

FOR STATE AND UNITED STATES AGENCIES:

SIGNED BY _____ DATE _____
CHIEF OF SURVEY PARTY

APPROVED AND SIGNED BY _____ DATE _____
MICHIGAN REGISTERED LAND SURVEYOR

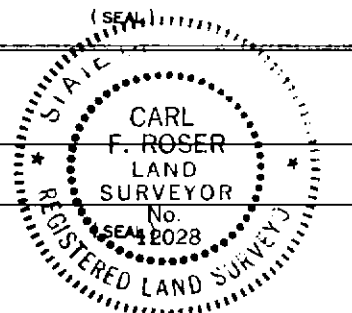

SURVEYOR'S MICHIGAN REGISTRATION NO. _____