

**"SURVEY &  
REMONUMENTATION**

APR 25 1995

RECEIVED

1994 NOV 23 PM 3: 53

**COMMISSION**

**LAND CORNER RECORDATION CERTIFICATE  
Filing Requirement of Act 74, Mich. P.A. 1970**

For corners in

Wexford  
(County)

Located In:

Corner Code #

- |                                    |   |              |             |            |
|------------------------------------|---|--------------|-------------|------------|
| 1. Public Land Survey              | T | <u>23</u> NR | <u>10</u> W | <u>M-5</u> |
|                                    | T | ___          | R           | ___        |
|                                    | T | ___          | R           | ___        |
|                                    | T | ___          | R           | ___        |
| 2. Property Controlling in Section | S | ___          | T           | R          |
|                                    | S | ___          | T           | R          |
| 3. Miscellaneous Property in Sec.  | S | ___          | T           | R          |
|                                    | S | ___          | T           | R          |
4. Lot No. \_\_\_\_\_, Recorded Plat \_\_\_\_\_
5. Private Claims \_\_\_\_\_

*Linda Loughmiller*  
WEXFORD COUNTY, MI  
REGISTER OF DEEDS

Register of Deeds Stamp & File Number

I, George D. Smith, in a field survey on August 9, 19 94, do hereby certify that under requirements of P.A. 74, Michigan P.A. of 1970, the corner points mentioned in lines 1 and 2 above were in conformance with regulations and rules therefore as required in the current manual of survey instructions of the United States Department of the Interior, Bureau of Land Management or by a decree of a Court of Law and/or that the corner points mentioned in lines 3, 4 and 5 above were in conformance with the rules of the Michigan Board of Land Surveyors or by a Decree of a Court of Law; established, re-established, monumented, re-monumented, recovered, found as expressed below:

**NOTE: Not more than 4 corners, all in the same town and range, may be recorded on this certificate.**

	A	B	C	D	E	F	G	H	I	J	K	L	M
2	6	5	4	3	2	1							
3													
4	7	8	9	10	11	12							
5													
6	18	17	16	15	14	13							
7													
8	19	20	21	22	23	24							
9													
10	30	29	28	27	26	25							
11													
12	31	32	33	34	35	36							
13													

A. Description of original monument and accessories and/or subsequent restoration:

- M-5) 1838 GLO Section post by John Brink, Deputy Surveyor, 14" Elm N 81° W 88, 30" Hemlock S 49° W 38
- M-5) 1853 GLO subdivision of Section 7 & 8, T23N, R9W by V.W. Caukins, Deputy Surveyor, 18" Sugar N 83° E 44, 12" Sugar S 70° E 44
- M-5) 1913 D.E. Teed survey: Found stake with stone on top set by D.E. Teed in 1899, Hemlock witness SW okay
- M-5) 1985 Wade-Trim Granger LCRC, Liber 03, page 332: Set Wexford County monument by single prop. measure 10" Twin Elm N 46° E 67.45', 28" Maple S 30° E 47.40', power pole S 54° E 71.35', centerline road 11.5' East

B. Description of corner evidence found and/or method applied in restoring or reestablishing corner:

Found Wexford County monument (in good condition) 11.5' West of centerline road North-South, 9' North of centerline road West and in centerline road East. This corner is accepted as a careful and faithful reestablishment of the position of the original corner, being the Section corner common to Sections 12 and 13, T23N, R10W and Sections 7 and 18, T23N, R9W.

C. Description of monument for corner and accessories established to perpetuate locating the position of the corner:

Wexford County monument with aluminum cap

- N 46° E - 68.02' - 10" Twin Elm
- S 54° E - 71.35' - Power pole
- S 49° W - 76.09' - 8" Red Pine
- N 38° W - 31.52' - Set 1/2" Iron & cap #14102 at southwest corner tele riser

Peer Group Reviewed and Approved

Date: 11-21-94  
*Richard D. Wilcox*  
Richard D. Wilcox, Wexford County Surveyor

Signed by

*George D. Smith*

Surveyor's Michigan License No. 39098

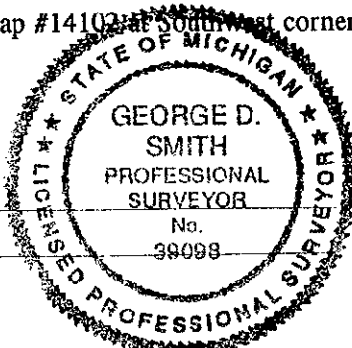

Date 11/17/94

LIBER 04 PAGE 274