

MICHIGAN
DEPARTMENT OF CONSERVATION
FORESTRY DIVISION

LAND CORNER RECORD

T. 24 N. R. 10 W.

Wexford COUNTY

DESCRIPTION OF CORNER Section common to Sections 19 - 20 - 29 - 30

CORNER MONUMENT Set 1" pipe with 4" brass cap

DATE MONUMENT PLACED AND WITNESSED April 11, 1962

WITNESSES TO CORNER.....

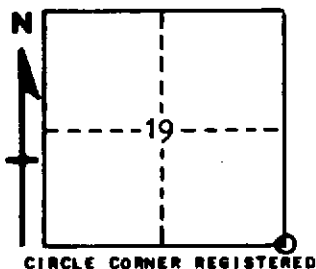

12" R. Pine N 70½ W - 142.7'

16" R. Pine S 82½ E - 176.9'

AND 12" R. Pine stub S 6 W - 49.4'

DESCRIPTION IN DETAIL AS TO HOW CORNER WAS LOCATED AND IDENTIFIED OR RESTORED.

This corner was found while making a survey in this township. Found 1½" pipe at corner as established by Marcus Schaaf, R.L.S. in 1938. NW U.S. BT longbutt down and rotting but part of upper face salvaged for preservation. Good original corner.

SURVEYOR'S SEAL

SIGNED *Kenneth J. Pethig* DATE April 18, 1962
REGISTERED LAND SURVEYOR