

MICHIGAN  
DEPARTMENT OF CONSERVATION  
FORESTRY DIVISION

# LAND CORNER RECORD

T. 24 N.R. 10 W.

Wexford COUNTY

DESCRIPTION OF CORNER E 1/8 corner common to Sections 29 - 32

CORNER MONUMENT Set 1" x 24" pipe

DATE MONUMENT PLACED AND WITNESSED April 25, 1962

WITNESSES TO CORNER.....

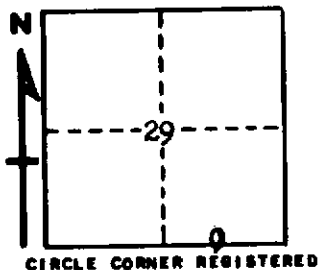

BT 24" W. Pine stump N 12 E - 46.5'

BT 6" Maple S 84 E - 48.5'

AND

DESCRIPTION IN DETAIL AS TO HOW CORNER WAS LOCATED AND IDENTIFIED OR RESTORED.

This corner was established while making a survey in this area. Set corner midpoint on line between 1/4 and Sections corners. A 4" concrete monument is 1.0" south.

SURVEYOR'S SEAL

SIGNED Kenneth J. O'Brien DATE April 27, 1962  
REGISTERED LAND SURVEYOR