

LAND CORNER RECORDATION CERTIFICATE

FILING REQUIREMENT OF ACT 74, MICH. P.A.1970

FOR CORNERS OF—:	LOCATED IN—:	CORNER CODE NUMBER
1. PUBLIC LAND SURVEY _____	T. 24 XX N. R. 11 XX W.	K-2;
2. PROPERTY CONTROLLING IN SECTION <u>1</u>	T. 24 XX N. R. 11 XX W.	10
3. MISCELLANEOUS PROPERTY IN SECTION _____	T. _____ N. S. R. _____ E. W.	_____
4. LOT NO. _____, RECORDED PLAT _____		
5. PRIVATE CLAIMS _____		

REGISTER OF DEEDS STAMP AND FILING NUMBER

I, Carl F. Roser do hereby certify that under requirements of P.A. 74, Michigan P.A. of 1970, the corner points mentioned in lines 1 and 2 above (identified with circles on index code diagram—over) were, in a field survey on May 22, 1974 19____, established, re-established, monumented, re-monumented, recovered or restored as expressed below and in conformance with regulations and rules therefore as required in the current manual of survey instructions of the United States Department of the Interior, Bureau of Land Management or by a decree of a court of law. Furthermore, that the corner points mentioned in lines 3, 4 and 5 above were, in a field survey on _____ 19____, found, recovered, restored, established or re-established as expressed below and in conformance with the rules of the Michigan State Board of Registration for Land Surveyors or, by a Decree of a Court of law:

A. Description of original monument and accessories and/or subsequent restoration:

B. Description of corner evidence found and/or method applied in restoring or re-establishing corner:

- K-2 Accepted corner fence post, fence S. & E., as $\frac{1}{4}$ corner.
- Code 10 Established corner per Std. BLM instructions.

C. Description of monument for corner and accessories established to perpetuate locating the position of the corner:

K-2	Code 10
Set Std. Wexford Co. Mon. & Ced. Post with Loc. Tag.	Set 1"x36" Pipe & Ced. Post W/Loc. Tag.
6" Maple N 78 E 24.2	8" Maple N 37 W 3.90
11" Maple N 27 E 25.8	8" Maple S 82 W 29.70
8" Cherry N 33 W 39.3	12" Cherry S 25 E 28.93
	N-S fence Due E 4'
	Fn. to West Due N 27'

SIGNED BY Carl F. Roser DATE 7-31-74

SURVEYOR'S MICHIGAN REGISTRATION NO. 12028

FOR STATE AND UNITED STATES AGENCIES:

SIGNED BY _____ DATE _____
CHIEF OF SURVEY PARTY

APPROVED AND SIGNED BY _____
MICHIGAN REGISTERED LAND SURVEYOR

SURVEYOR'S MICHIGAN REGISTRATION NO. _____

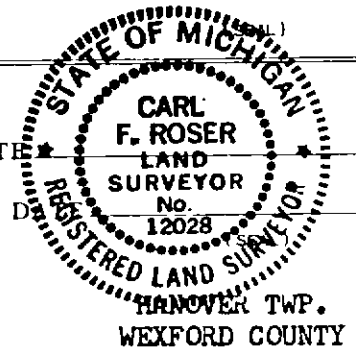

CORNER NUMBERING CODE DIAGRAMS FOR IDENTIFYING LAND CORNER RECORDATIONS AND INDEXING

FOR PUBLIC LAND SURVEY CORNERS IN THE
T. 24N, R. 11W (MENTIONED OVER)

	A	B	C	D	E	F	G	H	I	J	K	L	M
1													
2		6		5		4		3		2	⊙	1	
3													
4		7		8		9		10		11		12	
5													
6		18		17		16		15		14		13	
7													
8		19		20		21		22		23		24	
9													
10		30		29		28		27		26		25	
11													
12		31		32		33		34		35		36	
13													

Apply letter prefix for corner points encircled above for identifying corner recordation numbers over.

FOR PROPERTY CONTROLLING AND MISC. PROPERTY CORNERS WITHIN THE SECTION (MENTIONED OVER AND EXCLUDE LOT CORNER)

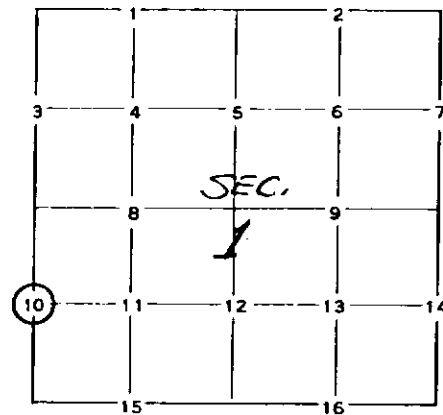

1. Above coded numbers are positioned on 1/16 fractional lines of the section.
2. Township corner code numbers shall be applied to corners of above typical section not numbered.
3. Miscellaneous property corners within a section, located at points other than numbered above, shall be referenced to at least two of above corner code numbers.
4. Private claim corners to be tied to rectangular land corners if possible - sketch required below.

EXPLANATORY SKETCH IF NECESSARY -- BELOW