

REMONUMENTATION

MAY - 1 1995

COMMISSION

LAND CORNER RECORDATION CERTIFICATE
Filing Requirement of Act 74, Mich. P.A. 1970

For corners in

Washtenaw

County

Located in: Lima Twp Corner Code

1. Public Land Survey T 2 S R 4 E M-11
 T _____ R _____
 T _____ R _____
 T _____ R _____
 T _____ R _____
2. Property Controlling S _____ T _____ R _____
 in Section S _____ T _____ R _____
3. Miscellaneous S _____ T _____ R _____
 Property in Sec. S _____ T _____ R _____
4. Lot No. _____, Recorded Plat _____
5. Private Claims _____

RECORDED
 WASHTENAW COUNTY, MI
 SEP 21 11 26 AM '94
 M-11
 COUNTY CLERK/REGISTRAR
 PEROT H. HAINES

LIBER 1 PAGE 110RM
 -COPY-

Register of Deeds Stamp and File Number

	A	B	C	D	E	F	G	H	I	J	K	L
2	6	5	4	3	2	1						
3												
4	7	8	9	10	11	12						
5												
6	18	17	16	15	14	13						
7												
8	19	20	21	22	23	24						
9												
10	30	29	28	27	26	25						
11												
12	31	32	33	34	35	36						
13												

I, Michael S. Hoben in a field survey on Monday, November 01, 1993
do hereby certify that under requirements of P.A. 74, Michigan P.A. of 1970, the corner points mentioned in lines 1 and 2 above were in conformance with regulations and rules therefore as required in the current manual of survey instructions of the United States Department of the Interior, Bureau of Land Management, or by a decree of a Court of Law and/or that the corner points mentioned in lines 3, 4 and 5 above were in conformance with the rules of the Michigan Board of Land Surveyors or by a Decree of a Court of Law, established, re-established, monumented, re-monumented, recovered, found as expressed below.

NOTE: Not more than 4 corners, all in the same town and range, may be recorded on this certificate.

A. Description of original monument and accessories and/or subsequent restorations:

- Monday, January 01, 1816 Fletcher G.L.O. 1816. Set post.
 Witnesses:
 NO BEARING TREES
- Tuesday, April 10, 1934 W. J. Armstrong 2444 WCRC Grid Book Fd old wood stake. Set 1 1/2" X 40" iron pipe stones & bricks.
 Witnesses:
 1 S.W. COR. BRIDGE FLOOR N. 9 W., 29.1'
 2 S.E. COR. BRIDGE FLOOR N. 22.5 E., 28.3'
 4 8" TRIPLE ELM S. 88 E., 16.4'
 5 10" ELM S. 12 E., 71.4'
 6 15" ELM S. 35.5 W., 40.6'
 7 8" ELM N.26 W., 24.1'
- Wednesday, January 01, 1964 R. B. WCRC Grid Book 1964. Fd. 1 1/2" iron pipe.
 Witnesses:
 8 NAIL IN W. END POST N. 27 E., 83.70'
 9 NAIL IN 4" ELM N.72 E., 62.85'
 10 NAIL IN T. POLE S. 22 E., 89.00'
- Wednesday, June 26, 1974 Norm Fahrner 17620 WEC L.4-P.9 Fd. spike.
 Witnesses:
 8 NAIL IN W. END POST N. 27 E., 83.70'
 9 NAIL IN 4" ELM N.72 E., 62.85'
 10 NAIL IN T. POLE S. 22 E., 89.00'
 11 S.E. COR. SQ. MH N. 45 W., 34.20'
- Thursday, January 02, 1975 Howard W. Taft 12032 L.3-P.5 Fd. boat spike in centerline of road.
 Witnesses:
 11 S.E. COR. 6' X 6' CONC. BOX. N. 41 W., 34.20'
 12 NW COR. SEC. 31 SCIO TWP. N'LY 108.56'
 13 SE'LY MOST NUT ON 8" CMP N.30 E., 52.4'
 14 S'LY END 24" CULVERT S. 40 W., 44.2'

B. Description of corner evidence found and/or method applied in restoring or reestablishing corner:

Fd. 1 1/2" iron pipe in pave. Set mon. box with WCR cap on iron.

C. Description of monument for corner and accessories established to perpetuate locating the position of the corner:

- Monday, November 01, 1993 Orchard, Hiltz & McCliment, Inc. 21584 OHM W. C. Remon
 Witnesses:
 8 PK NAIL WITH WCR TAG IN W. END POST N. 27 E., 83.70'
 12 FD. IRON NW COR. SEC. 31 SCIO TWP. N'LY 108.56'
 15 NAIL IN 6" TREE N. 40 E., 67.20'
 16 PK NAIL WITH WCR TAG IN 6" TREE S. 14 E., 97.94'
 17 PK NAIL WITH WCR TAG IN D.E. POLE S. 18 W., 119.39'

18 PK NAIL WITH WCR TAG IN 15" ASH N.12 W., 129.00'

LIBER

1 PAGE 111Rm

M-11 Page 2

-COPY-

We conclude that after careful study of the record documentation and field observations, that this corner is accepted as the best available evidence of the position of the original corner.

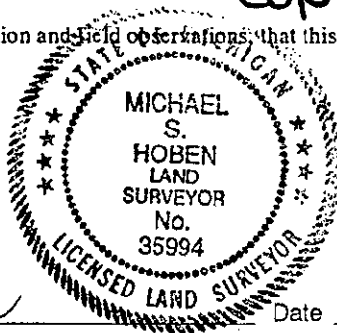

Signed by Michael S. Hoben

Date May 2, 1984

Drafted by Michael S. Hoben

Surveyor's Michigan License No. 35994

Orchard, Hiltz and McCliment, Inc. 34935 Schoolcraft Road Livonia, MI 48150

APPROVED
 DATE 5/31/84
 CO. REP. M