

**SURVEY &  
REMONUMENTATION**

MAR 09 1998

RECORDED  
WASHTENAW COUNTY, MI

JAN 22 8 32 AM '98

SECTION

LAND CORNER RECORDATION CERTIFICATE  
Filing Requirement of Act 74, Mich. P.A. 1970

PEGGY N. HAINES  
COUNTY CLERK/REGISTER

For corners in

<u>Washtenaw</u> (County)	Located In:	Corner Code #
1. Public Land Survey	T <u>2S</u> R <u>5E</u>	<u>K-5</u>
	T ___ R ___	_____
	T ___ R ___	_____
	T ___ R ___	_____
2. Property Controlling in Section	S ___ T ___	R ___
	S ___ T ___	R ___
3. Miscellaneous Property in Section	S ___ T ___	R ___
	S ___ T ___	R ___
4. Lot No. _____, Recorded Plat _____		
5. Private Claims _____		

- COPY -  
  
- COPY -  
  
Liber 00002 Page 0057<sup>RM</sup>  
Register of Deed Stamp & File Number

	A	B	C	D	E	F	G	H	I	J	K	L	M
1													
2	6	5	4	3	2	1							
3													
4	7	8	9	10	11	12							
5													
6	18	17	16	15	14	13							
7													
8	19	20	21	22	23	24							
9													
10	30	29	28	27	26	25							
11													
12	31	32	33	34	35	36							
13													

I, Thomas L. Sutherland, in a field survey on, 11/6, 1997 do hereby state that under requirements of P.A. 74, Michigan P.A. of 1970, the corner points mentioned in lines 1 and 2 above were in conformance with regulations and rules therefore as required in the current manual of survey instructions of the United States Department of the Interior, Bureau of Land Management or by a decree of a Court of Law and/or that the corner points mentioned in lines 3, 4 and 5 above were in conformance with the rules of the Michigan Board of Land Surveyors or by a Decree of a Court of Law; established, re-established, monumented, recovered, found as expressed below:

NOTE: Not more than 2 corners, all in the same town and range, may be recorded on this certificate.

A. Description of original monument and accessories and/or subsequent resortation:

- G.L.O. 1819, Field Notes
- 1) 11" W.O. N42°W 1 Chain
- 2) 30" Do N74°E 2.71 Chains

Continued on other side

B. Description of corner evidence found and/or method applied in restoring or re-establishing corner:

Found 1/2" x 12" Iron Pipe 1.0 feet below stone surface (apron from road to stone walkway) with square head bolt in top, 6.2 feet west of west edge asphalt pavement. Reset 3/4" x 18" Iron Pipe with aluminum Remonumentation Cap stamped 24620 6" below stone surface.

C. Description of monument for corner and accessories established to perpetuate locating the position of the corner:

- 3/4" x 18" Iron Pipe with Remonumentation cap stamped 24620 6" below stone surface
- 3) 32" Walnut S80°W 31.60 to Remon Tag on South Side
- 4) 22" Walnut S44°W 43.16 to Remon Tag on SE side
- NW Corner Stone walk N39°W 18.40
- 5" Oak N65°E 67.65 to Remon Tag on SW Side
- 36' Walnut S26°W 66.08 to Remon Tag on SE Side

APPROVED  
DATE 12/2/97  
CO. REP. Ly

I conclude that after careful study of the record documentation and field observations, that this corner is accepted as the best available evidence of the position of the original corner.

Signed by: Thomas L. Sutherland Date 12-4-97  
Surveyor's Michigan License No. 24620

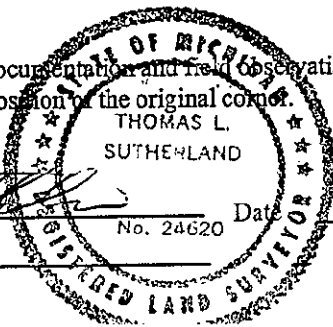

-COPY-

## A. (Continued from Front)

H.H. Atwell #322, No Date, Grid Book  
Iron Pipe

- 3) 14" Black Walnut S84 $\frac{1}{2}$ °W 31.4
- 4) 12" Black Walnut S51°W 43.0
- 5) 18" Elm S09°E 63.1
- 6) 14" Cherry S43 $\frac{1}{2}$ °E 23.8
- 7) 16" Burr Oak S84°E 19.7

Atwell-Hicks, 3-22-55, Dwg 206-63

- 3) 14" B. Walnut S84 $\frac{1}{2}$ °W 31.4
- 4) 12" B. Walnut S51°W 43.0
- 5) 18" Elm S09°E 63.1
- 6) 14" Cherry S43 $\frac{1}{2}$ °E 23.8
- 7) 16" Burr Oak S89°E 19.7
- 8) 28" Burr Oak N35°E 71.3

Atwell-Hicks, R. Jagow #6998, 12-5-73,  
L.C.R.C., Liber 3, Page 323, 1/2' Iron Rod and 8-3-76, L.C.R.C., Liber 4, Page 152,  
1/2" Iron Pipe

- 3) 24" B. Walnut S84°W 31.4
- 4) 18" B. Walnut S51°W 43.0
- 6) 20" Cherry S43°E 23.8
- 7) 30" Burr Oak S84°E 19.7

Atwell-Hicks, P. Schwimmer #24618, 6-12-78 Field Notes,  
1/2' Iron Pipe

- 9) 18" Walnut S68°E 31.2
- 10) 14" Walnut S33°E 43.7
- 11) 18" Walnut S18°E 65.7
- 6) 18" B. Cherry S60°E 23.5
- 7) 30" B. Oak S86°E 19.4

Washtenaw Engineering, N. Farhner #17620, 3-17-79

L.C.R.C., Liber 5, Page 201 and Dwg. R-4339

1/2" Iron Pipe

- 3) 28" B. Walnut S84°W 31.4
- 4) 24" B. Walnut S51°W 43.0
- 7) 36" Burr Oak S84°E 19.7
- 12) 16" Willow N35°W 89.4
- 8) 36" Oak N10°E 72.0

Washtenaw Engineering, N. Farhner #17620, 1-9-85, Dwg. R-5184; 2-19-85, Dwg.

R-5199 and 7-2-88; Dwg. R-5823

L.C.R.C., Liber 5, Page 201 and Dwg. R-4339

1/2" Iron Pipe

- 3) 28" Walnut S84°W 31.22 to Nail
- 4) 24" Walnut S51°W 43.16 to Nail
- 6) 20" Cherry S43°E 23.80 to Nail
- 7) 36" Oak S84°E 19.43 to Nail
- 8) 36" Oak N10°E 71.90 to Nail