

**SURVEY &
REMONUMENTATION**

MAR 09 1998

RECORDED
WASHTENAW COUNTY, MI

JAN 22 8 32 AM '98

SECTION

LAND CORNER RECORDATION CERTIFICATE

Filing Requirement of Act 74, Mich. P.A. 1970

PEGGY M. HAINES
COUNTY CLERK/REGISTER

- COPY -

For corners in

<u>Washtenaw</u> (County)	Located In:	Corner Code #
1. Public Land Survey	T <u>2S</u> R <u>5E</u>	<u>L-7</u>
	T ___ R ___	_____
	T ___ R ___	_____
	T ___ R ___	_____
2. Property Controlling in Section	S ___ T ___ R ___	_____
	S ___ T ___ R ___	_____
3. Miscellaneous Property in Section	S ___ T ___ R ___	_____
	S ___ T ___ R ___	_____
4. Lot No. _____, Recorded Plat _____		
5. Private Claims _____		

- COPY -
Liber 00002 Page 0066 RM

Register of Deed Stamp & File Number

I, Thomas L. Sutherland, in a field survey on 11/5, 1997 do hereby state that under requirements of P.A. 74, Michigan P.A. of 1970, the corner points mentioned in lines 1 and 2 above were in conformance with regulations and rules therefore as required in the current manual of survey instructions of the United States Department of the Interior, Bureau of Land Management or by a decree of a Court of Law and/or that the corner points mentioned in lines 3, 4 and 5 above were in conformance with the rules of the Michigan Board of Land Surveyors or by a Decree of a Court of Law; established, re-established, monumented, recovered, found as expressed below:

NOTE: Not more than 2 corners, all in the same town and range, may be recorded on this certificate.

	A	B	C	D	E	F	G	H	I	J	K	L	M
1													
2	6			5			4			3			1
3													
4	7			8			9			10			12
5													
6	18			17			16			15			13
7													
8	19			20			21			22			24
9													
10	30			29			28			27			25
11													
12	31			32			33			34			36
13													

A. Description of original monument and accessories and/or subsequent resortation:

- G.L.O. 1819, Field Notes
- 1) 16" W.O. S76°W 29 Links
- 2) 30" Do N87°E 63 Links

Continued on other side

B. Description of corner evidence found and/or method applied in restoring or re-establishing corner:

Found 3/4" X 18" Iron Pipe in East-West fence line 86.43 feet West of Iron Pipe in Centerline of Miller Road. Removed and dug 3 foot hole 2 feet deep. Found nothing else. Placed Aluminum Remonumentation cap stamped 24620 over existing 3/4" x 18" Iron Pipe and reset.

C. Description of monument for corner and accessories established to perpetuate locating the position of the corner:

- 3/4" Iron Pipe with Aluminum Remonumentation Cap stamped 24260
- 5) 20" Hickory S70°E 98.00 to Remon Tag on Southerly Side
- 6) 16" Walnut N60°E 20.00 to Remon Tag on NW Side
- 7) 12" - 18" Twin Oak North 15.80 to Remon Tag on West Side
- 8) Utility pole West 26.40 to Remon Tag on North side
- Telephone manhole S60°E 14.41 to Center
- 12" Elm S20°W 55.71 to Remon Tag on Easterly Side

APPROVED
DATE 12-2-97
CO. REP. K

I conclude after careful study and field observation that this corner is acceptable as the best available evidence of the position of the original corner.

Signed by: Th. L. Sutherland

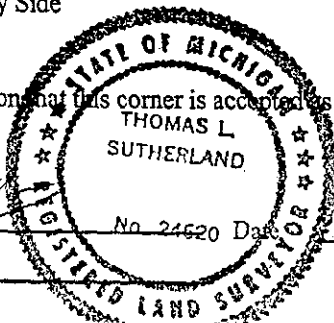

Surveyor's Michigan License No. 24620

12-4-97

- COPY -

A. (Continued from Front)

H.H. Atwell, #322, No Date, Grid Book

- 3) B. Walnut Southerly 134.2
- 4) 20" B. Oak Northwestserly 46.0
- 5) 10" Hickory Southeasterly 98.0

Atwell Hicks, R. Jagow #6998, 1/6/72

Field Notes: 1/7/72 L.C.R.C., Liber 1, Page 435 and Dwg. 507-7. 1/4" Corner Iron Pipe found in January 1970, Found Iron Pipe 86.40 East along the South line of Section (13) in Centerline of Miller Road and set Iron Pipe 28.93 feet West along the South line of Section. 1/4 Corner Iron Missing January 1972. Other Pipe Found. set 3/4" X 18" Iron Pipe with yellow plastic cap (#6998)

- 5) 14" Hickory S70°E 98.0
- 6) 10" Walnut N60°E 20.0
- 7) 12" Twin Oak N15°E 15.3
- 8) Power Pole West 26.4

C. Wilson & Assoc., C. Wilson #13604, 6/16/86, Job No. 86114,

3/4" Iron Pipe

- 5) 14" Hickory S70°E 98.0
- 6) 10" Walnut N60°E 20.0
- 7) 12" Twin Oak N15°E 15.3
- 8) Utility Pole Westerly 26.4