

SURVEY & REMONUMENTATION

NOV 02 1999

LAND CORNER RECORDATION CERTIFICATE
Filing Requirement of Act 74, Mich. P.A. 1970

SECTION

For corners in WASHTENAW (County)

Located In: T 2 S R 6 E Corner Code # K-2

1. Public Land Survey
ANN ARBOR TWP

2. Property controlling in Section

3. Miscellaneous Property in Sec.

4. Lot No. _____, Recorded Plat _____

5. Private Claims _____

5017340
Page: 1 of 2
02/25/1999 02:59P
L-2 P-244
Peggy M. Haines - Washtenaw Co. CORREM
Register of Deeds Stamp & File Number

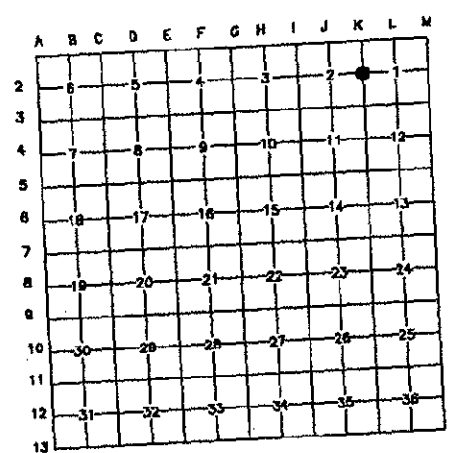

I, LORI E. BEYER, in a field survey on NOVEMBER 14, 19 98, do hereby certify that under requirements of P.A. 74, Michigan P.A. of 1970, the corner points mentioned in lines 1 and 2 above were in conformance with regulations and rules therefore as required in the current manual of survey instructions of the United States Department of the Interior, Bureau of Land Management or by decree of a Court of Law and/or that the corner points mentioned in lines 3, 4 and 5 above were in conformance with the rules of the Michigan Board of Land Surveyors or by Decree of a Court of Law; established, re-established, monumented, re-monumented, recovered, found as expressed below:

E 1/4 CORNER OF SECTION 1 - 1998 REMONUMENTATION PROGRAM

- A. Description of original monument and accessories and/or subsequent restoration:
- | | | |
|---------------|---------|----------------|
| G.L.O. - 1819 | S 10' W | 33 LKS (21.8') |
| 6" W. OAK | N 05' E | 41 LKS (27.1') |
| 13" B. OAK | | |

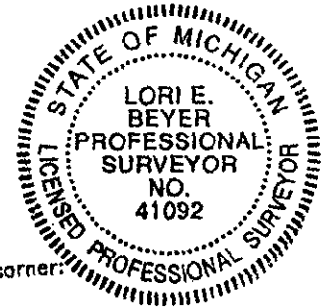

Continued on Back

B. Description of corner evidence and/or method applied in restoring or reestablishing corner:

FOUND 1/2" IRON PIPE 6" BELOW GRAVEL AT CENTERLINE OF EARHART ROAD.

FOUND FIVE (5) REMAINING WITNESSES.

PLACED ALUMINUM REMON. CAP OVER 1/2" IRON PIPE.

- C. Description of monument for corner and accessories established to perpetuate locating the position of the corner:
- | | | | |
|---|---------|--------|---------------------------------------|
| 1/2" IRON PIPE WITH ALUMINUM REMON. CAP | N 34° E | 58.44' | SET MAG NAIL/WASHER E/S |
| (4) 21" HICKORY | S 86° E | 33.64' | SET MAG NAIL/WASHER OVER FD NAIL SW/S |
| (5) 16" WALNUT | N 35° W | 38.04' | SET MAG NAIL/WASHER OVER FD NAIL E/S |
| (10) 20" MAPLE | S 40° W | 40.18' | SET MAG NAIL/WASHER E/S |
| (11) 22" TW. OAK | N 20° E | 62.14' | SET MAG NAIL/WASHER W/S |
| (12) 18" WALNUT | S 22° W | 73.82' | SET MAG NAIL/WASHER OVER FD NAIL E/S |
| (14) 24" W. OAK | S 62° W | 72.03' | SET MAG NAIL/WASHER S/S |
| (15) POWER POLE | N 88° W | 32.97' | |
| (16) 3/4" IP W/A-H CAP | N 88° W | 33.27' | 0.8' S. OF 3/4" I.P. |
| (17) 1" IP - NO CAP | N 32° W | 52.25' | SET MAG NAIL/WASHER OVER FD NAIL E/S |
| (18) 14" ASH | N 50° E | 38.47' | SET MAG NAIL/WASHER W/S |
| (19) 27" WALNUT | S 87° E | 32.87' | NO CAP |
| (20) 1/2" IRON PIPE | | | |

AFTER CAREFUL EXAMINATION OF RECORD DOCUMENTATION AND FIELD OBSERVATIONS, I BELIEVE THIS POINT SHOULD BE ACCEPTED AS THE BEST AVAILABLE EVIDENCE OF THE POSITION OF THE ORIGINAL CORNER.

THIS POINT WAS RATIFIED BY PEER REVIEW COMMITTEE ON DEC. 14, 1998.

Signed by Lori E. Beyer Date Dec 15, 1998

Surveyor's Michigan License No. 41092

APPROVED
DATE: 12-14-98
CO. REP. 19

COPY

K-2



Continued from Section A:

s. Pettibone - 1850'S

(1) 8" B. Oak	N 49° E	42 lks (27.7')
(2) 20" W. Oak	N 31° W	98 lks (64.7')
(3) 20" W. Oak	S 43° E	70 lks (46.2')

-copy-

E.J. Allmendinger & W.J. Armstrong - 1934 - Washtenaw County Road Commission Grid Book
Using a R.O.W. pipe set by some other surveyor, this point with an Iron Pipe and put stones
and brick around it. (As transcribed)

(4) 18" Hickory	N 34° E	58.7'
(5) 10" Walnut	S 81° E	34.3'
(6) 32" W. Oak	S 37° E	48.6'
(7) 4" Y. Oak	S 24° W	65.0'
(8) 32" Y. Oak	N 35° W	61.0'
(9) 32" Y. Oak	N 81° E	50.2'

**SURVEY &
REMONUMENTATION**

NOV 02 1999

SECTION

Atwell Hicks - 1955 - Field Book B-620, P. 36

Sketch of Survey shows found and used for survey. No witnesses posted.

Robert J. Jagow - RLS #6998 - 1976 - Atwell Hicks Inc. - L.C.R.C. L. 4 P. 145 and P.A.132 L.1634, P. 892
Found 1/2" Rerod

(5) 14" B. Walnut	S 80° E	34.7'
(10) 14" Maple	N 35° W	38.6'
(11) 20" Tw. Oak	S 30° W	42.10'
(12) 14" B. Walnut	N 20° E	62.4'

Robert M. Pitts - RLS #10702 - 1987 - L.C.R.C. L. 7, P. 241
Found 1" Iron Pipe

(12) 18" Ash	N 20° E	62.13'	pk nail w/s
(13) 12" Hickory	S 70° E	19.36'	pk nail w/s
(11) 36" Oak	S 46° W	40.52'	pk nail se/s
(10) 20" Maple	N 43° W	38.03'	pk nail ne/s

Richard G. Timmons - RLS # 23319 - 1990 - Atwell Hicks Inc. - P.A. 132 L. 2440 P. 537
Found 1/2" Rerod

(5) 14" B. Walnut	S 80° E	34.7'
(10) 14" Maple	N 36° W	38.6'
(11) 20" Tw. Oak	S 30° W	42.0'
(12) 14" B. Walnut	N 20° E	62.4'