

SURVEY & REMONUMENTATION

MAR 09 1998

RECORDED
#ASHTENAW COUNTY, MI

JAN 22 8 35 AM '98

SECTION

LAND CORNER RECORDATION CERTIFICATE
Filing Requirement of Act 74, Mich, P.A. 1970

PEGGY H. HAINES
COUNTY CLERK/REGISTER

- COPY -

For corner in <u>Washtenaw</u> <small>(County)</small>	Located in:	Corner Code #
1. Public Land Survey	T <u>2S</u> R <u>6E</u>	<u>K-5</u>
	T _____ R _____	_____
	T _____ R _____	_____
	T _____ R _____	_____
2. Property Controlling in Section	S _____ T _____ R _____	_____
	S _____ T _____ R _____	_____
3. Miscellaneous Property in Sec	S _____ T _____ R _____	_____
	S _____ T _____ R _____	_____
4. Lot No. _____, Recorded Plat _____		
5. Private Claims _____		

- COPY -

Liber 00002 Page 0089 RM
Register of Deeds Stamp & File Number

I, Charles C. Wilson, in a field survey on August, 19 97, do hereby certify that under requirements of P.A. 74, Michigan P.A. of 1970, the corner points mentioned in lines 1 and 2 above were in conformance with regulations and rules therefore as required in the current manual of survey instruction of the United States Department of the interior, Bureau of Land Management or by a decree of a Court of Law and/or that the corner points mentioned in lines 3, 4 and 5 above were in conformance with the rules of the Michigan Board of Land Surveyors or by a Decree of a Court of Law; established, re-established, monumented, re-monumented, recovered, found as expressed below.

	A	B	C	D	E	F	G	H	I	J	K	L	M
1													
2	6	5	4	3	2	1							
3													
4	7	8	9	10	11	12							
5													
6	18	17	16	15	14	13							
7													
8	19	20	21	22	23	24							
9													
10	30	29	28	27	26	25							
11													
12	31	32	33	34	35	36							
13													

NOTE: Not more than 4 corners, all in the same town and range, may be recorded on this certificate.

A. Description of original monument and accessories and/or subsequent restoration:

United States Government Survey, 1815 Instructions, Surveyed 1819
Bearing Trees Lynn 14" S25deg.W 9.24
Lynn 14" N20-1/2deg.E 24.42

Continued on Back

B. Description of corner evidence found and/or method applied in restoring or reestablishing corner:

Found 1/2" Iron Pipe with plastic cap stamped #15411, no original accessories available.
Replaced with 3/4" x 18" Iron Pipe with Remonumentation Cap Stamped #13604.

C. Description of monument for corner and accessories established to perpetuate locating the position of the corner:

3/4" x 18" Iron Pipe with Remonumentation Cap Stamped #13604 (4" below grade)
"X" in top bolt of Hydrant S15deg.E 142.11
SW Corner of South end of 4" Brick Wall S45deg.E 110.40
NW Corner of North end of 4" Brick Wall N34deg.E 142.80
4" Wood Fence Post W'ly 16.52 (P.K. Nail)
14" Willow S24deg.E 111.82 (Nail & RT NE/S)
14" Oak S15deg.W 394.44 (Nail & RT W/S)
In center of Gravel Lane at Domino Farms

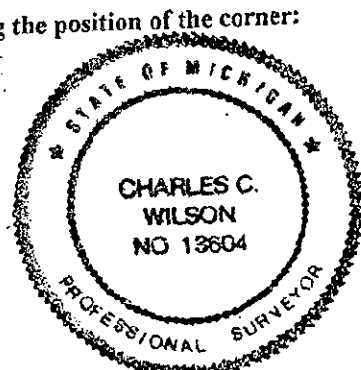

I feel that this point should be accepted as a careful and faithful perpetuation of the position of the original corner.
This corner was ratified by the Peer Group on October 27, 1997.

APPROVED
DATE 10/27/97
CO. REP. Ka

Signed by Charles C. Wilson
Surveyors Michigan's License No. 13604

Date October 28, 1997

- COPY -

Paragraph A Continued:

S. Pettibone, 1850 +/-

- (1) 8" B. Ash N62deg.W 42.24
- (2) 30" Elm S53deg.E 77.22

Professor J.B. Davis, Book 514, Page 19, Iron Sleigh Shoe in a Tea Kettle with many stones.

- (2) 36" Elm S53deg.E 76.06
- (3) 6" Thorn Tree N40deg.E 36.96
- (4) 8" Hickory S60deg.E 67.52
- (5) 8" Hickory S5deg.E 151.34

Washtenaw County Road Commission

W.J. Armstrong, PS# 2444, April 1, 1935, Grid Book, Found Mass of Stones around old Iron Tea Kettle with a piece of Cast Sleigh Shoe driven through the bottom. Re-set with 1-1/2" x 36" Iron Pipe.

- (4) 14" Hickory S57deg.E 67.5
- (6) 5" Elm N27deg.E 58.5
- (7) 4" Elm N41deg.E 38.5
- (8) 4" S.W. Oak S73deg.E 87.5
- (9) 6" S.W. Oak S18deg.E 80.7
- (10) 4" Elm N45deg.W 36.9
- (11) 4" Elm N22deg.W 74.6
- (12) 3 Right of Way Pipes

Washtenaw Engineering Co., Inc., Norman N. Fahrner, PS# 17620, May 11, 1992
Previous Land Recordation Certificate, Liber 2, Page 213, Found 1-1/2" Iron Pipe

- (4) 18" Hickory S57deg.E 67.5
- (9) 10" S.W. Oak S18deg.E 80.7
- (13) 30" Maple S17deg.E 87.6

Atwell-Hicks, Inc., Robert J. Jagow, PS# 6998, April 30, 1973

Book 745, Page 58, Found 1-1/2" Iron Pipe

Previous Land Recordation Certificate, Liber 2, Page 611

- (4) 20" Hickory S57deg.E 67.5
- (11) 24" Elm Stump N22deg.W 74.6
- (14) 48" Quad Maple S30deg.E 72.0
- (15) Street Sign S80deg.W 20.4

Atwell-Hicks, Inc., Robert J. Jagow, PS# 6998, May 10, 1973

Survey Drawing Liber 1439, Page 982, Found 1-1/2" Iron Pipe

- (4) 20" Hickory S57deg.E 67.5
- (11) 24" Elm Stump N22deg.W 74.6
- (14) 48" Quad Maple S30deg.E 72.0
- (15) Street Sign S80deg.W 20.4

Washtenaw Engineering Co., Inc., Norman N. Fahrner, PS# 17620, August 20, 1975

Survey Drawing, Found 1-1/2" Iron Pipe

- (4) 20" Hickory S57deg.E 67.5
- (11) 24" Elm Stump N22deg.W 74.6
- (14) 48" Quad Maple S30deg.E 72.0
- (15) Street Sign S80deg.W 20.4

Washtenaw Engineering Co., Inc., Norman N. Fahrner, PS# 17620, November 18, 1976

Survey Drawing, Found 1-1/2" Iron Pipe

- (4) 18" Hickory S57deg.E 67.5
- (9) 10" S.W. Oak S18deg.E 80.7
- (13) 30" Maple S17deg.E 87.6

McNamee, Porter & Seely, Arvin N. Butterfield, PS# 21561, January 19, 1981

Previous Land Recordation Certificate, Liber 6, Page 125, Found 1-1/2" Iron Pipe 1' below Gravel Road surface

- (16) 12" Twin Beech S10deg.E 87.98
- (17) 6" Beech S10deg.W 9 0.42
- (18) 6" Oak N80deg.E 158.96
- (19) 16" Oak S80deg.E 139.43'
- (20) Corner Fence Post West 34.0

Midwestern Consulting, Inc., Allen R. Rentschler, PS# 15411, October 24, 1983

Survey Drawing, Found 1-1/2" Iron Pipe

- (4) 18" Hickory S57deg.E 67.5
- (9) 10" Oak S18deg.E 80.7
- (13) 30" Maple S17deg.E 87.60
- (16) 12" Twin Maple S10deg.E 87.98

McNamee, Porter & Seely, Arvin N. Butterfield, PS# 21561, November 29, 1983

Survey Drawing, Found 1-1/2" Iron Pipe. This is a composite drawing of approximately 50 individual surveys

- (16) 14" Twin Maple S10deg.E 87.98
- (17) 6" Beech S10deg.W 9 0.42
- (18) 6" Oak N80deg.E 158.96
- (19) 16" Oak S80deg.E 139.43'
- (20) Corner Fence Post West 34.0

McNamee, Porter & Seeley

Arvin N. Butterfield, PS# 21561, Donald J. Bendzinski, PS# 35989, 1983-1995

Survey Drawings (3+-), Found 1-1/2" Iron Pipe. See composite drawings.

- (16) 14" Twin Maple S10deg.E 87.98
- (17) 6" Beech S10deg.W 9 0.42
- (18) 6" Oak N80deg.E 158.96
- (19) 16" Oak S80deg.E 139.43'
- (20) Corner Fence Post West 34.0