

REMONUMENTATION

REMONUMENTATION
LAND CORNER RECORDATION CERTIFICATE
Filing Requirement of Act 74, Mich. P.A. 1970

MAY 05 1997

RECORDED
WASHTENAW COUNTY, MI
PEOPLE'S PAINES
COUNTY CLERK/REGISTER

FEB 18 9 02 AM '97

RECORDED
WASHTENAW COUNTY, MI

For corners in
Washtenaw
(county)

Located In

Corner Code #

1. Public Land Survey	T 3S	R 3E	M-13
	T	R	
	T	R	
	T	R	
	T	R	
2. Property Controlling S in Section	T	R	
	T	R	
3. Miscellaneous S Property in Sec.	T	R	
	T	R	

Liber 000001 Page 05792

Register of Deeds Stamp & File Number

4. Lot No. _____, Recorded Plat _____
5. Private Claims _____

I, R.T. Tietsema, in a field survey on September 30 19 96, do hereby certify that under the requirements of P.A. 74, Michigan P.A. of 1970, the corner points mentioned in lines 1 and 2 above were in conformance with the regulations and rules therefore as required in the current manual of survey instructions of the United States Department of the Interior, Bureau of Land Management of by a decree of a Court of Law and/or that the corner points mentioned in lines 3, 4, and 5 above were in conformance with the rules of the Michigan Board of Land Surveyors or by a Decree of a Court of Law; established, re-established, monumented, recovered, found as expressed below.

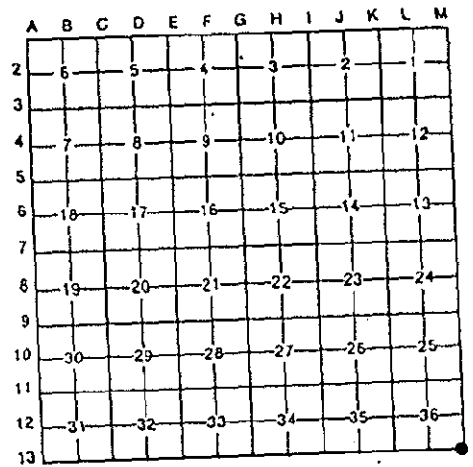

NOTE: Not more than 4 corners, all in the same town and range, may be recorded on this certificate

A. Description of original monument and accessories and/or restoration:

W. Oak stands for corner of Sections 22, 23, 26 & 27. 1816 GLO (Fletcher)	Fld. Notes	10" W. Oak	no witnesses
6/4/1935 Armstrong	Resurvey (grid book)	Found US Corner Tree 10" W. Oak still standing, now 31" in diameter	1) 10" Hickory N00E 43.70' 2) 5" Hickory S65E 9.70' 3) 6" Hickory N10W 31.60' 4) 7" Hickory N02W 33.0' 5) 6" Hickory N01W 30.80' 6) 6" Hickory N80W 34.80'

B. Description of corner evidence found and/or method applied in restoring or reestablishing corner:

Found 36" W. Oak as U.S. Corner Tree. 43.80'

1) 16" Hickory N05E 31.70'

3) 11" Hickory N12W 35.10'

6) 18" Stump N80W 20.40'

7) 17" Hickory N00W 27.10'

8) 16" Hickory S85E 48.90'

9) 44" Twin Linden S00W 15.00'

10) Reference Iron S89°43'20E 15.00'

11) Reference Iron N02°18'26W 15.00'

12) Reference Iron N89°43'20W 15.00'

13) Reference Iron S02°18'26E 25.00'

In July of 1996, LSC found a 36" W. Oak in good condition at the intersection of fences running N-S & W'ly reported as occupying the actual location of the original corner (M-13, Cor. Sec. 36) and verified using three (3) of Armstrong's witnesses. LSC set four (4) reference Irons (1/2" Pipes with Remon. Caps) described as: 1) 15' E. of corner on S. line of Sec. 36 0.5' S. of E/W fence, 2) 15' N. of corner on E. line of Sec. 36 in down fence, 3) 15' W. of corner on S. line of Sec. 36 extended in rocks, 4) 25' S. of corner on E. line of Sec. 36 extended in rocks 1.80' E. of N/S fence.

C. Description of monument for corner and accessories established to perpetuate locating the position of the corner:

36" White Oak standing in good condition as the actual corner.

Set additional accessories:

1) 16" Hickory N05E 43.80' to nail & R.T.

3) 11" Hickory N12W 31.70' to nail & R.T.

6) 18" Stump N80W 35.10' to center.

7) 17" Hickory N00W 20.40' to nail & R.T.

8) 16" Hickory S85E 27.10' to nail & R.T.

9) 44" Twin Linden S00W 48.90' to nail & R.T.

10) Reference Iron S89°43'20E 15.00' to 1/2" Pipe w/remon cap 15' E. of corner on S. line of Sec. 36 0.5' S. of E/W fence (see sketch).

11) Reference Iron N02°18'26W 15.00' to 1/2" Pipe w/remon cap 15' N. of corner on E. line of Sec. 36 in down fence (see sketch).

12) Reference Iron N89°43'20W 15.00' to 1/2" Pipe w/remon cap 15' W. of corner on S. line of Sec. 36 extended in rocks (see sketch).

13) Reference Iron S02°18'26E 25.00' to 1/2" Pipe w/remon cap 25' S. of corner on E. line of Sec. 36 extended in rocks 1.80' E. of N/S fence (see sketch).

It is our opinion that this Tree is the original corner.

Signed by [Signature] Date DEC 02 1996
Surveyor's Michigan License No. 20712

FORM APPROVED BY MICHIGAN STATE BOARD OF LAND SURVEYORS, JAN. 28 11
REVISED MAY 14, 11
REVISED JAN., 11

APPROVED
DATE 11-11-96
CO. REP. [Signature]

COPY

NW CORNER
SECTION 36
T3S,R3E

N 1/4 CORNER
SECTION 36
T3S,R3E

NE CORNER
SECTION 36
T3S, R3E

LIDER 000001 1996 000001

11

12

SEC. 31
T3S, R4E
T4S, R4E
SEC. 6

13

2728.46' (Atw.-Hicks, 1979)
2728.48' (C.Wilson & Assoc., 1993)
2728.70' (LSC, 1996)

2722.38' (LSC, 1996)
86°35'14" (LSC, 1996)

180°00'21" (LSC, 1996)

90°41'18" (LSC, 1996)

2680.47' (LSC, 1982)
2680.27' (Wash. Eng., 1988)
2680.13' (LSC, 1996)

2701.51' (Wash. Eng., 1989)

2665.99' (LSC, 1996)

179°59'56" (LSC, 1996)

184°47'48" (LSC, 1996)

W 1/4 CORNER
SECTION 36
T3S,R3E

W 1/4 CORNER
SECTION 36
T3SR3E

2679.61' (LSC, 1996)

2785.13' (LSC, 1996)

REFERENCE IRONS
SEE DETAIL

89°56'01" (LSC, 1996)

180°34'29" (LSC, 1996)

87°24'54" (LSC, 1996)

2713.92' (LSC, 1996)

2711.34' (LSC, 1996)

SW CORNER
SECTION 36
T3S,R3E

NW CORNER
SECTION 1
T4S, R3E

S 1/4 CORNER
SECTION 36
T3S, R3E

N 1/4 CORNER
SECTION 1
T4S, R3E

SE CORNER
SECTION 36
T3S,R3E

7.03' (Atw.-Hicks, 1970)

3.32' (LSC, 1987)
3.33' (LSC, 1987)

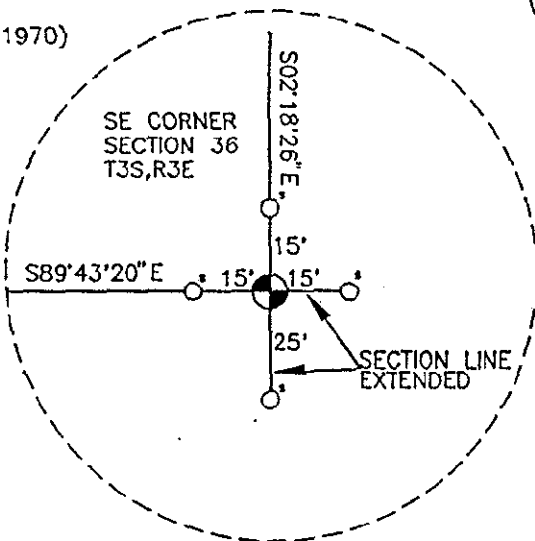

DETAIL
NOT TO SCALE

LEGEND

- SECTION CORNER
- 1/2" IRON PIPE W/REMON. CAP
- SET



SCALE
0 800 FT.

Washtenaw County
Remonumentation
Section 36, Sharon Township
T3S, R3E (M-13)

SCALE: 1"=800

Fld. Bk: X
Pg: X
Drm. By: BBB
Ckd. By: RTT

By:
By: R. TIMOTHY TIETSEMA
Professional Surveyor No. 20712



LAND SURVEYING CONSULTANTS

Client: Washtenaw County
Job No:01196-3S3E36

Date: July, 1996
Issued:
Sheet: 1 of 1

SURVEY ENGINEERING
P.O. BOX 65, 3225 CENTRAL ST.
DEXTER, MICHIGAN
(313) 426-3306 (313) 761-6577