

MAY - 1 1995

LAND CORNER RECORDATION CERTIFICATE

COMMISSION Filing Requirement of Act 74, Mich. P.A. 1970

For corners in

Washtenaw (County)

Located In:

Corner Code #

| | | | | | |
|------------------------------------|---|----|---|----|------|
| 1. Public Land Survey | T | 4S | R | 6E | L-11 |
| | T | | R | | |
| | T | | R | | |
| | T | | R | | |
| 2. Property Controlling in Section | S | | T | R | |
| | S | | T | R | |
| 3. Miscellaneous Property in Sec. | S | | T | R | |
| | S | | T | R | |

RECORDED
 WASHTEENAW COUNTY, MI
 SEP 21 11 20 AM '94
 REGIST. M. HAINES
 COUNTY CLERK/REGISTRAR

LIBER 1 PAGE 68 RM
 -COPY-
 Register of Deeds Stamp & File Number

- 4. Lot No. _____, Recorded Plat _____
- 5. Private Claims _____

I, Patrick Hastings, in a field survey on December 27, 19 93, do hereby certify that under requirements of P.A. 74, Michigan P.A. of 1970, the corner points mentioned in lines 1 and 2 above were in conformance with regulations and rules therefore as required in the current manual of survey instructions of the United States Department of the Interior, Bureau of Land Management or by a decree of a Court of Law and/or that the corner points mentioned in lines 3, 4 and 5 above were in conformance with the rules of the Michigan Board of Land Surveyors or by a Decree of a Court of Law; established, re-established, monumented, re-monumented, recovered, found as expressed below:

| A | B | C | D | E | F | G | H | I | J | K | L |
|----|----|----|----|----|----|----|---|---|---|---|---|
| 2 | 6 | 5 | 4 | 3 | 2 | 1 | | | | | |
| 3 | | | | | | | | | | | |
| 4 | 7 | 8 | 9 | 10 | 11 | 12 | | | | | |
| 5 | | | | | | | | | | | |
| 6 | 18 | 17 | 16 | 15 | 14 | 13 | | | | | |
| 7 | | | | | | | | | | | |
| 8 | 19 | 20 | 21 | 22 | 23 | 24 | | | | | |
| 9 | | | | | | | | | | | |
| 10 | 30 | 29 | 28 | 27 | 26 | 25 | | | | | |
| 11 | | | | | | | | | | | |
| 12 | 31 | 32 | 33 | 34 | 35 | 36 | | | | | |
| 13 | | | | | | | | | | | |

NOTE: Not more than 4 corners, all in the same town and range, may be recorded on this certificate.

A. Description of original monument and accessories and/or subsequent restoration:

| | | |
|------|------------------|---|
| 1819 | J. Francis, D.S. | Set post at 40.25 chains |
| | Hickory 14" | N 76° E 27 lks |
| | Elm 12" | S 62° E 21 lks |
| 1934 | W. Armstrong | found a black streak about 2" sq. which ran straight down in sandy subsoil. Reset with a 1 1/2" x 42" iron pipe with stones and bricks around it. |
| (1) | N 72 1/2° W | 72.2' 12" B. Walnut |
| (2) | S 74° E | 88.8' 5" Cherry |
| (3) | S 56° W | 149.5' 12" Apple |

CONTINUED ON BACK

B. Description of corner evidence found and/or method applied in restoring or reestablishing corner:

| | | |
|------|------------------------|---|
| 1993 | Found 1 1/4" iron pipe | over a 1/2" x 30" iron pipe at surface of concrete road. In front of house #4014. |
| (5) | North | 33.0' R/W iron |
| (6) | South | 33.0' R/W iron |
| (10) | S 35° E | 34.73' Fire hydrant |
| (12) | S 10° W | 88.27' N.W. cor. of house |
| (17) | S 65° W | 53.88' N.W. cor. of end of sidewalk |
| (18) | North | 1.85' C/L joint Arkona Road |

C. Description of monument for corner and accessories established to perpetuate locating the position of the corner:

After a careful study of the record documentation and field observations, I believe this to be a careful and faithful perpetuation of the position of the original corner.

CONTINUED ON BACK

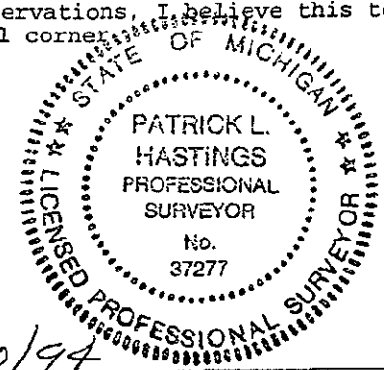

Signed by Patrick L. Hastings Date 8/30/94
 Surveyor's Michigan License No. 37277

SECTION 'A' CONTINUED

LIBER 1 PAGE 69RM
-COPY-

| | | | | |
|---------|---|-----------|----------|--|
| 1934 | (4) | S 70° W | 181.7' | 12" Apple |
| | (5) | North | 33.0' | R/W iron |
| | (6) | South | 33.0' | R/W iron |
| 1934 | W.C.R.C. Gridbook, Plat | | | |
| | (7) | West | 2660.0' | Corner common to 26, 25 and 35, 36 |
| | (8) | East | 1328.0' | Iron at centerline "X" of Arkona Road and Sanford Road |
| No Date | Witness by Atwell-Hicks | | | |
| | (7) | West | 2650.0' | Corner common to 26, 25 and 35, 36: 1 1/2" pipe |
| | (9) | S 76° E | 95.30' | 16" W. Cherry |
| | (10) | S 35° E | 34.73' | Fire hydrant |
| | (11) | S 34° E | 58.68' | 16" Willow |
| | (12) | S 10° W | 88.27' | N.W. cor. of house |
| | (13) | S 28° W | 51.71' | 17" Willow |
| | (14) | S 61° W | 82.92' | 17" Box Elder |
| | (15) | N 08° E | 29.72' | 12" W. Cherry |
| | (16) | N 83° E | 79.16' | 18" Walnut |
| 1969 | Field notes by A. Rentschler & survey drawing. Set N 1/4 corner per original witnesses, chiseled hole in concrete pavement. | | | |
| | (5) | North | 33.0' | R/W Iron |
| | (8) | East | 1328.30' | F.I.P. |
| 1981 | L.C.R.C. by D. Hooth, L.6, Pg. 169. Found 1 1/4" iron pipe in conc. road (Arkona) | | | |
| | (10) | S 30° E | 34.69' | Fire hydrant |
| | (16) | N 70° E | 79.25' | 27" Walnut M.S.H.D. ref. tag |
| | (17) | S 65° W | 53.88' | N.E. cor. of end of sidewalk |
| | (18) | North | 1.85' | C/L joint Arkona Road |
| 1990 | Field notes by Midwestern Consulting, Inc. | | | |
| | (10) | S 30° E | 34.69' | Fire hydrant |
| | (13) | S 3028° W | 50.93' | 42" Willow, set P.K. |
| | (19) | North | 45.67' | 10" Clump Walnuts, set P.K. |

SECTION 'C' CONTINUED

| | | | | |
|------|--|---------|--------|------------------------------|
| 1993 | Set 1" x 24" iron pipe and Washtenaw County Remonumentation cap, stamped #37277 in a monument box. | | | |
| | (5) | North | 33.0' | R/W Iron |
| | (5) | South | 33.0' | R/W iron |
| | (10) | S 35° E | 34.73' | Fire hydrant |
| | (12) | S 10° W | 88.27' | N.W. cor. of house |
| | (17) | S 65° W | 53.88' | N.W. cor. of end of sidewalk |
| | (18) | North | 1.85' | C/L joint Arkona Road |

APPROVED

DATE 2/22/94

REP. KA