

SURVEY &  
REMONUMENTATION

MAY - 1 1995

**LAND CORNER RECORDATION CERTIFICATE**  
Filing Requirement of Act 74, Mich. P.A. 1970

For corners in **COMMISSION**

<u>WASHTENAW</u> <small>(County)</small>	Located In:	Corner Code - #
1. Public Land Survey	T <u>4S</u> R <u>6E</u>	<u>M-9</u>
	T _____ R _____	_____
	T _____ R _____	_____
	T _____ R _____	_____
2. Property Controlling in Section	S _____ T _____ R _____	_____
	S _____ T _____ R _____	_____
3. Miscellaneous Property in Sec.	S _____ T _____ R _____	_____
	S _____ T _____ R _____	_____

4. Lot No. \_\_\_\_\_, Recorded Plat \_\_\_\_\_  
5. Private Claims \_\_\_\_\_

I, Patrick Hastings, in a field survey on December 23, 19 93, do hereby certify that under requirements of P.A. 74, Michigan P.A. of 1970, the corner points mentioned in lines 1 and 2 above were in conformance with regulations and rules therefore as required in the current manual of survey instructions of the United States Department of the Interior, Bureau of Land Management or by a decree of a Court of Law and/or that the corner points mentioned in lines 3, 4 and 5 above were in conformance with the rules of the Michigan Board of Land Surveyors or by a Decree of a Court of Law; established, re-established, monumented, re-monumented, recovered, found as expressed below:

**NOTE: Not more than 4 corners, all in the same town and range, may be recorded on this certificate.**

A. Description of original monument and accessories and/or subsequent restoration:

1815	G.L.O. Survey by:	Set post at 80 chains
	Sugar 18" N 29° E	9 lks
	Sugar 24" S 22° W	26 lks
1819	G.L.O. Survey by: J. Francis	Intersected east boundary
No Date	W.C.R.C. Gridbook by Pettibone	
	Beech 9" S 76 1/2° E	15 lks
	Beech 10" N 38° W	23 lks

CONTINUED ON BACK

B. Description of corner evidence found and/or method applied in restoring or reestablishing corner:

1993	Found 1 1/2" iron pipe surrounded with brick in good condition. Occupation line N.S. & W. Open field to east.
* (2)	N 10° W 25.12' 30" Oak - Found a magnetic draw at record dist., blazed tree to black stain. Set PK in stain.
* (3)	N 50° W 11.40' 36" Ash - Found a magnetic draw at record dist., blazed tree, did not find black stain. Set PK.
* (6)	S 30° E 172.0' ± Fence corner post.
* (7)	S 30° W 172.5' ± Fence corner post, leaning greatly.

C. Description of monument for corner and accessories established to perpetuate locating the position of the corner:

After a careful study of the record documentation and field measurements, made under my direct supervision, I find this corner as remonumented to be the best available evidence of the position of the original corner.

Set 1" x 14" iron pipe in found 1 1/2" iron pipe and standard remonumentation cap stamped #37277.

* (2)	N 10° W	25.12'	30" Oak blazed to P.K. nail & R.T.
* (3)	N 50° W	11.40'	36" Ash blazed to P.K. nail & R.T.
(8)	S 05° E	10.71'	6" Elm blazed to P.K. nail & R.T.
(9)	S 08° W	36.67'	8" Elm blazed to P.K. nail & R.T.

Signed by Patrick L. Hastings Date 6/27/94  
Surveyor's Michigan License No. 37277

RECORDED  
WASHTENAW COUNTY, MI  
SEP 21 11 20 AM '94  
PEGGY H. HAINES  
COUNTY CLERK/REGISTER  
**COPY**  
LIBER 1 PAGE 72RM  
**-COPY-**  
Register of Deeds Stamp & File Number

	A	B	C	D	E	F	G	H	I	J	K	L	I
2	6	5	4	3	2	1							
3													
4	7	8	9	10	11	12							
5													
6	18	17	16	15	14	13							
7													
8	19	20	21	22	23	24							
9													
10	30	29	28	27	26	25							
11													
12	31	32	33	34	35	36							
13													

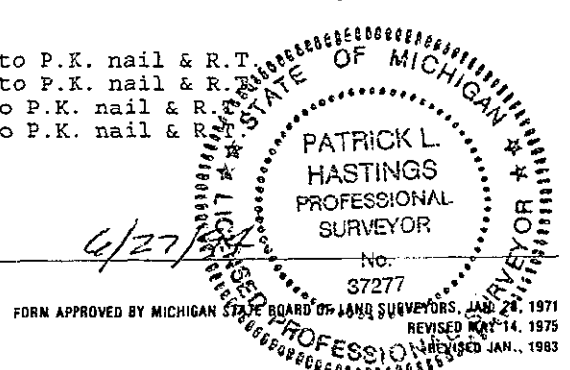

SECTION 'A' CONTINUED

No Date by Armstrong; 1 1/2" x 40" Iron Pipe

No date

(1)	N 08° W	50.7'	16" Twin Elms
(2)	N 15° W	25.1'	5" S.W. Oak
(3)	N 50° W	11.4'	6" Ash
(4)	N 84° W	24.5'	24" Elm
(5)	N 84° W	35.6'	8" S.W. Oak

1969 Survey by American Eng.; Traverse Point  
 1972 L.C.R.C. by G. Richard; Found iron pipe, stone and brick in April of 1970

* (2)	N.N.W.	25.12'	18" Oak, to nail
* (3)	N.W.	11.14'	22" Oak, to nail

1977 Survey by Roskelly; Fd. Iron Pipe

1977 Witness sheet by Roskelly; 1 1/2" I.P.

* (2)	N 10° W	25.12'	24" Oak, to P.K.
* (3)	N 50° W	11.4'	30" Ash, to P.K.
(6)	S 30° E	172.05'	Fence corner post
(7)	S 30° W	172.45'	Fence corner post

APPROVED  
 DATE 2/8/94  
 CO. REP. K