

MAY 06 2000

SECTION

LAND CORNER RECORDATION CERTIFICATE  
Filing Requirement of Act 74, Mich. P.A. 1970

For corners in

<u>WASHTENAW</u> (County)	Located in:	Corner Code #
1. Public Land Survey AUGUSTA TWP	T <u>4S</u> R <u>7E</u>	<u>E-8</u>
2. Property controlling in Section	T _____ R _____	
3. Miscellaneous Property in Sec.	S _____ T _____ R _____	
4. Lot No. _____, Recorded Plat _____	S _____ T _____ R _____	
5. Private Claims _____		

5094696  
Page: 1 of 2  
02/07/2000 02:55P  
L-2 P-266  
Peggy M. Haines - Washtenaw Co. CORREM  
Register of Deeds Stamp & File Number

A	B	C	D	E	F	G	H	I	J	K	L
2	6	5	4	3	2	1					
3											
4	7	8	9	10	11	12					
5											
6	16	17	18	15	14	13					
7											
8	19	20	21	22	23	24					
9											
10	30	29	28	27	26	25					
11											
12	31	32	33	34	35	36					
13											

I, LORI E. BEYER, in a field survey on OCTOBER 03, 19 99, do hereby certify that under requirements of P.A. 74, Michigan P.A. of 1970, the corner points mentioned in lines 1 and 2 above were in conformance with regulations and rules therefore as required in the current manual of survey instructions of the United States Department of the Interior, Bureau of Land Management or by decree of a Court of Law and/or that the corner points mentioned in lines 3,4 and 5 above were in conformance with the rules of the Michigan Board of Land Surveyors or by Decree of a Court of Law; established, re-established, monumented, re-monumented, recovered, found as expressed below:

1999 REMONUMENTATION CORNER

A. Description of original monument and accessories and/or subsequent restoration:  
G.L.O. - JOSEPH FRANCIS - 1819  
SET POST  
12" ELM NORTH 8 LINKS  
6" ELM S 22° W 23 LINKS

Continued on Back

B. Description of corner evidence and/or method applied in restoring or reestablishing corner:  
FOUND 3/4" IRON PIPE 3" BELOW GRAVEL. PULLED, DUG 24" AND FOUND NOTHING ELSE BELOW 3/4" x 12" IRON. NO WITNESSES REMAIN. CULVERT FOUND APPEARS RELATIVELY NEW.  
FARM FIELD WITH NO OCCUPATION LINE TO WEST, SWAMP WITH OBSCURE OCCUPATION LINE TO EAST.  
RESET 3/4" x 18" IRON PIPE 6" BELOW GRAVEL WITH ALUMINUM REMON. CAP STAMPED '41092'.

C. Description of monument for corner and accessories established to perpetuate locating the position of the corner:  
3/4" x 18" IRON PIPE WITH ALUMINUM REMON. CAP STAMPED '41092' 6" BELOW GRAVEL.  
PIPE IS 3' EAST OF CL OF HITCHINGHAM ROAD.

- |                           |         |         |                        |
|---------------------------|---------|---------|------------------------|
| 4) E. END 12" CMP CULVERT | N 50° E | 13.29'  | TO PUNCH MARK          |
| 5) W. END 12" CMP CULVERT | N 60° W | 26.25'  | TO PUNCH MARK          |
| 6) ROAD SIGN              | S 31° W | 42.6'   |                        |
| 7) 42" S. MAPLE           | N 01° W | 435.57' | SET NAIL/TAG EAST SIDE |
| 8) P. POLE                | S 05° W | 739.66' | SET NAIL/TAG EAST SIDE |

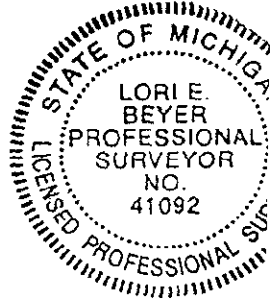

AFTER CAREFUL EXAMINATION OF RECORD DOCUMENTATION AND FIELD OBSERVATIONS, I BELIEVE THIS POINT SHOULD BE ACCEPTED AS THE BEST AVAILABLE EVIDENCE OF THE POSITION OF THE ORIGINAL CORNER.  
THIS CORNER WAS RATIFIED BY THE PEER REVIEW COMMITTEE ON NOVEMBER 22, 1999.

Signed by Lori E. Beyer  
Surveyor's Michigan License No. 41092

Date Dec 03, 1999

APPROVED  
DATE 11/22/99  
CO. REP. EB

- Copy -



5094696  
Page: 2 of 2  
02/07/2000 02:55P  
L-2 P-267

Peggy M. Haines - Washtenaw Co. CORREM

E-8 CONTINUED FROM PARAGRAPH A

WASHTENAW COUNTY GRID BOOK - NO WITNESSES POSTED - NO ARMSTRONG WITNESSES FOUND.

L.C.R.C. LIBER 1 PAGE 295 - KENNETH L. SUYDAM #17636 - OCTOBER 1971

FOUND 3/4" IRON PIPE

1) EAST END CORR. IRON CULVERT	E-NE	11.20'
2) WEST END CORR. IRON CULVERT	W-NW	21.95'

L.C.R.C. LIBER 2 PAGE 301 - HOWARD W. TAFT #12032 - AUGUST 1972

FOUND 3/4" IRON PIPE

3) 48" W. MAPLE	N 05° W	346.0'
1) E. END CULVERT	N 60° E	11.2'
2) W. END CULVERT	N 60° W	21.9'

WASHTENAW COUNTY ROAD COMMISSION - FIELD BOOK - ROBERT CAMPBELL, JR. #13028 - JUNE 1981  
FOUND 3/4" IRON PIPE AT ROAD SURFACE. LOWERED TO 5" BELOW ROAD SURFACE.

3) 48" W. MAPLE	N 02° W	346.3'
1) E. END CULVERT	N 61° E	11.2'
2) W. END CULVERT	N 70° W	21.9'

SURVEY &  
REPRESENTATION

MAY 06 2000

SECTION