

REC

MAY 10 2000

SECTION

LAND CORNER RECORDATION CERTIFICATE
Filing Requirement of Act 74, Mich. P.A. 1970

For corners in

WASHTENAW
(-County)

Located In:

Corner Code #

- 1. Public Land Survey T 4S R 7E AUGUSTA TWP
2. Property controlling in Section S T R
3. Miscellaneous Property in Sec. S T R



Page: 1 of 2
02/07/2000 02:55P

Peggy M. Haines - Washtenaw Co. CORREM L-2 P-286

Register of Deeds Stamp & File Number

- 4. Lot No. , Recorded Plat
5. Private Claims

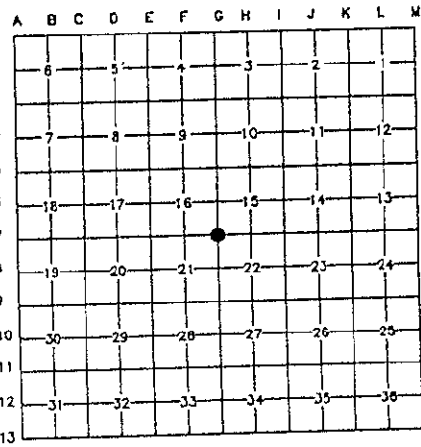

I, LORI E. BEYER, in a field survey on OCTOBER 31, 19 99, do hereby certify that under requirements of P.A. 74, Michigan P.A. of 1970, the corner points mentioned in lines 1 and 2 above were in conformance with regulations and rules therefore as required in the current manual of survey instructions of the United States Department of the Interior, Bureau of Land Management or by decree of a Court of Law and/or that the corner points mentioned in lines 3,4 and 5 above were in conformance with the rules of the Michigan Board of Land Surveyors or by Decree of a Court of Law; established, re-established, monumented, re-monumented, recovered, found as expressed below:

1999 REMONUMENTATION CORNER

A. Description of original monument and accessories and/or subsequent restoration:

G.L.O. - JOSEPH FRANCIS - 1819
SET POST
16" RED OAK N 73° E 25 LINKS
16" POPLAR S 39° W 27 LINKS

Continued on Back

B. Description of corner evidence and/or method applied in restoring or reestablishing corner:

FOUND PK NAIL 3.5 FEET WEST OF CENTERLINE OF WHITTAKER ROAD. WITNESSED, REMOVED, AND DUG FINDING A SECOND PK NAIL 2" BELOW PAVEMENT. REMOVED AND FOUND NO MAGNETIC PULL BELOW. RESET PK NAIL. RESET PK NAIL WITH 3/4" x 24" IRON PIPE IN MONUMENT BOX. PLACED ALUMINUM REMON. CAP STAMPED #41092 ON 3/4" IRON PIPE.

C. Description of monument for corner and accessories established to perpetuate locating the position of the corner:

3/4" x 18" IRON PIPE WITH ALUMINUM REMON. IN MONUMENT BOX 3.5' WEST OF THE CENTERLINE OF WHITTAKER ROAD AND ON CENTERLINE OF TALLADAY ROAD.

- 7) NW COR HOUSE S 42° E 73.32' SET NAIL/TAG WEST SIDE
8) 50" MAPLE S 20° E 67.32' SET NAIL/TAG WEST SIDE
19) TELEPHONE POLE N 35° E 41.70' SET NAIL/TAG EAST SIDE (NEW POLE)
23) UTILITY POLE S 40° W 39.65' TOP NUT
22) FIRE HYDRANT N 52° E 45.23' SET NAIL/TAG NORTH FACE
18) UTILITY POLE N 55° W 53.64' N'LY CORNER
21) PUMP STATION S 60° W 67.96' CHISELED X IN TOP
24) CONC. MONUMENT N 45° E 38.92'

AFTER CAREFUL EXAMINATION OF RECORD DOCUMENTATION AND FIELD OBSERVATIONS, I BELIEVE THIS CORNER SHOULD BE ACCEPTED AS THE BEST AVAILABLE EVIDENCE OF THE POSITION OF THE ORIGINAL CORNER. THIS CORNER WAS RATIFIED BY THE PEER REVIEW COMMITTEE ON NOVEMBER 22, 1999.

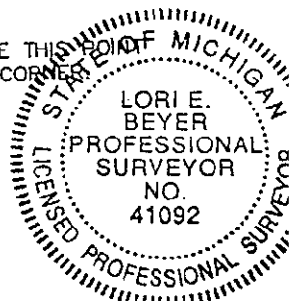

Signed by Lori E. Beyer
Surveyor's Michigan License No. 41092

Date DEC 03, 1999

FORM APPROVED BY MICHIGAN STATE BOARD OF LAND SURVEYORS, JAN. 28, 1998. REVISED MAY 14, 1998. REVISED JAN., 1999.

APPROVED DATE 11/22/99 CO. REP. EJ

SECTION



5094706

Page: 2 of 2
02/07/2000 02:55P

L-2 P-287

G-7 CONTINUED FROM PARAGRAPH A

Peggy M. Haines - Washtenaw Co. CORREM

WASHTENAW COUNTY GRID BOOK - W.J. ARMSTRONG - JUNE 1937
MONUMENT NOT DESCRIBED - RENEWED THE WITNESSES

1) SE COR CONC HDWL	NW'LY	18.6'
2) NE COR CONC HDWL	SW'LY	21.7'
3) 24" BEECH	NE'LY	85.7'
4) NW COR STORE	SE'LY	56.1'
5) 30" MAPLE	N 21° E	102.8'
6) 2" MAPLE	S 54° E	84.7'
7) NW COR HSE	S 42° E	73.3'
8) 2" MAPLE	S 31° E	68.0'
9) 12" WALNUT	S 79° W	125.1'

WASHTENAW COUNTY GRID BOOK - HAND POSTED WITNESSES - NO DATE - NO NAME
MONUMENT NOT DESCRIBED

1) SE COR CONC HDWL	NW'LY	18.6'	
3) 24" BEECH	N 55° E	84.1'	
5) 30" MAPLE	N 21° E	102.8'	
7) NW COR HSE	S 42° E	73.3'	
10) 20" MAPLE	N'LY	42.8'	NAIL
11) 5" CHERRY	N 49° W	52.6'	
8) 12" MAPLE	S 31° E	68.4'	NAIL
12) 16" MAPLE	N 41° W	42.5'	NAIL
13) 20" BOXELDER	S 29° W	91.4'	NAIL

L.C.R.C. LIBER 3 PAGE 423 - HOWARD W. TAFT #12032 - FEBRUARY 1974

FOUND 3/4" IRON PIPE

7) NW COR HSE	S 42° E	73.3'
14) 30" OAK	N 15° E	70.9'
15) 42" OAK	S 68° E	89.3'
16) 14" PINE	N 70° W	79.8'

L.C.R.C. LIBER 3 PAGE 443 - JOHN F. OLIVER #19840 - DECEMBER 1973

P.A. 132 CERTIFICATE OF SURVEY - UNRECORDED - WASHTENAW ENGINEERING - SAME WITNESSES

FOUND IRON PIPE

3) 30" BEECH	N 55° E	84.1'
7) NW COR HSE	S 42° E	73.3'
8) 25" MAPLE	S 31° E	68.4'
17) 12" WALNUT	S 79° W	125.1'

L.C.R.C. LIBER 3 PAGE 499 - WERNER SOMMER #12030 - MARCH 1974

FOUND BOAT SPIKE 3.5' WEST OF CENTERLINE

18) TEL. POLE	N 50° W	55.39'	SPIKE N. SIDE
19) TEL. POLE	N 35° E	41.84'	SPIKE W. SIDE
20) E. POLE	S 45° W	38.15'	SPIKE E. SIDE
7) NW COR HSE	S 40° E	73.30'	

P.A. 132 CERTIFICATE OF SURVEY - UNRECORDED - WASHTENAW ENGINEERING - 1976 - SAME AS LCRC L. 3 P. 443

P.A. 132 CERTIFICATE OF SURVEY - UNRECORDED - WASHTENAW ENGINEERING - 1976 - SAME AS LCRC L. 3 P. 443

L.C.R.C. LIBER 7 PAGE 215 - DENNIS GRIGGS #23511 - APRIL 1988

FOUND PK NAIL 3.5 FEET WEST OF CENTERLINE OF WHITTAKER ROAD

21) PUMP STATION	S 60° W	66.2'	N'LY CORNER
18) TELEPHONE POLE	N 55° W	53.70'	NAIL/TAG NORTH SIDE
22) FIRE HYDRANT	N 46° E	45.35'	
7) NW COR HOUSE	S 42° E	73.3'	

P.A. 132 CERTIFICATE OF SURVEY - LIBER 2937 PAGE 838 - JOHN BLANCHARD #27446 - JANUARY 1994

P.A. 132 CERTIFICATE OF SURVEY - LIBER 03432 PAGE 796 - JOHN BLANCHARD #27446 - JANUARY 1994

P.A. 132 CERTIFICATE OF SURVEY - LIBER 03327 PAGE 774 - JOHN BLANCHARD #27446 - SEPTEMBER 1996

(MONUMENT NOT DESCRIBED - NO WITNESSES POSTED)

WASHTENAW COUNTY ROAD COMMISSION - FIELD BOOK - KEVIN ANDERSON P.S. - 1995?

DID NOT FIND NAIL. RESET PK NAIL FROM WITNESSES.

21) PUMP STATION	S 60° W	66.20'	N'LY CORNER
18) UTILITY POLE	N 55° W	53.70'	FD NAIL NORTH SIDE
22) FIRE HYDRANT	N 45° E	45.35'	TOP
7) NW COR HOUSE	S 45° E	73.30'	
20) E. POLE	S 45° W	38.15'	SPIKE E. SIDE

L.C.R.C. LIBER 8 PAGE 152 - GRANT WARD #22445 - JUNE 1995

FOUND PK NAIL

21) PUMP STATION	S 60° W	66.20'	N'LY CORNER
18) UTILITY POLE	N 55° W	53.70'	FD NAIL NORTH SIDE
22) FIRE HYDRANT	N 45° E	45.35'	TOP
7) NW COR HOUSE	S 45° E	73.30'	

P.A. 132 CERTIFICATE OF SURVEY - LIBER 3522 PAGE 285 - ATWELL HICKS - OCTOBER 1997

FOUND PK NAIL

21) PUMP STATION	S 60° W	67.69'	N'LY CORNER
18) TELEPHONE POLE	N 55° W	53.65'	FD NAIL NORTH FACE
22) FIRE HYDRANT	N 45° E	45.35'	TOP
7) NW COR HOUSE	S 45° E	73.25'	
19) TELEPHONE POLE	N 30° E	42.79'	NAIL NW FACE