

REF

2000

SECTION

LAND CORNER RECORDATION CERTIFICATE  
Filing Requirement of Act 74, Mich. P.A. 1970

For corners in

WASHTENAW  
(County)

Located In:

Corner Code #

1. Public Land Survey  
AUGUSTA TWP

T 4S R 7E

H-7

2. Property controlling  
in Section

S T R

3. Miscellaneous  
Property in Sec.

S T R

4. Lot No. \_\_\_\_\_, Recorded Plat \_\_\_\_\_  
5. Private Claims \_\_\_\_\_



5094713  
Page: 1 of 2  
02/07/2000 02:55P  
CORREM L-2 P-300

Peggy M. Haines - Washtenaw Co.

Register of Deeds Stamp & File Number

Copy

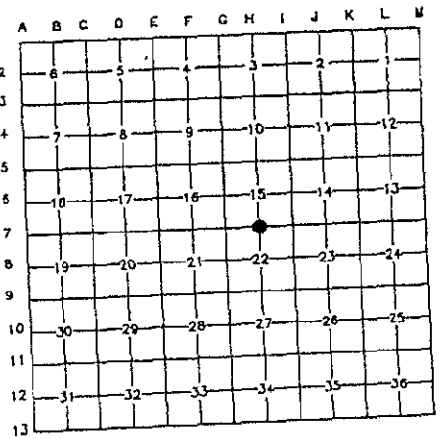

I, LORI E. BEYER, in a field survey on OCTOBER 31, 19 99, do hereby certify that under requirements of P.A. 74, Michigan P.A. of 1970, the corner points mentioned in lines 1 and 2 above were in conformance with regulations and rules therefore as required in the current manual of survey instructions of the United States Department of the Interior, Bureau of Land Management or by decree of a Court of Law and/or that the corner points mentioned in lines 3, 4 and 5 above were in conformance with the rules of the Michigan Board of Land Surveyors or by Decree of a Court of Law; established, re-established, monumented, re-monumented, recovered, found as expressed below:

1999 REMONUMENTATION CORNER

A. Description of original monument and accessories and/or subsequent restoration:

G.L.O. - JOSEPH FRANCIS - 1819

SET POST  
12" LYNN S 20° E 9 LINKS  
15" ELM N 05° E 20 LINKS

Continued on Back

B. Description of corner evidence and/or method applied in restoring or reestablishing corner:

FOUND 1 1/4" IRON PIPE LEANING VERY BADLY WITH MAG NAIL IN CENTER NEXT TO SANDSTONE MONUMENT DUG DOWN 20" AND FOUND SANDSTONE MONUMENT GOING STRAIGHT DOWN ON SIDES INTO CLAY AND SAND. PLACE WITH EXPOXY AN ALUMINUM REMON. DISC STAMPED '41092' ON TOP CENTER OF SANDSTONE MONUMENT. DISC HAS A PIECE OF REBAR INSERTED IN CENTER AND A HEAVY MAGNET ON NORTH EDGE OF DISC. PULLED 1 1/4" x 12" IRON PIPE. THERE IS RED BRICK SURROUNDING THE SANDSTONE MONUMENT. TOP CENTER OF OLD PIPE WAS 0.20' DUE WEST OF CENTER OF SANDSTONE MONUMENT

C. Description of monument for corner and accessories established to perpetuate locating the position of the corner:

SANDSTONE MONUMENT WITH ALUMINUM REMON. DISC IN CENTER STAMPED '41092'. DISC HAS PIECE OF REBAR INSERTED IN CENTER AND HEAVY MAGNET ON NORTH SIDE.

- |                               |         |        |                        |
|-------------------------------|---------|--------|------------------------|
| 9) 1/2" IRON PIPE             | N 05° E | 32.69' | SET NAIL/TAG EAST SIDE |
| 13) POWER POLE                | N 38° W | 48.13' | SET NAIL/TAG EAST SIDE |
| 8) POWER POLE                 | SOUTH   | 44.59' | TOP NUT                |
| 11) FIRE HYDRANT              | N 10° E | 35.27' |                        |
| 14) CENTERLINE OF GRAVEL ROAD | NORTH   | 6.1'   |                        |
| 15) 4"-6" TW. MAPLE           | N 62° E | 62.19' | SET NAIL/TAG WEST SIDE |

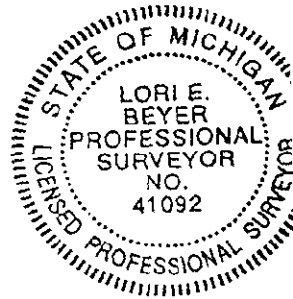

AFTER CAREFUL EXAMINATION OF RECORD DOCUMENTATION AND FIELD OBSERVATIONS, I BELIEVE THIS POINT SHOULD BE ACCEPTED AS THE BEST AVAILABLE EVIDENCE OF THE POSITION OF THE ORIGINAL CORNER.

THIS CORNER WAS RATIFIED BY THE PEER REVIEW COMMITTEE ON NOVEMBER 22, 1999.

Signed by Lori E. Beyer  
Surveyor's Michigan License No. 41092

Date DEC 03, 1999

APPROVED  
DATE 11/22/99  
CO. REP. KA

H-7 CONTINUED FROM PARAGRAPH A

WASHTENAW COUNTY GRID BOOK - W.J. ARMSTRONG - JUNE 1934

FOUND SANDSTONE MONUMENT. DID NOT RESET. ROUNDED THE EDGES

1) 14" COTTONWOOD	N 40° W	42.7'	
2) 12" PIN OAK	N 28° W	82.1'	
3) 4" ELM	N 04° W	50.3'	
4) 5" ELM	N 03° E	29.5'	
5) 15" TWIN ELM	S 01° W	104.4'	
6) TWO R. OF W. PIPES			

L.C.R.C. LIBER 4 PAGE 285 - NORMAN FAHRNER # 17620 - JUNE 1976

P.A. 132 CERTIFICATE OF SURVEY - UNRECORDED - WASHTENAW ENGINEERING - JUNE 1976 - SAME WITNESSES

P.A. 132 CERTIFICATE OF SURVEY - UNRECORDED - WASHTENAW ENGINEERING - JULY 1982 - SAME WITNESSES

FOUND IRON PIPE

3) 18" DEAD ELM	N 04° W	50.3'	
1) 28" COTTONWOOD	N 40° W	43.15'	TO NAIL
7) 10" WALNUT	N 05° W	28.83'	TO NAIL
8) POWER POLE	SOUTH	44.18'	TO NAIL
9) IRON PIPE	NORTH	33.64'	

P.A. 132 CERTIFICATE OF SURVEY - UNRECORDED - WASHTENAW ENGINEERING - DECEMBER 1984

FOUND IRON PIPE

10) 12" TW. OAK	N 70° W	97.17'	TO NAIL
11) HYDRANT	N 05° E	35.33	TOP
12) 10"-15" TW. OAK	N 05° W	72.37'	TO NAIL
8) POWER POLE	SOUTH	44.04'	TO NAIL

P.A. 132 CERTIFICATE OF SURVEY - LIBER 03110 PAGE 238 - JOHN BLANCHARD #27446 - MAY 1995

P.A. 132 CERTIFICATE OF SURVEY - LIBER 03327 PAGE 774 - JOHN BLANCHARD #27446 - SEPTEMBER 1996  
(MONUMENT NOT DESCRIBED - NO WITNESSES POSTED)

P.A. 132 CERTIFICATE OF SURVEY - LIBER 3522 PAGE 285 - ATWELL HICKS - OCTOBER 1997

FOUND 1 1/2" IRON PIPE IN CONCRETE. SET MAG NAIL IN CENTER

9) 1/2" IRON PIPE	NORTH	32.75'	
13) POWER POLE	N 45° W	48.00'	NAIL NE/FACE
8) UTILITY POLE	S 05° E	44.56'	NAIL E/FACE
11) FIRE HYDRANT	S 05° E	35.27'	(BEARING APPEARS TO BE WRONG)
14) CENTERLINE OF GRAVEL ROAD	NORTH	6.1'	



5094713

Page: 2 of 2

02/07/2000 02:55P

Peggy M. Haines - Washtenaw Co. CORREM L-2 P-301

- Copy -

RECORDED  
SECTION

MAY 13 2000

SECTION